

37 Bryn Castell, Abergele, Conwy, LL22 8QA

£379,950

5 3 2



A large detached house situated on an elevated corner plot within the popular Tan Y Gopa estate, with coastal views from the front. This family house offers plenty of space for the growing family with a good size lounge, separate dining room, kitchen plus utility, five bedrooms, ensuite, family bathroom and cloakroom. There is an integral double garage and lawn gardens. Being within one mile of Abergele town centre with its shops and facilities, schooling for all age groups and the A55 Expressway which offers a quick commute along the North Wales coast.

Key Features

- Detached family house
- Sea views from the front
- Five bedrooms
- Gas central heating and double glazing
- Council tax band - F
- Sought after position
- Double garage
- Secluded rear garden
- Freehold
- EPC rating - D



Ground Floor

Floor area 101.3 sq.m. (1,091 sq.ft.) approx

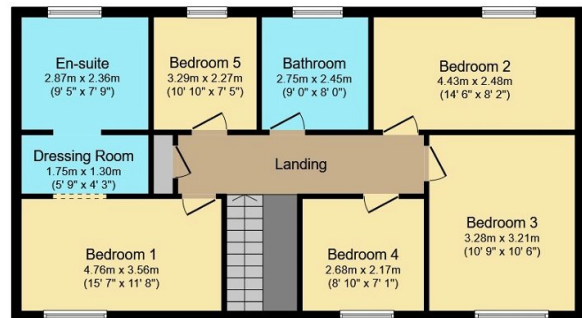

First Floor

Floor area 78.3 sq.m. (843 sq.ft.) approx

Total floor area 179.7 sq.m. (1,934 sq.ft.) approx

This plan is for illustration purposes only and may not be representative of the property. Plan not to scale.

Powered by audioagent.com