

52 Ffordd Y Morfa, Abergele, Conwy, LL22 7NS

£163,000

3 1 2



Welcoming new to the market this mid terraced house perfect for a family home. Benefiting from Three bedrooms, an extension of the kitchen, bright playroom/dining room, utility, spacious lounge and a Three piece bathroom suite. Outside the property offers an ample sized garden providing areas laid to lawn with a patio space perfect for Al-Fresco dining. Situated in the popular town of Abergele with local schools near by, regular public transport links and the A55 is easily accessed.

Key Features

- Terraced House
- Three bedrooms
- Ample size rear garden
- Within walking distance to local schools
- EPC - C
- Family home
- Extension of the kitchen
- A55 expressway easily accessed
- Tenure - Freehold
- Council Tax Band - C

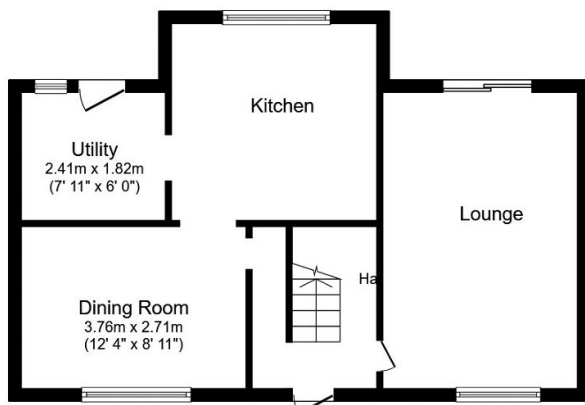

Ground Floor

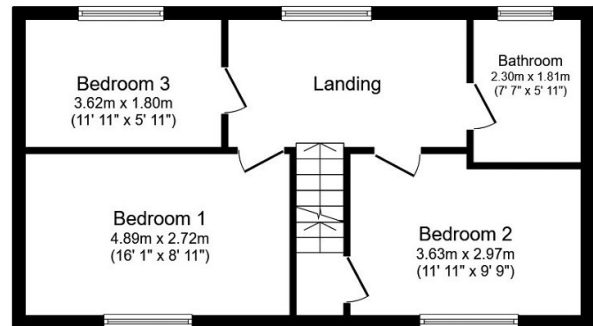

First Floor

Total floor area 96.0 sq.m. (1,033 sq.ft.) approx

This plan is for illustration purposes only and may not be representative of the property. Plan not to scale. Powered by PropertyBox