

PETER LARGE

ESTATE AGENTS

13 Plastirion Court, Russell Road, Rhyl, LL18 3DJ

£87,500

🛏 2 🚿 1 🛋 1



For sale is this lovely first floor secure retirement apartment being situated within walking distance of Rhyl's seafront and promenade, with bus routes nearby and a short drive from Rhyl's main town centre. Internally it is quite spacious and consists of Lounge, kitchen, two bedrooms, bathroom and hallway. While the property is exclusive to the over 60's, (or over 55's subject to other criterias) it offers security with well maintained communal gardens, allocated parking and the benefit of an onsite laundrette.

rhyl@peterlarge.com

| 01745 334411

| www.peterlarge.com

19 CLWYD STREET, RHYL, DENBIGHSHIRE, LL18 3LA

Key Features

- First floor apartment
- Well proportioned rooms
- Leasehold (service charge £112.97 pcm)
- Well kept communal gardens
- EPC - C / Council tax - B
- Two bedrooms
- Allocated parking
- Over 60's only (probate sale)
- Close to amenities and promenade
- Date: 07/02/2025

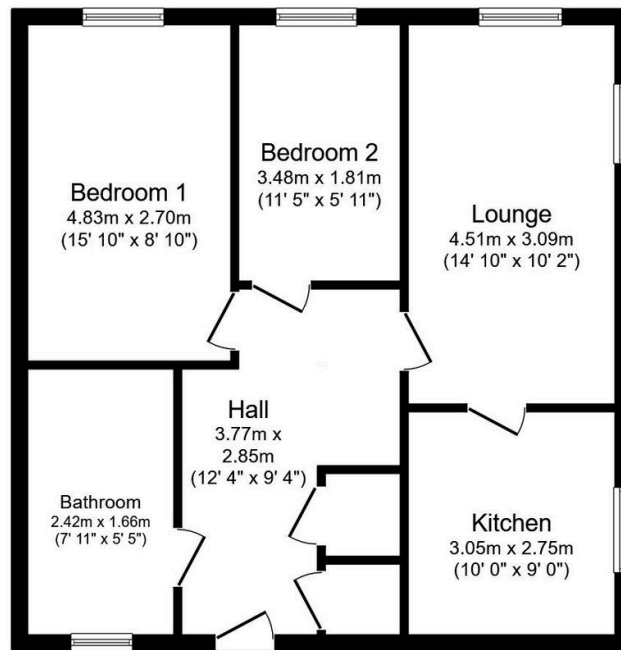

Floor Plan

Floor area 63.2 m² (680 sq.ft.)

TOTAL: 63.2 m² (680 sq.ft.)

This floor plan is for illustrative purposes only. It is not drawn to scale. Any measurements, floor areas (including any total floor area), openings and orientations are approximate. No details are guaranteed, they cannot be relied upon for any purpose and do not form any part of any agreement. No liability is taken for any error, omission or misstatement. A party must rely upon its own inspection(s). Powered by www.Propertybox.io