

Tegfan, Allt Goch, St. Asaph

£299,000

2 2 1



A rare opportunity has arisen to purchase this large two bedroom detached bungalow having being refurbished throughout, set in a semi rural area of St Asaph with breathtaking views over the surrounding countryside and towards the Clwydian Hillside. The property stands in well manicured gardens having ample off street parking, integral garage and conservatory. Benefiting from newly fitted kitchen, bathroom and en-suite. The cathedral city of St Asaph has shops catering for most everyday needs and the Tweedmill outlet store only a short drive away, with good links to the A55 expressway for travel to Chester and beyond. Viewing is highly recommended to avoid disappointment.

Key Features

- Popular location
- Large detached bungalow
- Ample off street parking
- Semi rural
- Council Tax- E
- Recently refurbished
- Two double bedrooms
- Clwydian Hillside views
- EPC- D
- Instructed-23/08/2025 P/R 04/11/2025 / P/R 08/11/2025

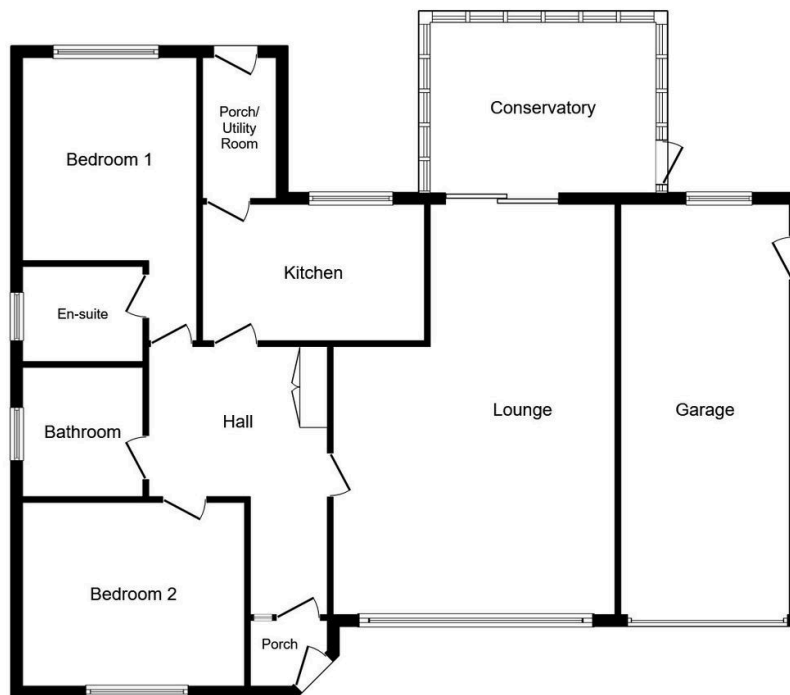

Floor Plan

Total floor area 134.3 sq.m. (1,445 sq.ft.) approx

This floor plan is for illustration purposes only and may not be representative of the property. The position and size of doors, windows and other features are approximate. Unauthorized reproduction prohibited. © PropertyBOX