

20 Knowles Avenue, Rhyl, LL18 3TU

£198,500

3 1 2



Presenting this lovely well presented detached bungalow, which is currently listed for sale. The property is ready for immediate occupation and boasts a generous layout with three bedrooms, comprising two doubles and a single, wet room, spacious kitchen, equipped with a dedicated dining area, conservatory and lounge. Being in a sought after location within walking distance of the seafront and promenade and Rhyl's main town centre is a short drive away with all its shops and public services. Easy to maintain pretty gardens with off street parking and single garage.

Key Features

- Well presented
- Detached bungalow
- Extended
- Garage and driveway
- Freehold / EPC - E / council tax - C
- Three bedrooms
- Kitchen / diner
- Conservatory
- Enclosed gardens
- Date instructed 29/05/2025

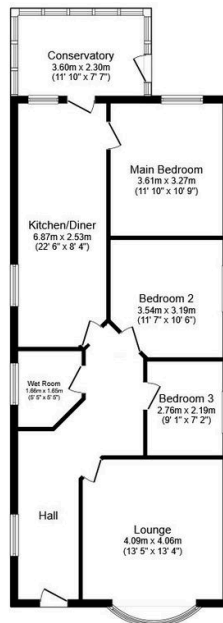

Floor Plan

Floor area 92.7 sq.m. (997 sq.ft.)

Total floor area: 92.7 sq.m. (997 sq.ft.)

This floor plan is for illustrative purposes only. It is not drawn to scale. Any measurements, floor areas (including any total floor area), openings and orientations are approximate. No details are guaranteed, they cannot be relied upon for any purpose and do not form any part of any agreement. No liability is taken for any error, omission or misstatement. A party must rely upon its own inspection(s). Powered by www.Propertybox.io