

13 Rhodfa Tegid, St Asaph, LL17 0EQ

Offers In Region Of £265,000

🛏 3 🚿 2 🚗 1



This beautifully presented stone-built end of terrace house is located in Livingstone Place, formerly known as 'HM Stanley'. The property is in immaculate condition, showcasing modern fixtures and a high level of attention to detail. Upon entering the property, you will find a spacious reception room, ideal for entertaining guests and relaxing with family. The open-plan kitchen/living offers a contemporary design, providing ample space for culinary creations. The house boasts three bedrooms and storage space, additionally, there is a stylish bathroom, featuring modern fittings and finishes. The property benefits from an enclosed rear garden, providing a private sanctuary where you can unwind and enjoy the outdoors, with three allocated parking spaces. Within easy access to the City of St Asaph it offers a convenient lifestyle, with a range of amenities, shops, and restaurants nearby. Book a viewing today to appreciate the exceptional quality and prime location of this property.

- End terrace
- Three allocated parking spaces
- Modern fixtures
- Pure development
- Probate sale
- Stone Built
- Enclosed Rear garden
- Sought after location
- City of St Asaph close to A55
- Freehold

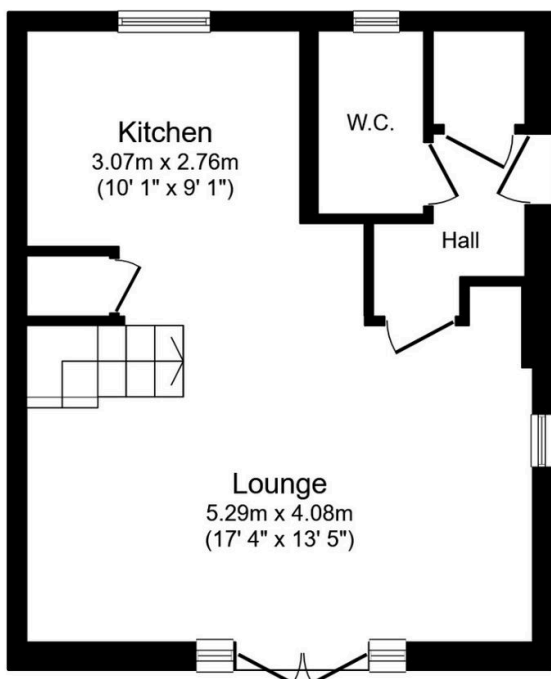

Ground Floor

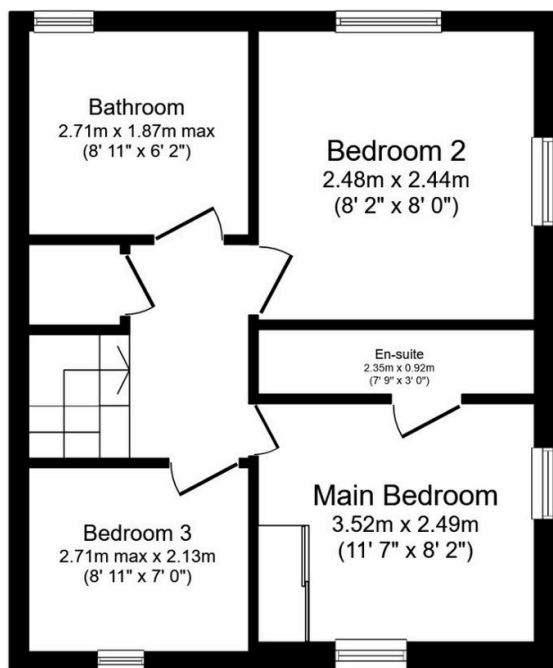

First Floor

Total floor area 77.9 sq.m. (839 sq.ft.) approx

This floor plan is for illustration purposes only and may not be representative of the property. The position and size of doors, windows and other features are approximate. Unauthorized reproduction prohibited. © PropertyBOX