

12 Llys Alwen, Rhyl, LL18 4BQ

£170,000

2 1 2



This two bedroom semi-detached bungalow offers a spacious living space with two reception rooms, rear conservatory, kitchen and shower room. The lovely low maintenance gardens are fully enclosed with a long driveway providing ample off street parking. The property is located on the popular Parc View Development in a quiet cul de sac position within walking distance to the central area which offers a Doctors Surgery, Dental Surgery, Pharmacy and Co-op store that cater for your everyday needs.

Key Features

- Two bedrooms
- Good size kitchen
- Ample off street parking
- Freehold
- Council tax - C / EPC - C
- Two reception rooms
- Rear conservatory
- Enclosed rear garden
- Probate sale (Probate granted 21/05/2025)
- Instruction date 19/04/2025

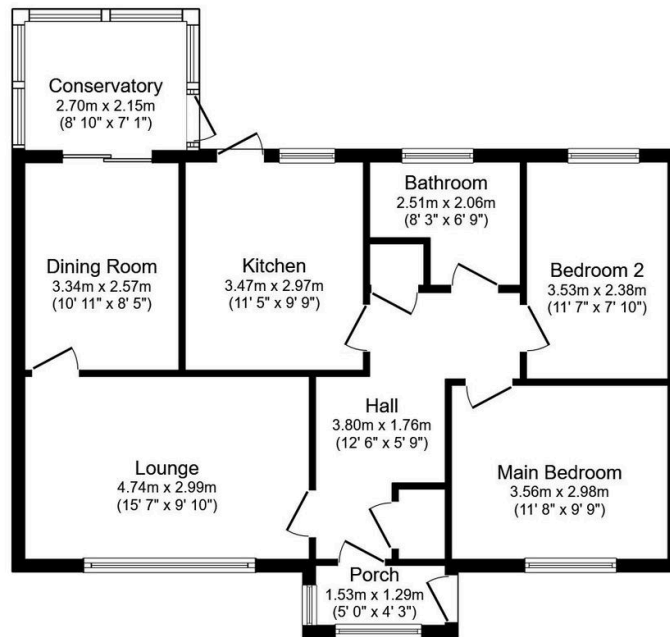

Floor Plan

Floor area 79.5 sq.m. (856 sq.ft.)

Total floor area: 79.5 sq.m. (856 sq.ft.)

This floor plan is for illustrative purposes only. It is not drawn to scale. Any measurements, floor areas (including any total floor area), openings and orientations are approximate. No details are guaranteed, they cannot be relied upon for any purpose and do not form any part of any agreement. No liability is taken for any error, omission or misstatement. A party must rely upon its own inspection(s). Powered by www.Propertybox.io