

2 Cherry Tree Walk, Rhyl, LL18 4JL

£155,000

🛏 2 🚿 1 🛋 1



This charming semi-detached bungalow is brimming with potential and is in need of modernising, making it a perfect canvas for buyers looking to personalise their new home to their own tastes. The property boasts two comfortable bedrooms, one bathroom, a kitchen with dining space and lounge. One of the highlights of this property is its fantastic location. It is situated in close proximity to public transport links, local store provides most everyday needs and is also near walking and cycling routes, providing plenty of opportunities for recreational activities. The property benefits from off street parking leading to a single garage with enclosed easy to maintain garden.

Key Features

- Charming semi-detached bungalow
- Public transport
- Single garage
- Great location
- EPC - D / Council tax - C
- Two comfortable bedrooms
- Garden for relaxation
- Kitchen/diner
- Freehold / probate sale
- Date instructed: 27/03/2025

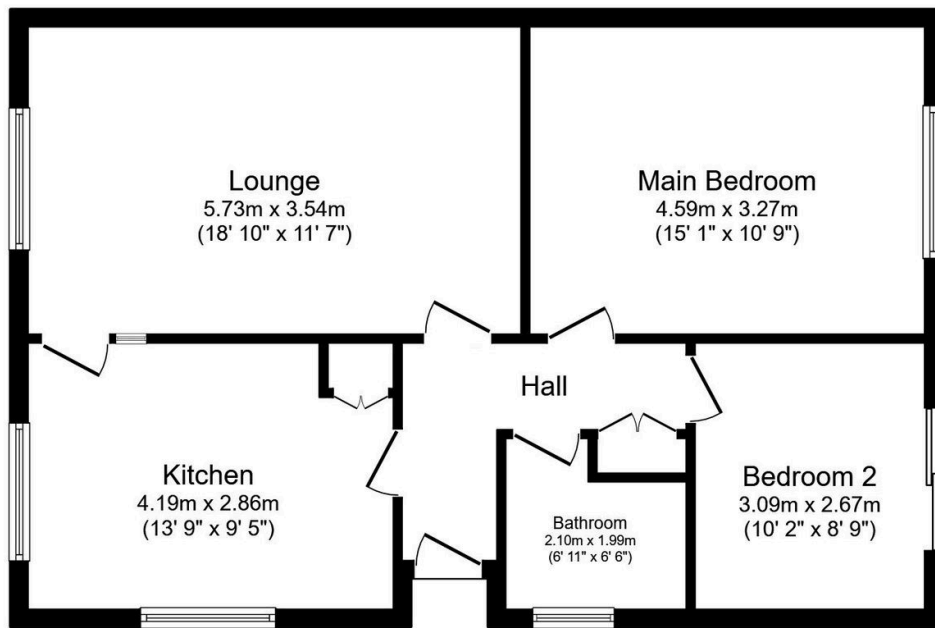

Floor Plan

Floor area 69.8 sq.m. (751 sq.ft.)

Total floor area: 69.8 sq.m. (751 sq.ft.)

This floor plan is for illustrative purposes only. It is not drawn to scale. Any measurements, floor areas (including any total floor area), openings and orientations are approximate. No details are guaranteed, they cannot be relied upon for any purpose and do not form any part of any agreement. No liability is taken for any error, omission or misstatement. A party must rely upon its own inspection(s). Powered by www.Propertybox.io