

5 Eversley Close, Rhyl, Denbighshire LL18 4US

£225,000

3 1 1

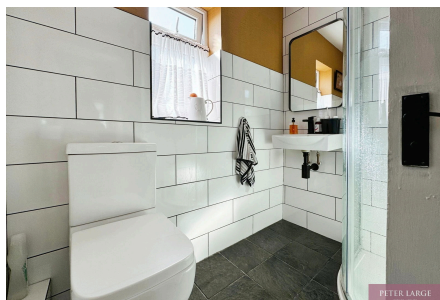

Presenting a charming three-bedroom detached bungalow for sale, located in the serene and well-connected neighbourhood of South Rhyl situated on a corner plot. This property is well presented making it a delightful home for its next owners. With lounge, kitchen with dining room and shower room. The property offers off-street parking with gardens surrounding. The property is also conveniently close to public transport links, making commutes and travels a breeze.

Key Features

- DETACHED BUNGALOW
- LARGE KITCHEN/DINER
- GARAGE AND GARDENS
- FREEHOLD
- COUNCIL TAX BAND -
- THREE BEDROOMS
- SOUGHT AFTER AREA
- AMPLE OFF ROAD PARKING
- EPC - E
- INSTRUCTED - 06/09/24 Price adjusted - 23/09/24

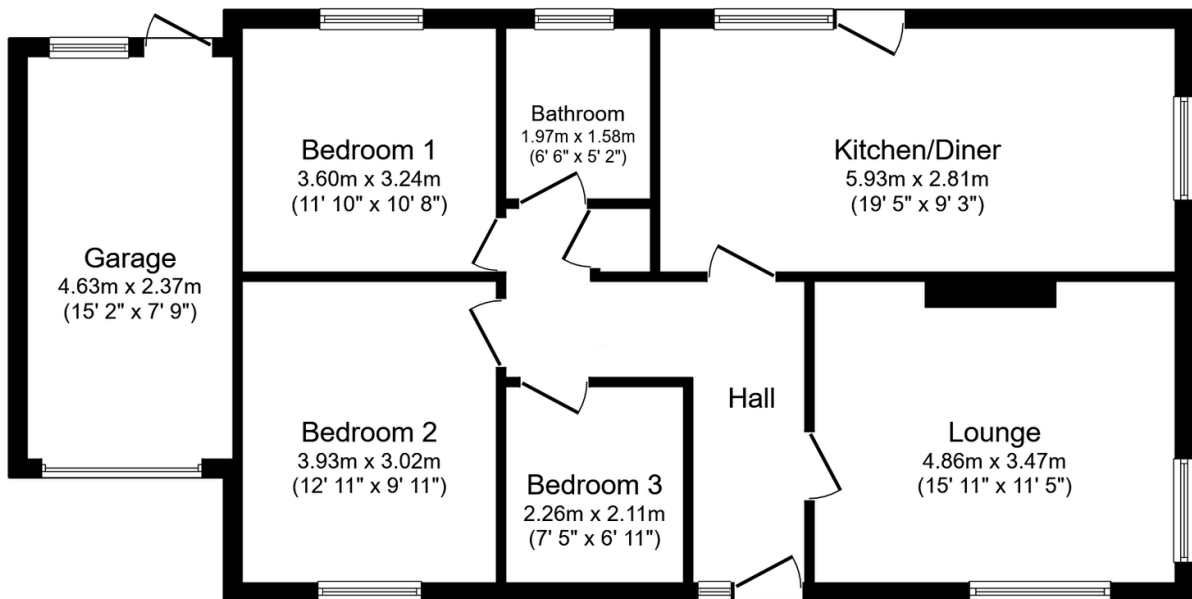

Floor Plan

Floor area 79.9 m² (860 sq.ft.)

TOTAL: 79.9 m² (860 sq.ft.)

This floor plan is for illustrative purposes only. It is not drawn to scale. Any measurements, floor areas (including any total floor area), openings and orientations are approximate. No details are guaranteed, they cannot be relied upon for any purpose and do not form any part of any agreement. No liability is taken for any error, omission or misstatement. A party must rely upon its own inspection(s). Powered by www.Propertybox.io