

23 Victoria Road, Rhyl, LL18 2EG

£123,000

3 1 2



Presenting an exciting opportunity for those looking to put their own stamp on a property, this three bedroom terraced house is listed for sale and is eagerly awaiting its next chapter. The property does require modernisation, providing the perfect canvas to create a home tailored to your individual taste and style. The location is both practical and desirable, with excellent public transport links, the proximity to local schools enhances the appeal for families and is within walking distance of Rhyl's main high street. Having two reception rooms, kitchen, large garden to the rear, gas central heating and upvc double glazing.

Key Features

- Three bedrooms
- Ideal location
- Terraced property
- EPC - C
- Freehold
- In need of modernisation
- Good size rear enclosed garden
- Two reception rooms
- Council tax - B
- Date: 02/07/2024

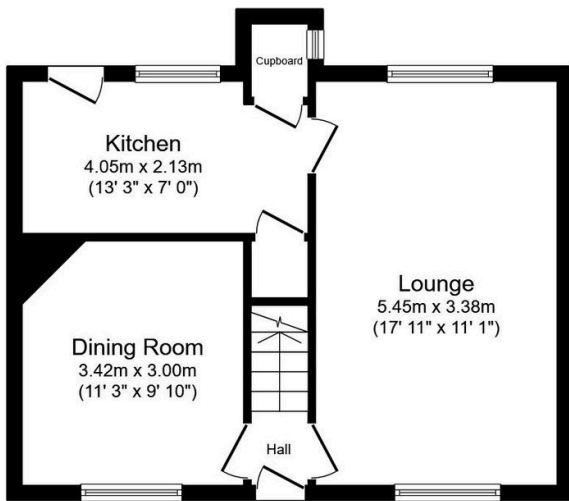

Ground Floor

Floor area 42.9 m² (462 sq.ft.)

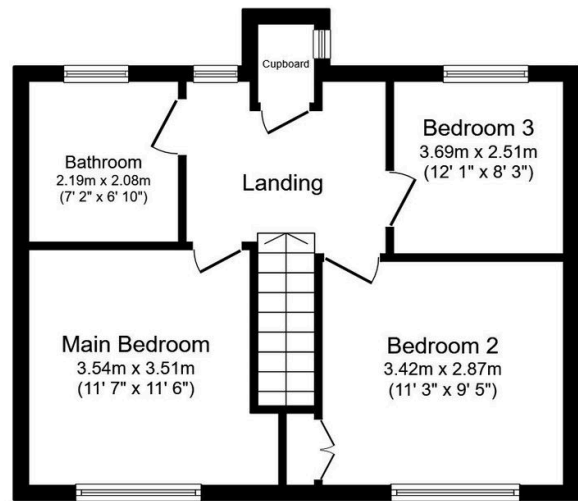

First Floor

Floor area 42.9 m² (462 sq.ft.)

TOTAL: 85.8 m² (924 sq.ft.)

This floor plan is for illustrative purposes only. It is not drawn to scale. Any measurements, floor areas (including any total floor area), openings and orientations are approximate. No details are guaranteed, they cannot be relied upon for any purpose and do not form any part of any agreement. No liability is taken for any error, omission or misstatement. A party must rely upon its own inspection(s). Powered by www.Propertybox.io