

5 Maes Y Bryn, Rhuddlan, LL18 2TE

£280,000

🛏 3 🚿 1 🚽 2



This Well presented detached three bedroom dormer bungalow is located in the well know sought-after village of Rhuddlan. Situated within easy reach of the quaint array of high street shops, restaurants and bars. Convenient access to walking and cycling routes, perfect for those who enjoy an active lifestyle. This well loved family property boasts two reception rooms, three bedrooms, a kitchen, and a shower room. Having off street parking, garage and a lovely garden, providing ample outdoor space for relaxation and entertaining. This property presents a wonderful opportunity for a new owner to create their perfect home in this desirable village setting.

Directions: Proceed from the Rhyl office over the Vale Road bridge onto Rhuddlan Road heading towards Rhuddlan. Onto the A547 turning right into Maes Y Bryn and the property can be seen on the right hand side by way of a For Sale board.

- Detached dormer bungalow in sought-after village location
- Three bedrooms for comfortable accommodation
- Lovely garden for outdoor relaxation
- Walking and cycling routes nearby
- Freehold, EPC - D
- Two reception rooms for versatile living
- Well-equipped kitchen for culinary enthusiasts
- Convenient access to local amenities
- Ideal opportunity to create perfect home
- Date : 12/03/2024

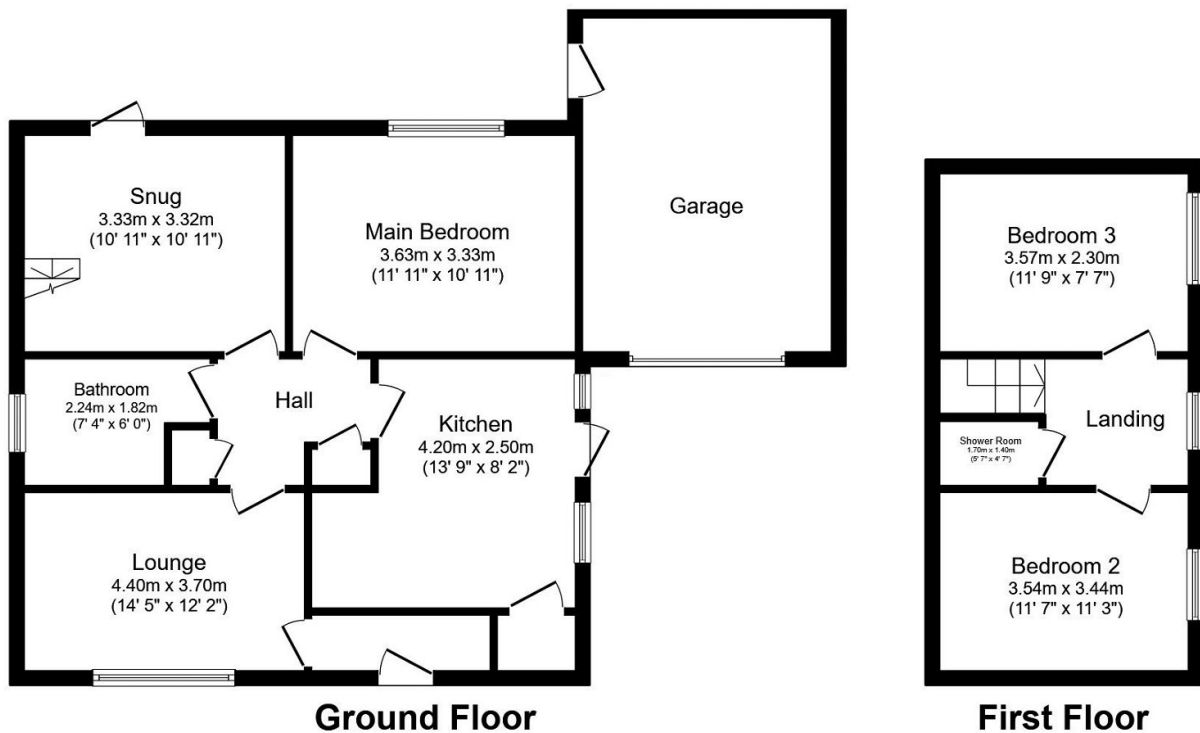

Total floor area 103.8 sq.m. (1,117 sq.ft.) approx

This plan is for illustration purposes only and may not be representative of the property. Plan not to scale. Powered by PropertyBox