

26 South Avenue, Rhyl, LL18 1HU

£150,000

3 1 2



This end of terrace property, located in a popular area, still retaining some of its original features but would benefit from some modern refineries giving this home great potential for a buyer looking to create their dream living space. Having two reception rooms and kitchen to the ground floor with two double bedrooms and one single bedroom, providing ample space for a growing family with bathroom to the first floor. Situated close to public transport links, walking and cycling routes nearby with the seafront and promenade with close proximity. Don't miss the opportunity to view this property and envision the possibilities it holds for you and your family.

Key Features

- End of terrace three bedroom property
- Two reception rooms with fireplaces
- Spacious layout
- Bathroom and kitchen
- Freehold
- Close to seafront and promenade
- Public transport links nearby
- Original features adding charm
- EPC - D
- Date: 01/03/2024

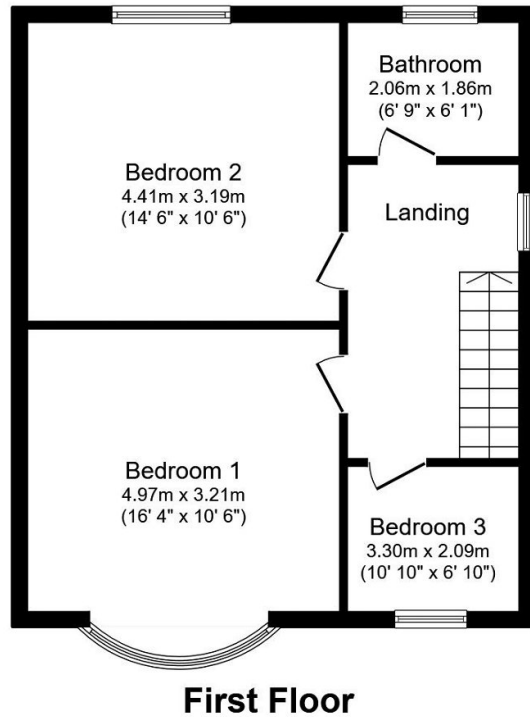
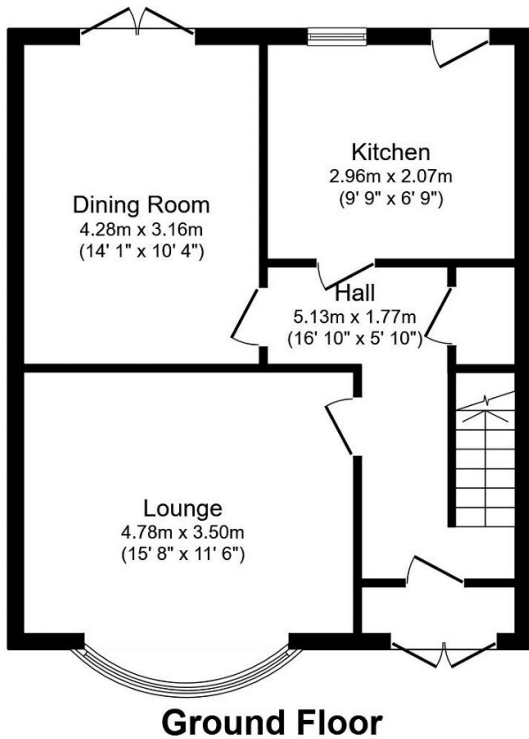

Total floor area 106.2 m² (1,143 sq.ft.) approx

This plan is for illustration purposes only and may not be representative of the property. Plan not to scale. Powered by PropertyBox