

37 Handsworth Crescent Rhyl LL18 4HP

£197,000

4 1 2



This delightful extended semi-detached property nestled in a popular neighbourhood is perfect for families and has been a lovely home for many years. The property, although in need of modernisation now, offers an incredible opportunity for you to create your dream home. With four bedrooms, this spacious dwelling provides ample room for the whole family. It also benefit from Solar panelling to the rear which are owned by the seller. Imagine the possibilities as you transform each room to suit your unique style and needs.

## Key Features

- South Rhyl location
- Extended to the rear
- Ample off road parking
- Would benefit from cosmetic improvements
- Freehold / EPC -D
- A four bedroom semi detached house
- Exceptionally large garden
- Lovely Family Home
- Owned Solar panels to the rear. This is a probate sale
- 22/02/23 price reduced 05/06/2024

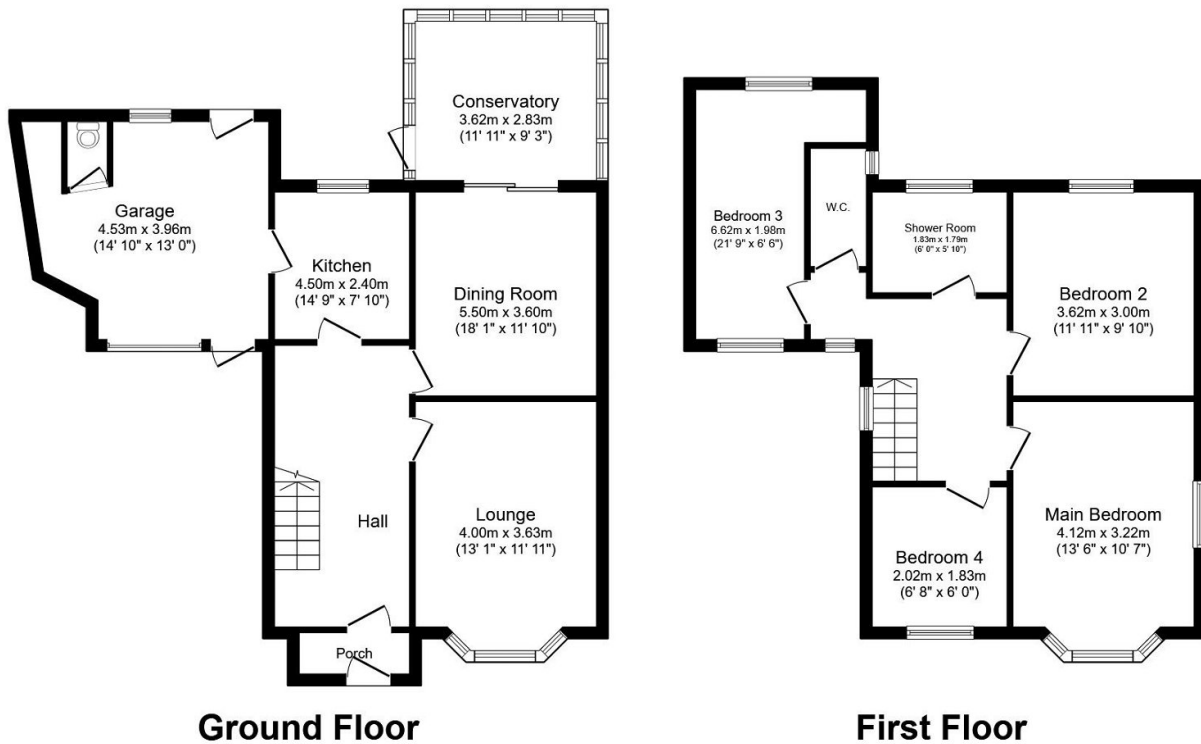

Total floor area 130.2 m<sup>2</sup> (1,401 sq.ft.) approx

This plan is for illustration purposes only and may not be representative of the property. Plan not to scale. Powered by PropertyBox