

## 13 Rhodfa tegid Rhodfa Tegid, St Asaph

Offers In Region Of £275,000

🛏 3 🚗 2 🚗 1

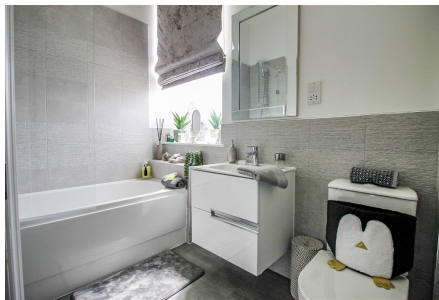

A rare opportunity has arisen to purchase one of the beautifully presented stone built end terrace house, situated on the new development Livingstone place "Former known as HM Stanley" This stylish home with modern fixtures benefits by having three allocated parking spaces and a enclosed rear garden, positioned in a sought after location within easy access to the City of St Asaph and the A55 expressway.

## Key Features

- End terrace
- Three allocated parking spaces
- Modern fixtures
- Pure development
- Close to the A55 expressway
- Stone Built
- Enclosed Rear garden
- Sought after location
- City of St Asaph
- Freehold

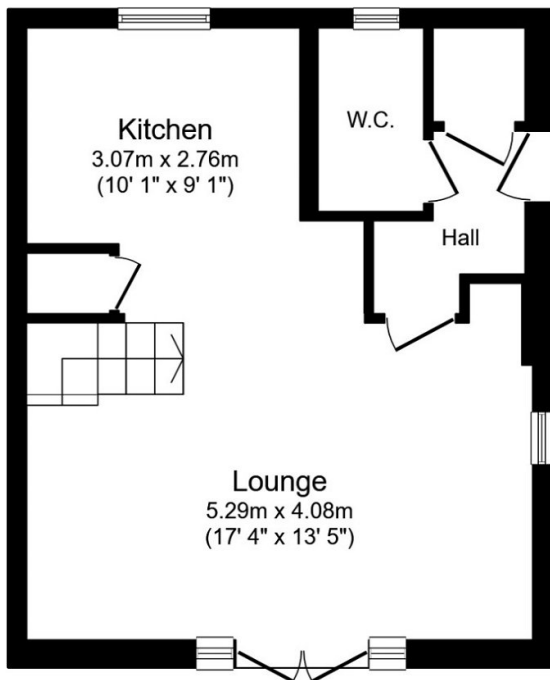

**Ground Floor**

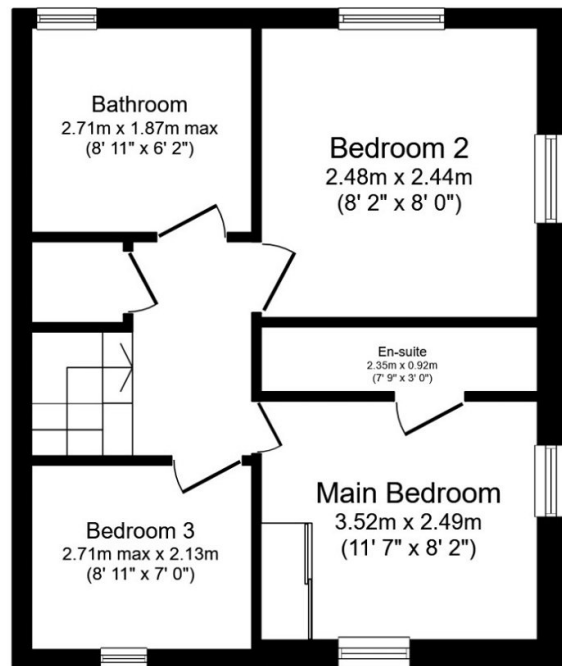

**First Floor**

Total floor area 77.9 sq.m. (839 sq.ft.) approx

This floor plan is for illustration purposes only and may not be representative of the property. The position and size of doors, windows and other features are approximate. Unauthorized reproduction prohibited. © PropertyBOX