



£380,000

 4  2  1  G



Plot 47 Oakwell Place, Thorn Road, Houghton Regis, Dunstable,

ch@ndlers

independent property specialists

Signature

# Plot 47 Oakwell Place, Thorn Road

Houghton Regis, Dunstable, LU5 6JW

£380,000



## Entrance Hall

## Cloakroom

## Kitchen

9'6" x 7'6" (2.90 x 2.30)

A choice of stylish kitchen subject to the stage of build with integrated Fridge/Freezer, washing machine & dish washer, double oven, gas hob and extractor. Recessed downlighters as standard

## Lounge/Dining

17'4" x 14'11" (5.29 x 4.549)

## First Floor

## Bedroom 1

14'9" x 9'9" (4.50 x 2.97)

## En-suite

Roca bathroom suite with choice of stylish tiling from Porcelanosa, recessed downlighters, heated towel rail and shaving point as standard.

## Bedroom 2

14'11" x 8'10" (4.55 x 2.70)

## Bedroom 3

11'5" x 8'1" (3.47 x 2.47)

## Bedroom 4

8'5" x 6'7" (2.57 x 2.00)

## Family Bathroom

Roca bathroom suite with choice of stylish tiling from Porcelanosa, recessed downlighters, heated towel rail and shaving point as standard.

## Parking

Car Port adjacent to the house with two parking spaces

## Garden





## Floor Plan

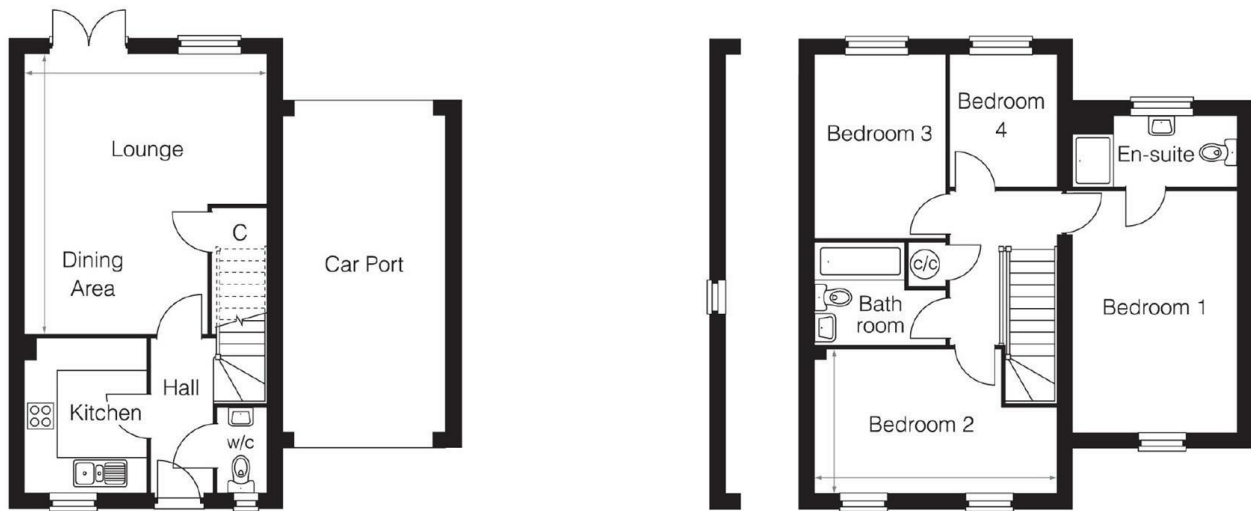

## Viewing

Please contact our Stevenage Sales Office on 01438 356635 if you wish to arrange a viewing appointment for this property or require further information.

These particulars, whilst believed to be accurate are set out as a general outline only for guidance and do not constitute any part of an offer or contract. Intending purchasers should not rely on them as statements of representation of fact, but must satisfy themselves by inspection or otherwise as to their accuracy. No person in this firm's employment has the authority to make or give any representation or warranty in respect of the property.

## Energy Efficiency Graph

01438 356635 [www.chandlers-estates.co.uk](http://www.chandlers-estates.co.uk) 18 Market Place, Stevenage, Hertfordshire, SG1 1DB Email: [sales@chandlers-estates.co.uk](mailto:sales@chandlers-estates.co.uk)

*Looking for that extra-special home?*