

HUNT FRAME

ESTATE AGENTS



Beauchamp Court Wilmington Gardens

, Eastbourne, BN21 4FB

£1,200 Per Month

 2  1  1  D

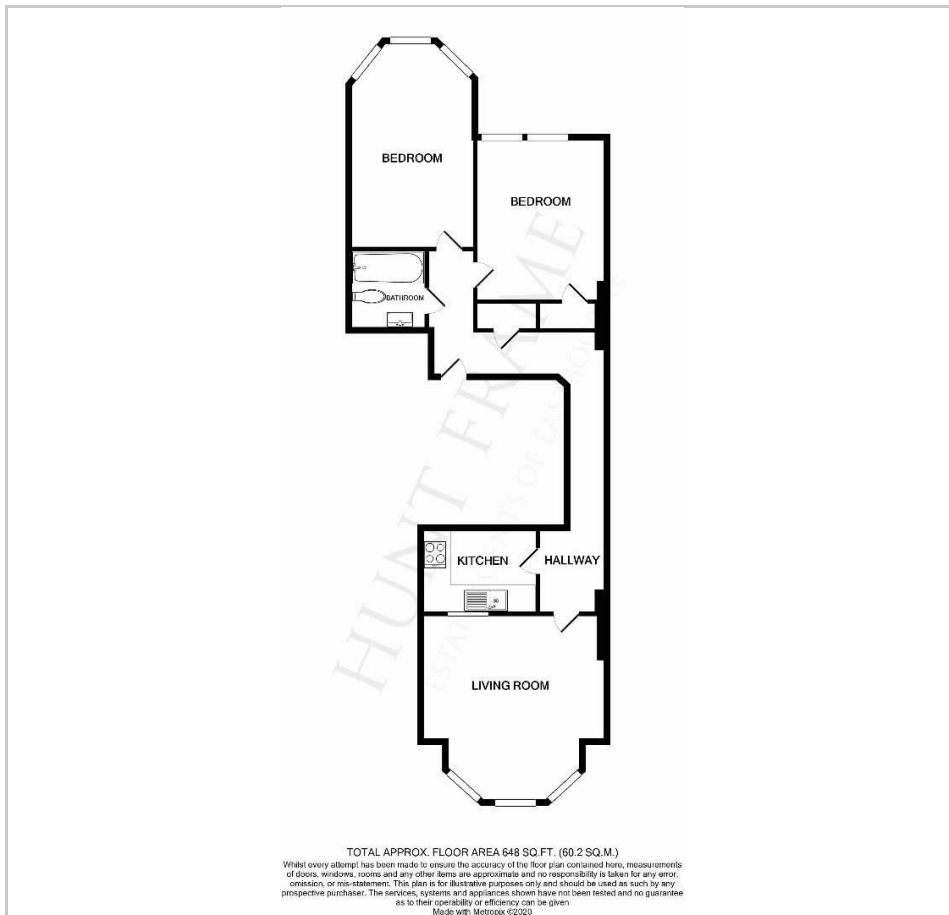

Energy Efficiency Rating			Environmental Impact (CO ₂) Rating		
	Current	Potential		Current	Potential
Very energy efficient - lower running costs			Very environmentally friendly - lower CO ₂ emissions		
(92 plus) A			(92 plus) A		
(81-91) B			(81-91) B		
(69-80) C			(69-80) C		
(55-68) D			(55-68) D		
(39-54) E			(39-54) E		
(21-38) F			(21-38) F		
(1-20) G			(1-20) G		
Not energy efficient - higher running costs			Not environmentally friendly - higher CO ₂ emissions		
England & Wales	EU Directive 2002/91/EC		England & Wales	EU Directive 2002/91/EC	

Viewing

Please contact us on 01323 737373 if you wish to arrange a viewing appointment for this property or require further information.

- SECOND FLOOR CONVERTED APARTMENT
- PASSENGER LIFT
- KITCHEN WITH INTEGRATED APPLIANCES
- TWO DOUBLE BEDROOMS
- ELECTRIC CENTRAL HEATING
- ALLOCATED PARKING
- ADJACENT TO SEAFRONT
- AVAILABLE NOW
- PLEASE APPLY BY EMAIL
- **ZERO DEPOSIT OPTION AVAILABLE**

A RECENTLY CONVERTED SECOND FLOOR LUXURY APARTMENT enjoying a superb location adjacent to the local theatres and seafront. BEAUCHAMP COURT is an exclusive development of just 6 apartments ready for immediate occupation. Parking space. Available now.

IF INTERESTED IN THIS PROPERTY, PLEASE CLICK ON 'EMAIL AGENT' OR FILL OUT AN EMAIL CONTACT FORM TO BE GIVEN AN APPLICATION FORM TO COMPLETE. WE ARE UNABLE TO COMPLETE THESE OVER THE PHONE.

Holding Deposit: £276
Security Deposit: £1384

Council tax band: B



These particulars, whilst believed to be accurate are set out as a general outline only for guidance and do not constitute any part of an offer or contract. Intending purchasers should not rely on them as statements of representation of fact, but must satisfy themselves by inspection or otherwise as to their accuracy. No person in this firm's employment has the authority to make or give any representation or warranty in respect of the property.

16 Cornfield Road, Eastbourne, East Sussex, BN21 4QE
Tel: 01323 737373 | lettings@huntframe.co.uk

www.huntframe.co.uk