

HUNT FRAME

ESTATE AGENTS



13 Cheriton Court Green Street

Old Town, Eastbourne, BN21 1SB

£109,950



13 Cheriton Court

Approximate Gross Internal Area
449 sq ft - 42 sq m

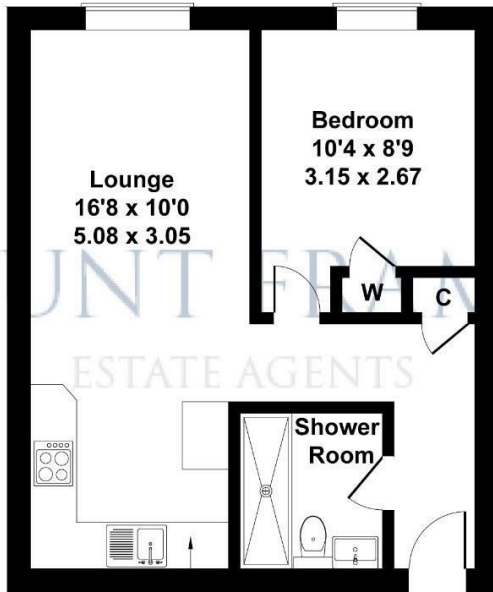

Lounge
16'8 x 10'0
5.08 x 3.05

Bedroom
10'4 x 8'9
3.15 x 2.67

Kitchen
8'7 x 6'2
2.62 x 1.88

Not to Scale. Produced by The Plan Portal on behalf of Hunt Frame.
For Illustrative.

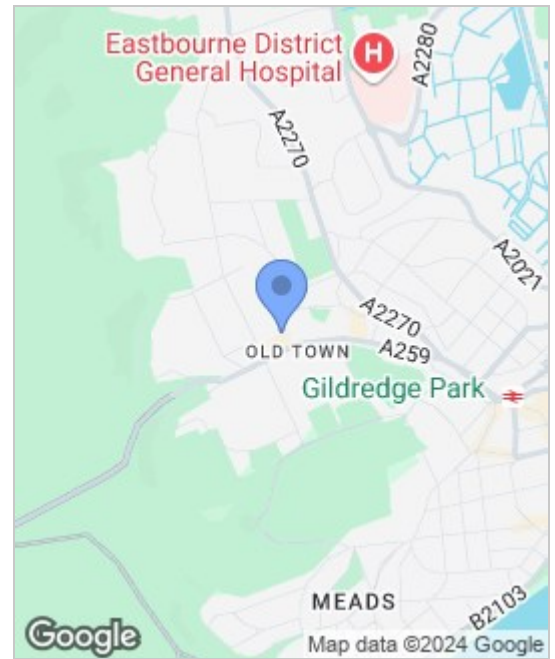

Energy Efficiency Rating		Environmental Impact (CO ₂) Rating			
Very energy efficient - lower running costs	Current	Potential	Very environmentally friendly - lower CO ₂ emissions	Current	Potential
(92 plus) A			(92 plus) A		
(81-91) B			(81-91) B		
(69-80) C			(69-80) C		
(55-68) D			(55-68) D		
(39-54) E			(39-54) E		
(21-38) F			(21-38) F		
(1-20) G			(1-20) G		
Not energy efficient - higher running costs			Not environmentally friendly - higher CO ₂ emissions		
England & Wales		EU Directive 2002/91/EC	England & Wales		EU Directive 2002/91/EC

Viewing

Please contact us on 01323 737373 if you wish to arrange a viewing appointment for this property or require further information.

- RETIREMENT APARTMENT
- ADJACENT TO SHOPS, BUSES AND DOCTORS SURGERY
- COMMUNAL RESIDENT'S LOUNGE
- COMMUNAL GARDENS AND PARKING
- MODERN ELECTRIC HEATERS
- SOUGHT AFTER DEVELOPMENT
- FIRST FLOOR
- COMMUNAL LAUNDRY
- RECENTLY MODERNISED THROUGHOUT
- VACANT POSSESSION

An exceptionally well presented, first floor RETIREMENT APARTMENT, located within this sought after development in Old Town. Enjoying a most convenient location adjacent to local shops, buses and doctor's surgery. Available with no chain.



These particulars, whilst believed to be accurate are set out as a general outline only for guidance and do not constitute any part of an offer or contract. Intending purchasers should not rely on them as statements of representation of fact, but must satisfy themselves by inspection or otherwise as to their accuracy. No person in this firm's employment has the authority to make or give any representation or warranty in respect of the property.