

HUNT FRAME

ESTATE AGENTS

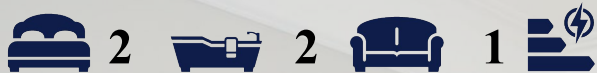

15 Southdown House 1 Howard Square, Eastbourne, BN21 4FG Price Guide £440,000



A STUNNING THIRD (TOP) FLOOR APARTMENT within this NEWLY CONVERTED GRADE II LISTED BUILDING, situated adjacent to Eastbourne's seafront. Consisting of spacious accommodation which extends to approximately 1167 sq ft in size with SUPERB SEA VIEWS OVER THE FRONT ELEVATION. LARGE RECEPTION, TWO DOUBLE BEDROOMS both with EN-SUITES and a SEPARATE WC along with a BEAUTIFUL KITCHEN/BREAKFAST ROOM.

An exclusive development of 15 LUXURIOUSLY APPOINTED apartments, finished to an exacting standard within this Grade II listed building. Located just off The Promenade, to the west of the town centre, within easy reach of the theatres, Towner Art Gallery, seafront and Pier.

The apartments and maisonettes have a minimum of two double bedrooms with en-suites, and a separate cloakroom, fully fitted kitchen/dining rooms with integrated appliances, quartz work surfaces and travertine flooring. All maisonettes have allocated parking. With generous room sizes and reception rooms overlooking Howard Square and the seafront to the side, and ready for occupation during Winter 2023/4, reservations are now being taken. SHARE OF FREEHOLD, 999 year lease. Call HUNT FRAME, sole agents, to arrange your appointment to view.

- TOP FLOOR APARTMENT
- SEA VIEWS
- SPACIOUS RECEPTION
- TWO DOUBLE BEDROOMS
- TWO EN-SUITES
- LUXURY KITCHEN/BREAKFAST ROOM
- SEPARATE WC
- GRADE II LISTED BUILDING
- LIFT
- SHARE OF FREEHOLD

Viewing

Please contact our Hunt Frame Sales Office on 01323 737373 if you wish to arrange a viewing appointment for this property or require further information.

15 Southdown House

Approximate Gross Internal Area
1167 sq ft - 108 sq m

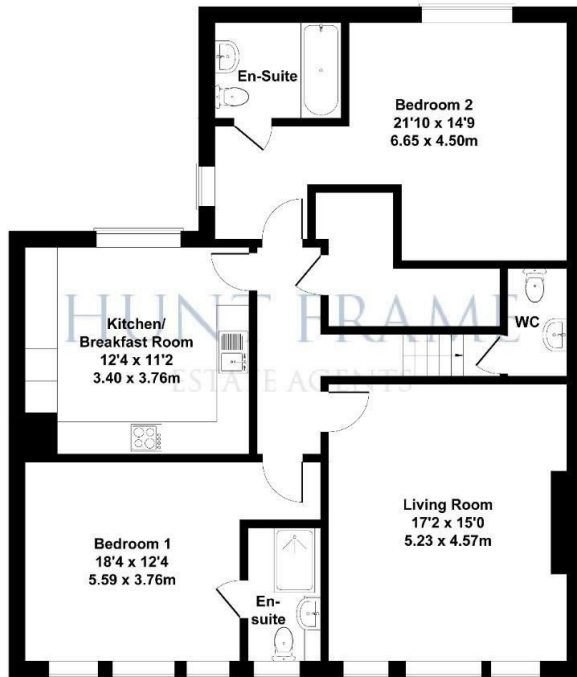

Not to Scale. Produced by The Plan Portal on behalf of Hunt Frame.
For Illustrative.



These particulars, whilst believed to be accurate are set out as a general outline only for guidance and do not constitute any part of an offer or contract. Intending purchasers should not rely on them as statements of representation of fact, but must satisfy themselves by inspection or otherwise as to their accuracy. No person in this firm's employment has the authority to make or give any representation or warranty in respect of the property.