



- Spacious 3 Bedroom House
- Available to Rent Early/Mid August
- G/F Cloakroom
- Large Kitchen/Diner
- Gas Central Heating
- Courtyard Rear Garden
- Pets Considered
- Council Tax Band 'B'
- EPC Rating 'C'

43 West Way, Wick BN17 7NA

£1,250 pcm

**HAWKE &
METCALFE**
INDEPENDENT ESTATE AGENTS

Ground Floor

Approx. 43.5 sq. metres (468.0 sq. feet)

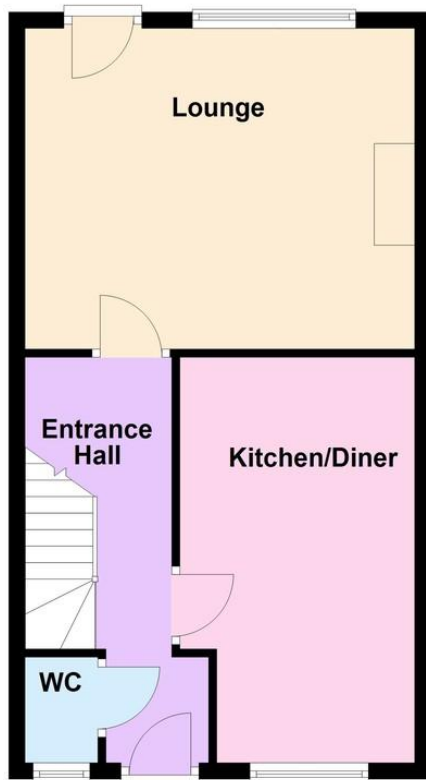

First Floor

Approx. 43.5 sq. metres (468.0 sq. feet)

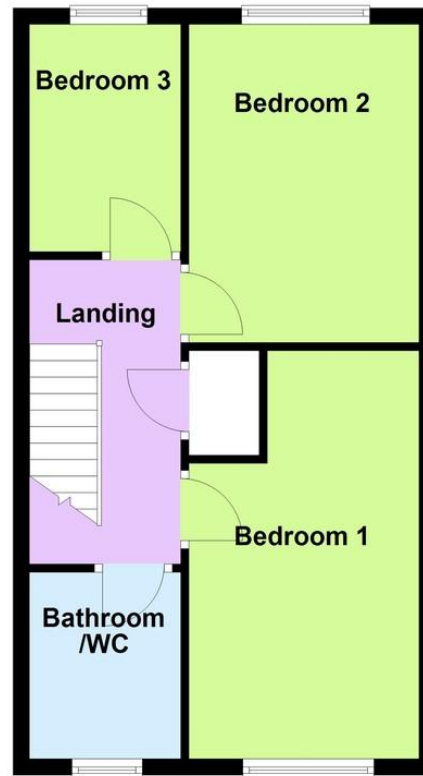

Total area: approx. 87.0 sq. metres (935.9 sq. feet)

Spacious three bedroom house in Littlehampton -
Available to rent early to mid August.

Three good size bedrooms, large kitchen/diner, ground floor cloakroom, lounge with door to courtyard garden, gas central heating and double glazing. **Pets considered with a £20 per calendar month pet premium.**

Situated to the north of Littlehampton, West Way runs between Arundel Road and Manning Road.

ENTRANCE HALL

GROUND FLOOR CLOAKROOM

KITCHEN/DINER

16' 4" x 9' 6" (4.98m x 2.9m)
max

LOUNGE

15' 9" x 12' 11" (4.8m x 3.94m)

BEDROOM 1

16' 4" x 8' 6" (4.98m x 2.59m)
max

BEDROOM 2

12' 10" x 9' 2" (3.91m x 2.79m)

BEDROOM 3

9' 4" x 6' 1" (2.84m x 1.85m)

BATHROOM/WC

COURTYARD STYLE REAR GARDEN

The information and measurements contained within these details are for guidance only and do not form part of any contract.

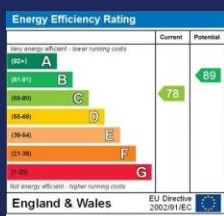

**90 THE STREET, RUSTINGTON, WEST
SUSSEX, BN16 3NJ**

lettings@hawkemetcalf.co.uk

www.hawkemetcalf.co.uk

01903 850450