



- End of Terrace House
- Ground Floor
- Kitchen/Diner
- 3 Bedrooms
- En Suite Shower/WC
- Family Bathroom
- Garage & Drive
- No Pets
- EPC Rating: - 'C'

24 Nursery Road, Angmering BN16 4FH

£1,450 pcm

Ground Floor

Approx. 47.3 sq. metres (508.6 sq. feet)

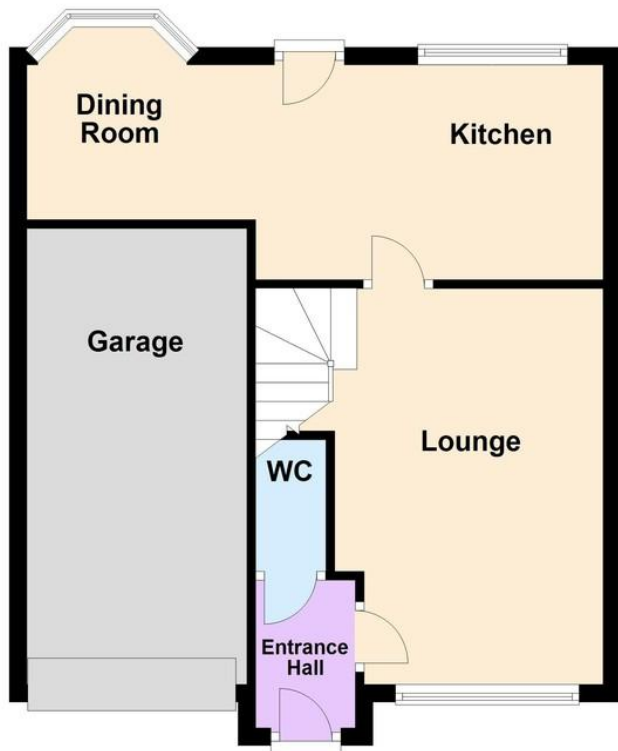

First Floor

Approx. 46.5 sq. metres (500.3 sq. feet)

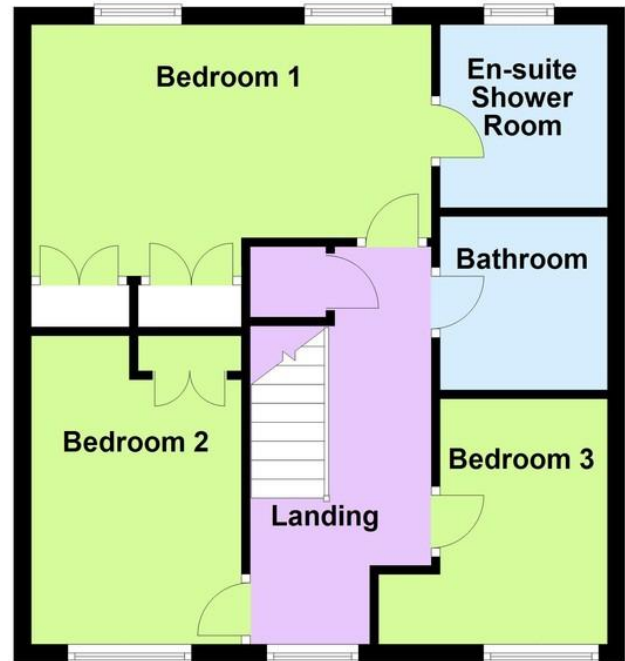

Total area: approx. 93.7 sq. metres (1008.9 sq. feet)

STORM PORCH

ENTRANCE HALL

GROUND FLOOR CLOAKROOM

LOUNGE

14' 10" x 9' 9" (4.52m x 2.97m)

KITCHEN/DINING ROOM

21' 8" x 8' 2" (6.6m x 2.49m)

narrowing to 5'10 (1.78m) plus bay window.

FIRST FLOOR

LANDING

BEDROOM 1

15' x 9' 6" (4.57m x 2.9m)

EN SUITE SHOWER ROOM

BEDROOM 2

11' 9" x 8' 5" (3.58m x 2.57m)

BEDROOM 3

9' 5" x 6' 7" (2.87m x 2.01m)

FAMILY BATHROOM

INTEGRAL SINGLE GARAGE

GARDENS

The information and measurements contained within these details are for guidance only and do not form part of any contract.

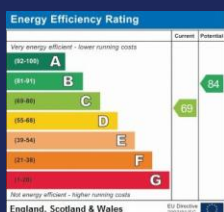

90 THE STREET, RUSTINGTON,
LITTLEHAMPTON, WEST SUSSEX, BN16 3NJ

lettings@hawkemetcalf.co.uk

www.hawkemetcalf.co.uk

01903 850450