



48 Leeward Road, Littlehampton BN17 6PQ
£1,550 pcm

HAWKE &
METCALFE 
INDEPENDENT ESTATE AGENTS

INDEPENDENT ESTATE & LETTING AGENTS

- 3 Bedrooms
- Gas CH & Double Glazing
- Viewing Recommended
- Modernised Throughout
- Private Drive
- Council Tax Band 'C'
- Cloakroom
- Available Immediately
- EPC Rating: - 'C'

Available Immediately

A 3 bedroom semi detached house which has been modernised and redecorated throughout. Modern fitted kitchen with built in oven and hob, modern refitted white bathroom/WC with shower above bath and a landscaped rear garden with patio and lawn.

Pets considered although a £20 pcm pet premium will apply.

We would strongly recommend internal viewing to appreciate this lovely house.

**** Library Photos ****



Ground Floor

Approx. 44.1 sq. metres (474.2 sq. feet)

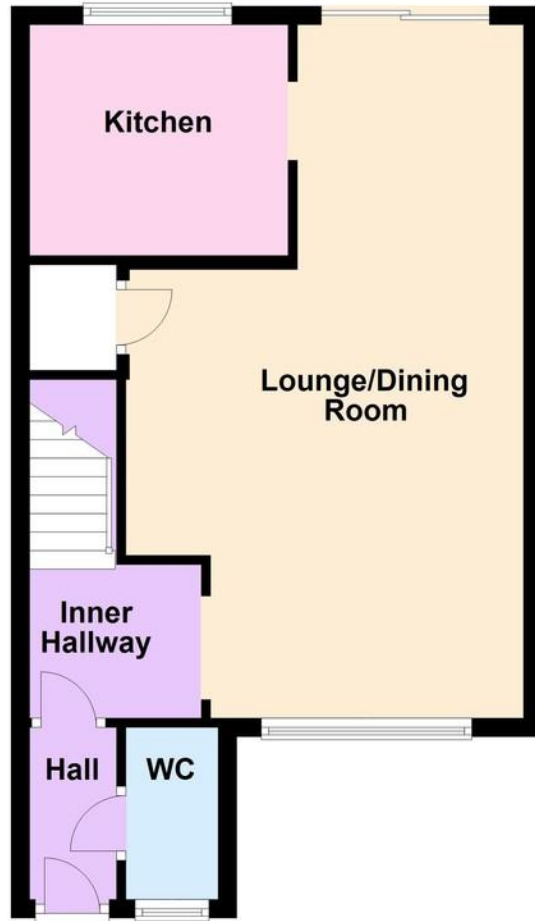

First Floor

Approx. 40.3 sq. metres (433.6 sq. feet)

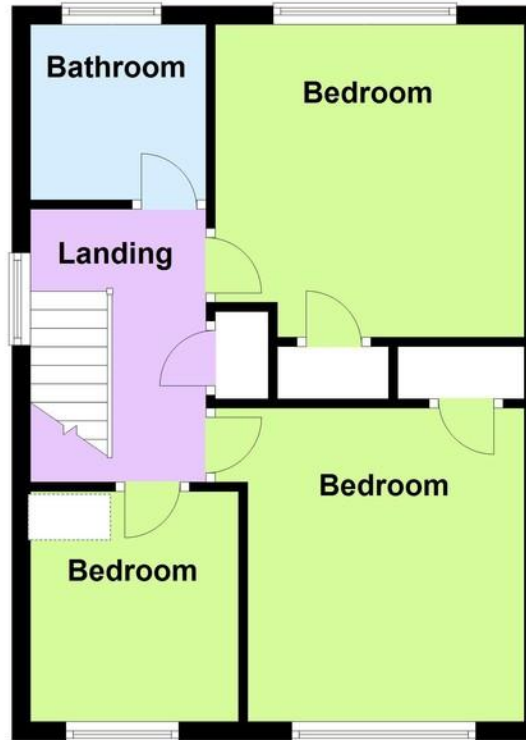

ENTRANCE HALL

GROUND FLOOR CLOAKROOM

SPACIOUS LOUNGE/DINING ROOM

24' 9" x 13' 4" (7.54m x 4.06m)
max

KITCHEN

9' 2" x 8' 3" (2.79m x 2.51m)

BEDROOM 1

11' 3" x 9' 10" (3.43m x 3m)

BEDROOM 2

11' 3" x 9' 10" (3.43m x 3m)

BEDROOM 3

8' 1" x 7' 10" (2.46m x 2.39m)

BATHROOM/WC

OFF ROAD PARKING ON DRIVE

Total area: approx. 84.3 sq. metres (907.8 sq. feet)

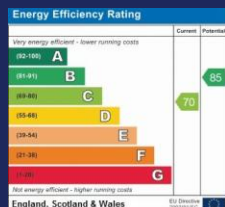

01903 850450

90 THE STREET, RUSTINGTON, WEST SUSSEX,
BN16 3NJ

lettings@hawkemetcalf.co.uk

www.hawkemetcalf.co.uk

