



Ian Anthony

The Estate Agents

Hayfield, School Lane, Burscough, L40 4AE

Offers Over £475,000

🛏 4 🚗 2 🛋 1



- POPULAR RESIDENTIAL LOCATION
- GARDEN FRONT & REAR
- FAMILY BATHROOM
- KITCHEN
- DETACHED BUNGALOW
- SEMI-RURAL LOCATION WITH STUNNING VIEWS
- DOUBLE GARAGE & LARGE DRIVEWAY
- FOUR BEDROOMS
- LIVING ROOM / DINING ROOM



Nestled on the outskirts of the charming Lancashire village of Burscough, Hayfield stands proudly on a generously sized plot, offering a serene and picturesque lifestyle. Just a leisurely stroll away from the delightful village centre, this property presents a perfect opportunity for those seeking a tranquil retreat while remaining close to local amenities.

Hayfield is a remarkable four-bedroom detached bungalow that harmonizes beautifully with its semi-rural surroundings. This home is an idyllic haven for nature lovers and outdoor enthusiasts, where extensive gardens envelop the property on all four sides, providing an unparalleled sense of peace and privacy. The outdoor space is designed for relaxation or entertainment, featuring a combination of lush lawns, a lovely patio area, and scenic views over the countryside.

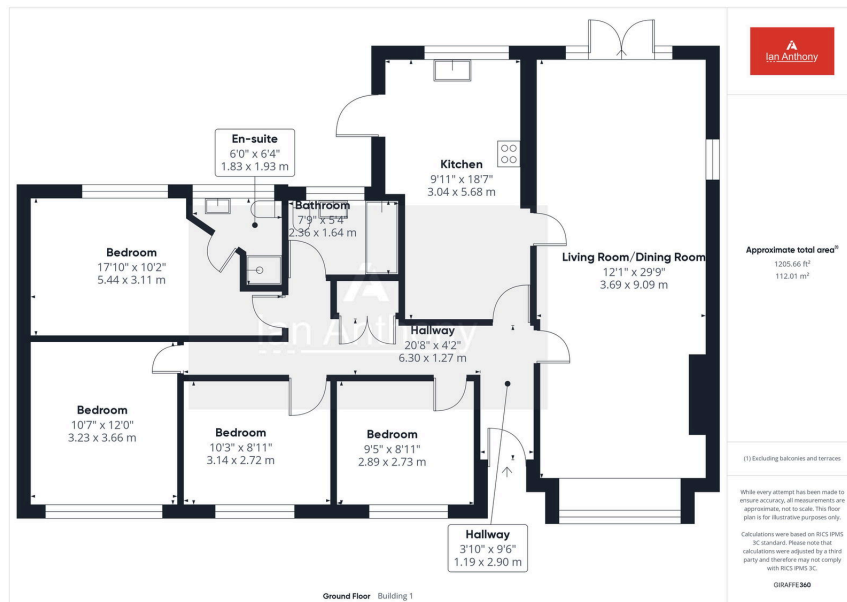

These particulars, whilst believed to be accurate are set out as a general outline only for guidance and do not constitute any part of an offer or contract. Intending purchasers should not rely on them as statements of representation of fact, but must satisfy themselves by inspection or otherwise as to their accuracy. No person in this firm's employment has the authority to make or give any representation or warranty in respect of the property.

5 Burscough Street, Ormskirk, Lancashire, L39 2EG

Tel: 01695 580888 Email: enquiries@iananthonystates.co.uk <https://www.iananthonystates.co.uk>