



Ian Anthony
The Estate Agents

Delph Park Avenue, Aughton, L39 5DE

Guide Price £395,000

🛏 3 🍳 2 🛋 2



- EXTENDED SEMI DETACHED HOUSE
- LIVING ROOM/DINING ROOM
- SITTING ROOM
- KITCHEN, CLOAKROOM
- THREE BEDROOMS
- TWO SHOWER ROOMS
- GARAGE & FRONT GARDEN
- BEAUTIFUL REAR GARDEN



SUMMARY

Situated in a highly desirable and family-friendly location, this beautifully presented and extended three-bedroom semi-detached property on Delph Park Avenue is the perfect choice for those seeking both comfort and convenience. Ideally positioned within walking distance of St Michael's Primary School, close to a local park for outdoor activities, and benefiting from excellent transport links—including a nearby train station offering direct services to Liverpool city centre and Ormskirk—this home offers an enviable lifestyle in a well-connected community.

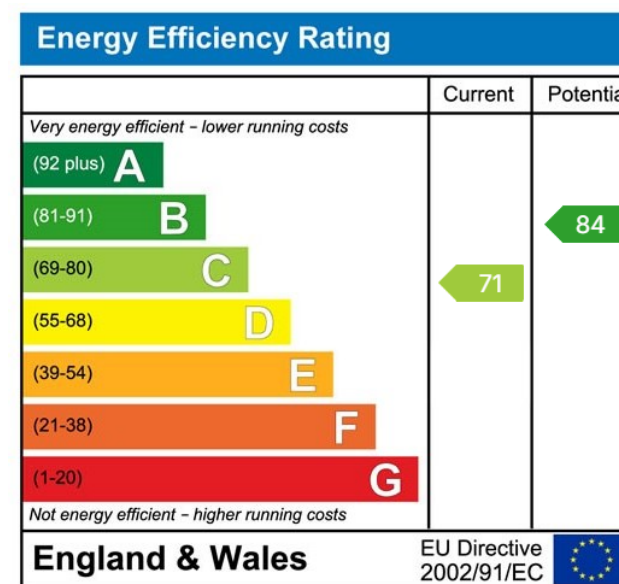
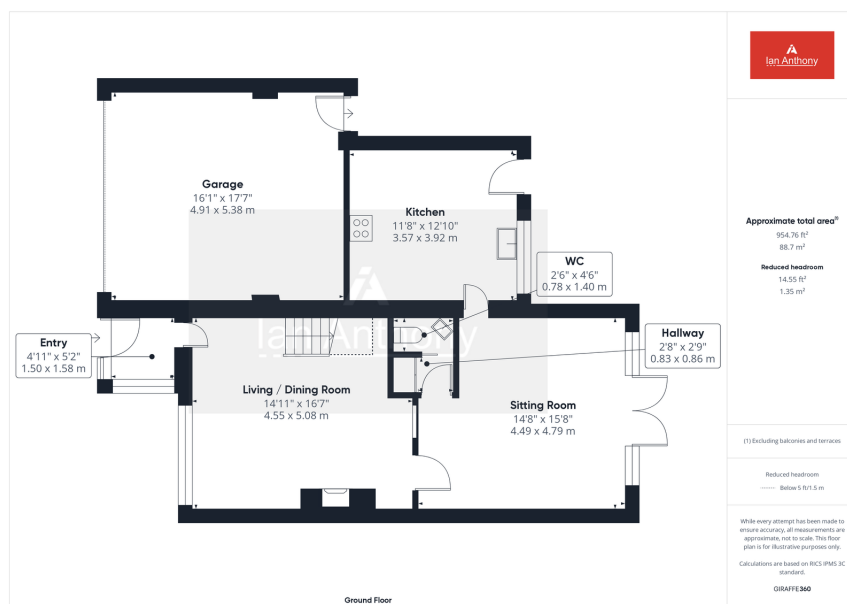

These particulars, whilst believed to be accurate are set out as a general outline only for guidance and do not constitute any part of an offer or contract. Intending purchasers should not rely on them as statements of representation of fact, but must satisfy themselves by inspection or otherwise as to their accuracy. No person in this firm's employment has the authority to make or give any representation or warranty in respect of the property.

5 Burscough Street, Ormskirk, Lancashire, L39 2EG

Tel: 01695 580888 Email: enquiries@iananthonystates.co.uk <https://www.iananthonystates.co.uk>