



Ian Anthony
The Estate Agents

Kingfisher Park, Skelmersdale, WN8 6XS

Guide Price £160,000

🛏 2 🚿 1 🛋 1



- SEMI-DETACHED PROPERTY • LIVING ROOM
- KITCHEN / DINER
- TWO BEDROOMS
- FAMILY BATHROOM
- GARDENS FRONT & REAR
- POPULAR RESIDENTIAL LOCATION
- IDEAL FOR FIRST TIME BUYERS



We are delighted to present this charming two-bedroom semi-detached property, located in the popular residential area of Ashurst, Skelmersdale. Perfectly suited for first-time buyers or young families, this home offers a well-maintained interior and a spacious garden, making it an ideal choice for those seeking comfort and convenience. Ground floor comprises of a porch, living room and kitchen/diner. Whilst to the first floor there are two bedrooms and a family bathroom. Externally there are attractive gardens to the front and rear. Viewings are highly recommended to appreciate what this property has to offer!

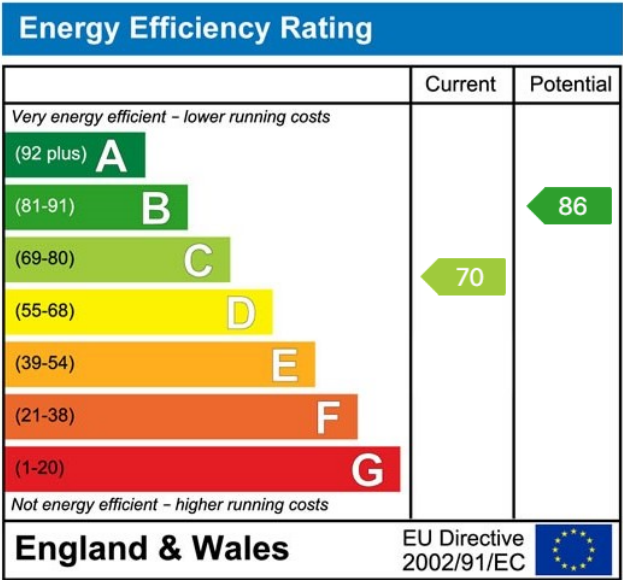
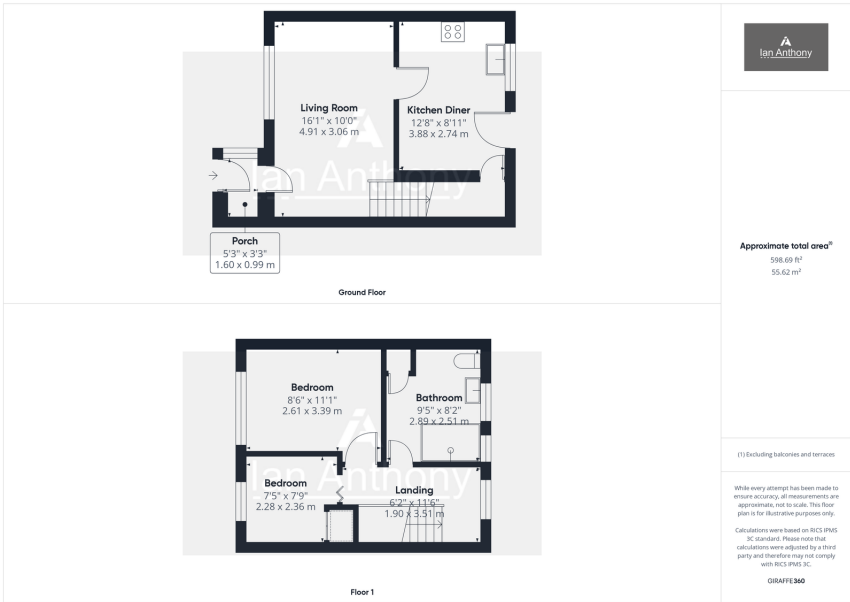

These particulars, whilst believed to be accurate are set out as a general outline only for guidance and do not constitute any part of an offer or contract. Intending purchasers should not rely on them as statements of representation of fact, but must satisfy themselves by inspection or otherwise as to their accuracy. No person in this firms employment has the authority to make or give any representation or warranty in respect of the property.