





Ian Anthony

The Estate Agents

Hampton Court, Aughton Park Drive, L39 5RJ

Guide Price £240,000

 2  2  1



- NO CHAIN!
- TWO BEDROOMS
- SPACIOUS BALCONY OVERLOOKING FIELDS
- KITCHEN/DINING AREA
- FIRST FLOOR APARTMENT
- EN SUITE ON MASTER BEDROOM
- COMMUNAL GARDENS & PARKING
- GREAT LOCATION!



Located in the prestigious Hampton Court development in Aughton, this immaculate two-bedroom first-floor apartment offers modern living in a serene and beautifully maintained setting. Surrounded by well-kept communal gardens, the property features allocated parking for one car, along with convenient additional visitor parking. Inside, the apartment boasts two generously sized bedrooms, each equipped with fitted wardrobes, while the primary bedroom benefits from a stylish en-suite bathroom. The spacious living room opens onto a private balcony with views over open country fields, creating a perfect spot for relaxation, and flows seamlessly into a bright and modern kitchen/diner. A pristine main bathroom completes the interior, providing convenience and style. Positioned in the highly sought-after Aughton area, the apartment is within close proximity to local train stations offering direct routes to Liverpool city centre, making it an excellent choice for

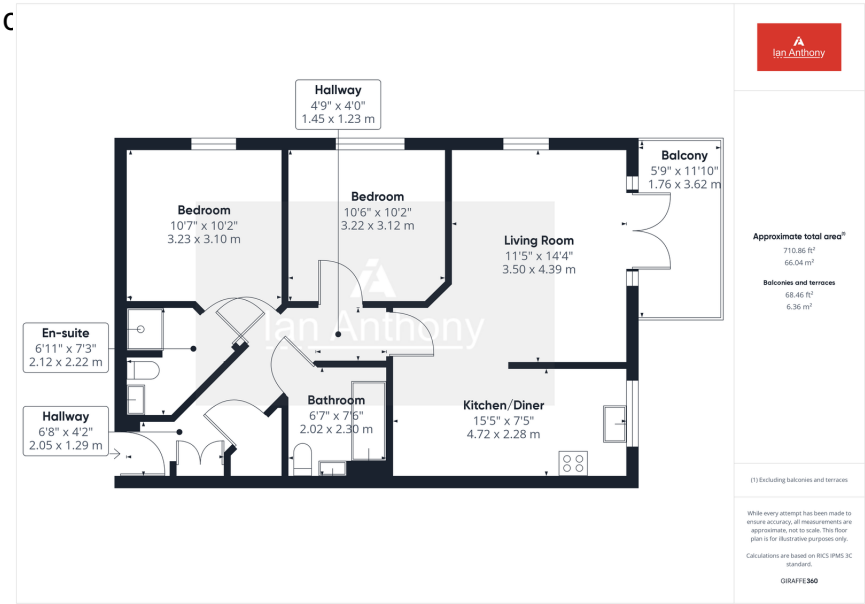

These particulars, whilst believed to be accurate are set out as a general outline only for guidance and do not constitute any part of an offer or contract. Intending purchasers should not rely on them as statements of representation of fact, but must satisfy themselves by inspection or otherwise as to their accuracy. No person in this firms employment has the authority to make or give any representation or warranty in respect of the property.