



# Ian Anthony

The Estate Agents



# Derby Road, Skelmersdale, WN8 8BP

Guide Price £175,000

🛏️ 2 🍳 1 🚗 2



- MID TERRACE
- DINING ROOM
- TWO BEDROOMS
- FAMILY BATHROOM
- LIVING ROOM
- KITCHEN
- LOFT ROOM
- GARDENS FRONT & REAR





Mid terraced property situated on Derby Road, Skelmersdale conveniently located for Skelmersdale and Ormskirk town centre, all associated amenities and transport links. Ground floor accommodation comprises of a living room, dining room, kitchen and family bathroom. Whilst to the first floor there are two bedrooms and a loft room. Externally there is a garden to the front and rear. Viewings are recommended to appreciate what this property has to offer!

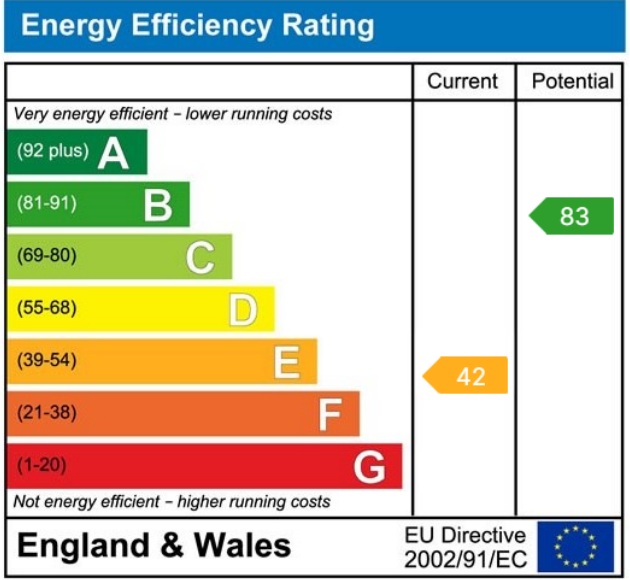
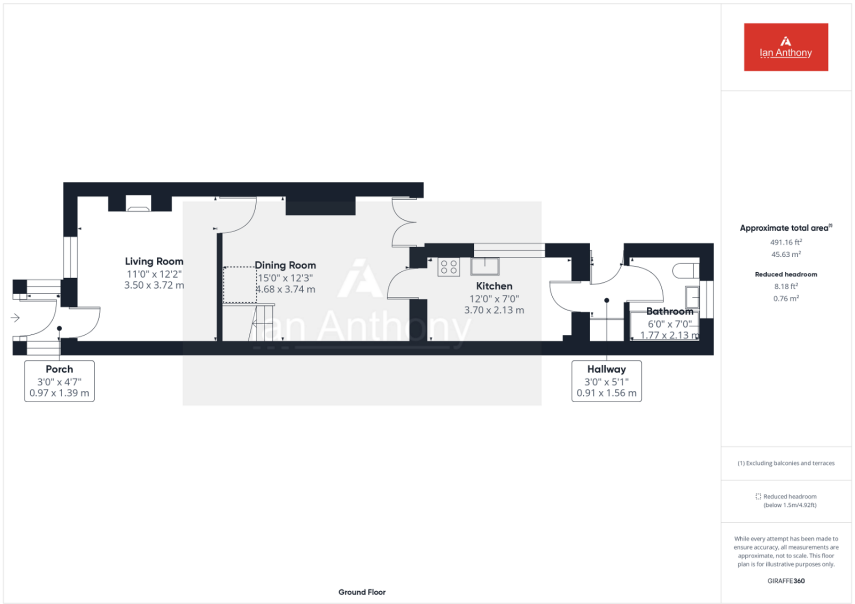

These particulars, whilst believed to be accurate are set out as a general outline only for guidance and do not constitute any part of an offer or contract. Intending purchasers should not rely on them as statements of representation of fact, but must satisfy themselves by inspection or otherwise as to their accuracy. No person in this firms employment has the authority to make or give any representation or warranty in respect of the property.