



Ian Anthony

The Estate Agents

Irwell, Skelmersdale, WN8 6JY

Guide Price £155,000

3 1 2



- SEMI-DETACHED PROPERTY • DOWNSTAIRS WC
- LIVING ROOM • KITCHEN/DINER
- MASTER BEDROOM • TWO FURTHER BEDROOMS
- FAMILY BATHROOM • FRONT&REAR GARDENS



A really well presented three-bedroom semi detached house situated in a central location of Skelmersdale. Ground floor accommodation comprises of an entrance hall, WC, living room and a kitchen/diner, whilst to the first floor, there are three bedrooms and family bathroom. Externally there is small front garden with lawn and planted borders and a fenced rear garden with a block paved patio area, lawn and planted borders.

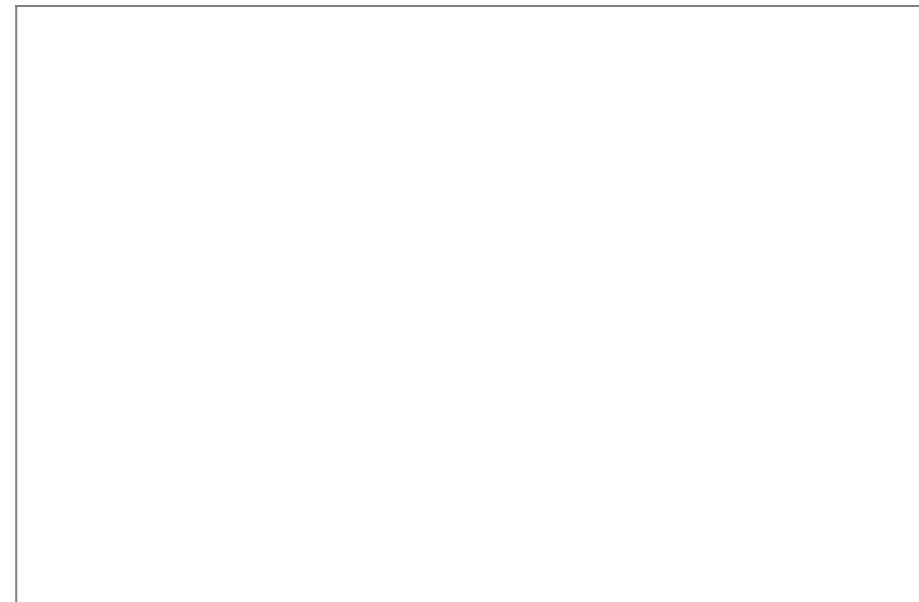
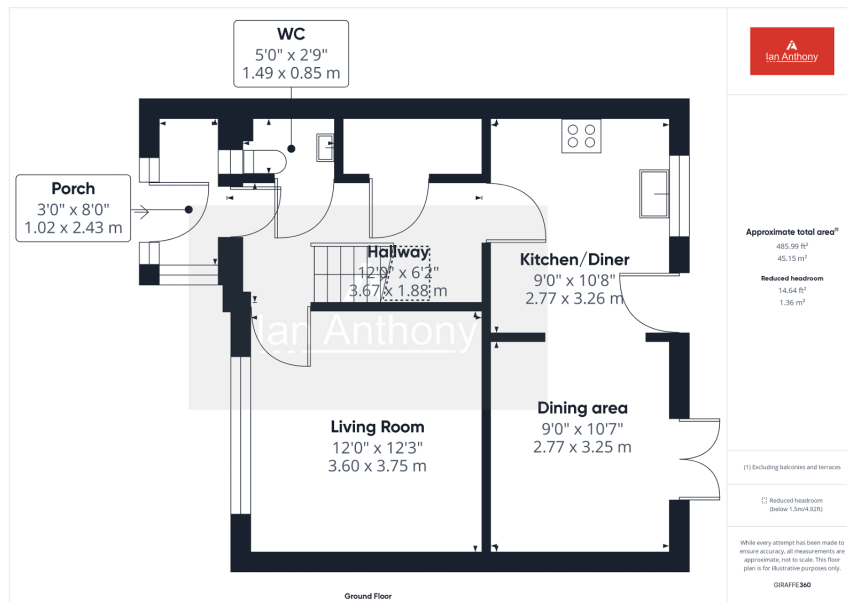

These particulars, whilst believed to be accurate are set out as a general outline only for guidance and do not constitute any part of an offer or contract. Intending purchasers should not rely on them as statements of representation of fact, but must satisfy themselves by inspection or otherwise as to their accuracy. No person in this firm's employment has the authority to make or give any representation or warranty in respect of the property.

5 Burscough Street, Ormskirk, Lancashire, L39 2EG

Tel: 01695 580888 Email: enquiries@iananthoniestates.co.uk <https://www.iananthoniestates.co.uk>