



Ian Anthony

The Estate Agents

High Grove Park, Burscough, L40 7AB

Guide Price £360,000

🛏️ 4 🚿 3 🚗 2



- DETACHED FAMILY HOME
- FITTED KITCHEN
- MASTER BEDROOM WITH EN-SUITE
- FAMILY BATHROOM & DOWNSTAIRS CLOAKROOM
- INTEGRAL GARAGE
- DINING ROOM
- LIVING ROOM
- THREE FURTHER BEDROOMS
- GARDENS FRONT & REAR
- POPULAR RESIDENTIAL LOCATION



Immaculately presented detached family home situated on High Grove Park, conveniently located for Burscough and Ormskirk town centre, transport links and all associated amenities. Ground floor accommodation comprises of an entrance hall, dining room, kitchen, living room and downstairs cloakroom. Whilst to the first floor there is a master bedroom with en-suite, three further bedrooms and a family bathroom. Externally there is a single garage, driveway proving off road parking an enclosed garden to the rear. Viewings are Highly recommended to appreciate what this property has to offer!

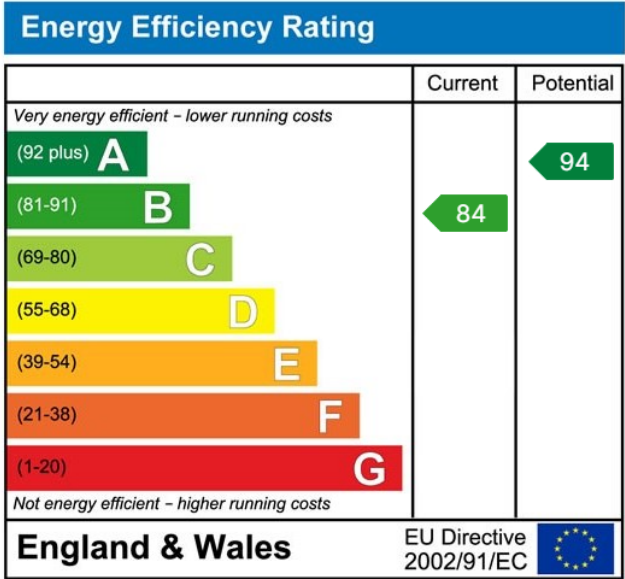
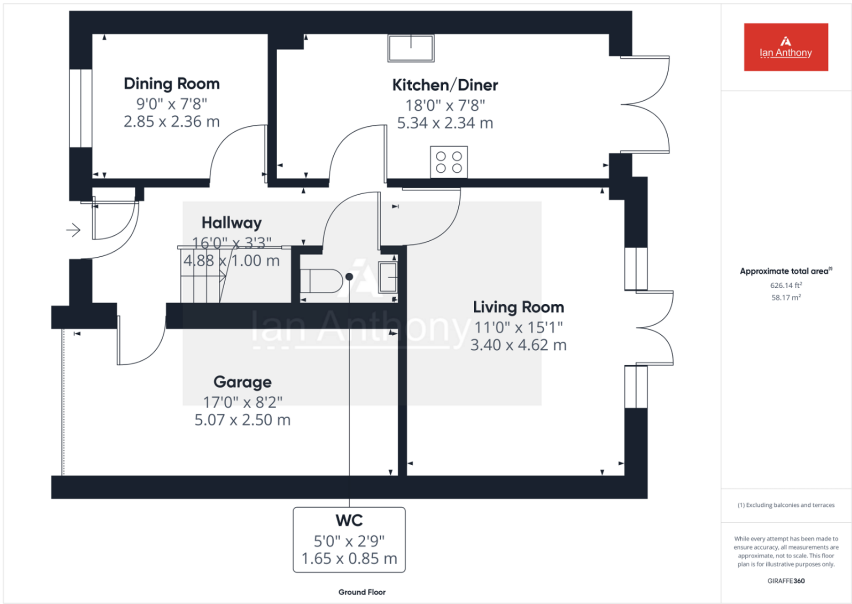

These particulars, whilst believed to be accurate are set out as a general outline only for guidance and do not constitute any part of an offer or contract. Intending purchasers should not rely on them as statements of representation of fact, but must satisfy themselves by inspection or otherwise as to their accuracy. No person in this firms employment has the authority to make or give any representation or warranty in respect of the property.