



**Ian Anthony**  
The Estate Agents

# Delph Park Avenue, Aughton, L39 5DF

Guide Price £335,000

🛏️ 4 🚿 2 🛋️ 2





Well presented semi-detached family home situated on Delph Park Avenue, Aughton conveniently located for Aughton and Ormskirk town centre, all associate amenities and transport links. Ground floor accommodation comprises of a lounge, living room/dining room, kitchen, sun room and family bathroom. Whilst to the first floor there is a master bedroom with en-suite and three additional bedrooms. Externally there is a low maintenance front garden with driveway providing off road parking, an integral garage and an enclosed garden to the rear. Viewings are highly recommended to appreciate what this property has to offer!

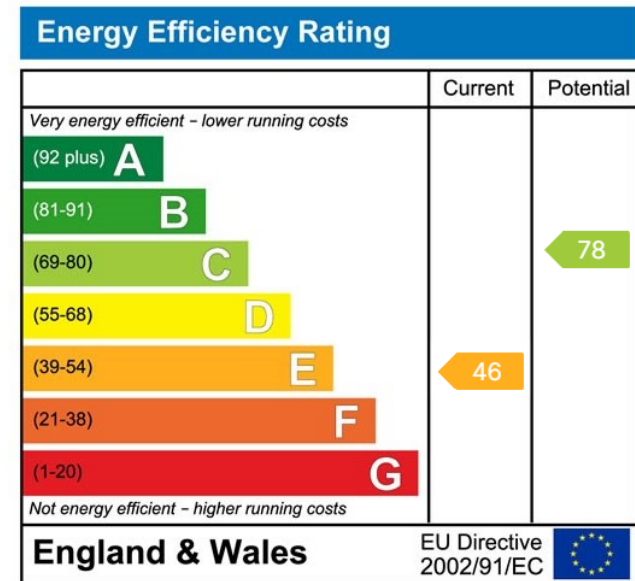
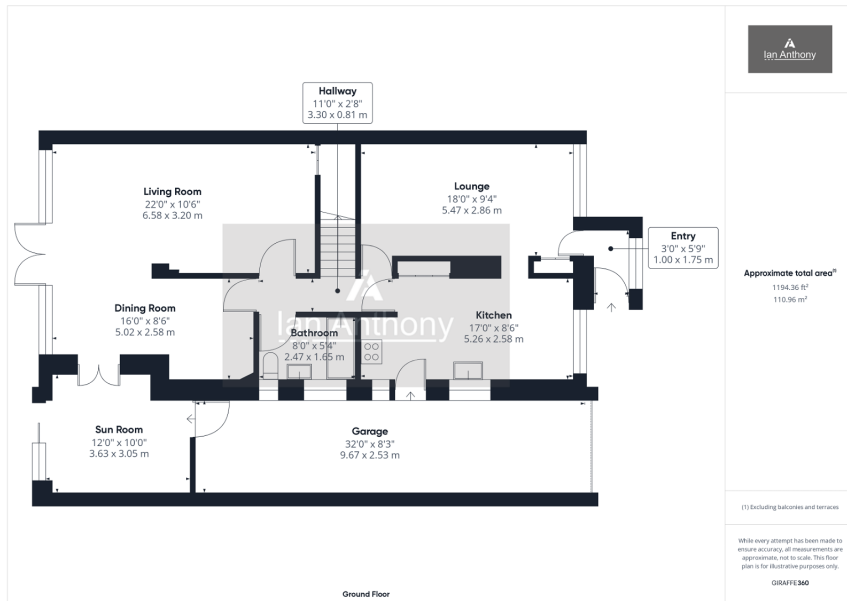

These particulars, whilst believed to be accurate are set out as a general outline only for guidance and do not constitute any part of an offer or contract. Intending purchasers should not rely on them as statements of representation of fact, but must satisfy themselves by inspection or otherwise as to their accuracy. No person in this firm's employment has the authority to make or give any representation or warranty in respect of the property.