

For identification purposes

To Let (July 24)



Industrial / Warehouse Unit

Unit 17 Hurworth Road, Aycliffe Business Park, Newton Aycliffe DL5 6UD
Approximately 2,435.73 sq m (26,216 sq ft)

CONNECT NORTH EAST
PROPERTY
01642 602001

LOCATION

The property is located on the heart of Aycliffe Industrial Estate one of the largest estates in the North East. The building itself is located on Hurworth Road, which in turn provides excellent access to the A167 and Junction 59 of the A1(M) thereafter.

DESCRIPTION

The property incorporates the following specification:

- 5.5m - 6m Eaves
- Approximately 1.80 Acre Site
- Covered Loading Canopy
- 2 x Insulated Goods Access Doors
- LED Lighting
- 250 KVA/ 400 Amp Power Supply
- 48 Car Parking Spaces
- 8 x 22 KW EV Charging Points
- Kitchenette/ WC's
- 0.85 of adjoining additional land available on request and way of separate negotiation.

ACCOMMODATION

The units have the following approximate gross internal floor areas:

Warehouse	1,808 sq m	19,469 sq ft
Canopy	627.73 sq m	6,747 sq ft
TOTAL	2,435.73 sq m	26,216 sq ft

ENERGY PERFORMANCE CERTIFICATE

The EPC will be provided upon completion of the building.



TERMS

The property is available To Let by way of a new full repairing and insuring lease at an asking rent of £180,000 per annum exclusive. Further information is available upon application.

RATING ASSESSMENT

We understand the property will be assessed for business rates upon completion.

VIEWING

Strictly through the joint agents Connect Property North East:

Jonathan Simpson ddl: 01642 704931

Email: jonathan@cpne.co.uk

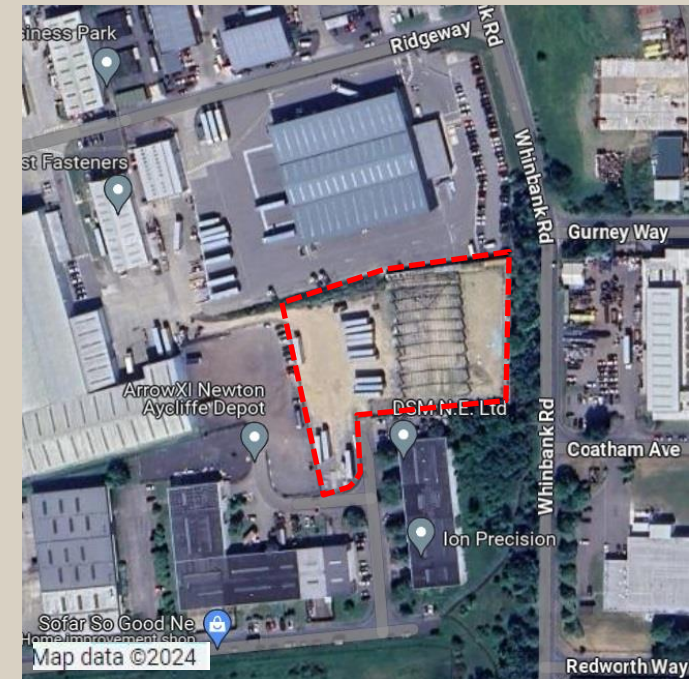

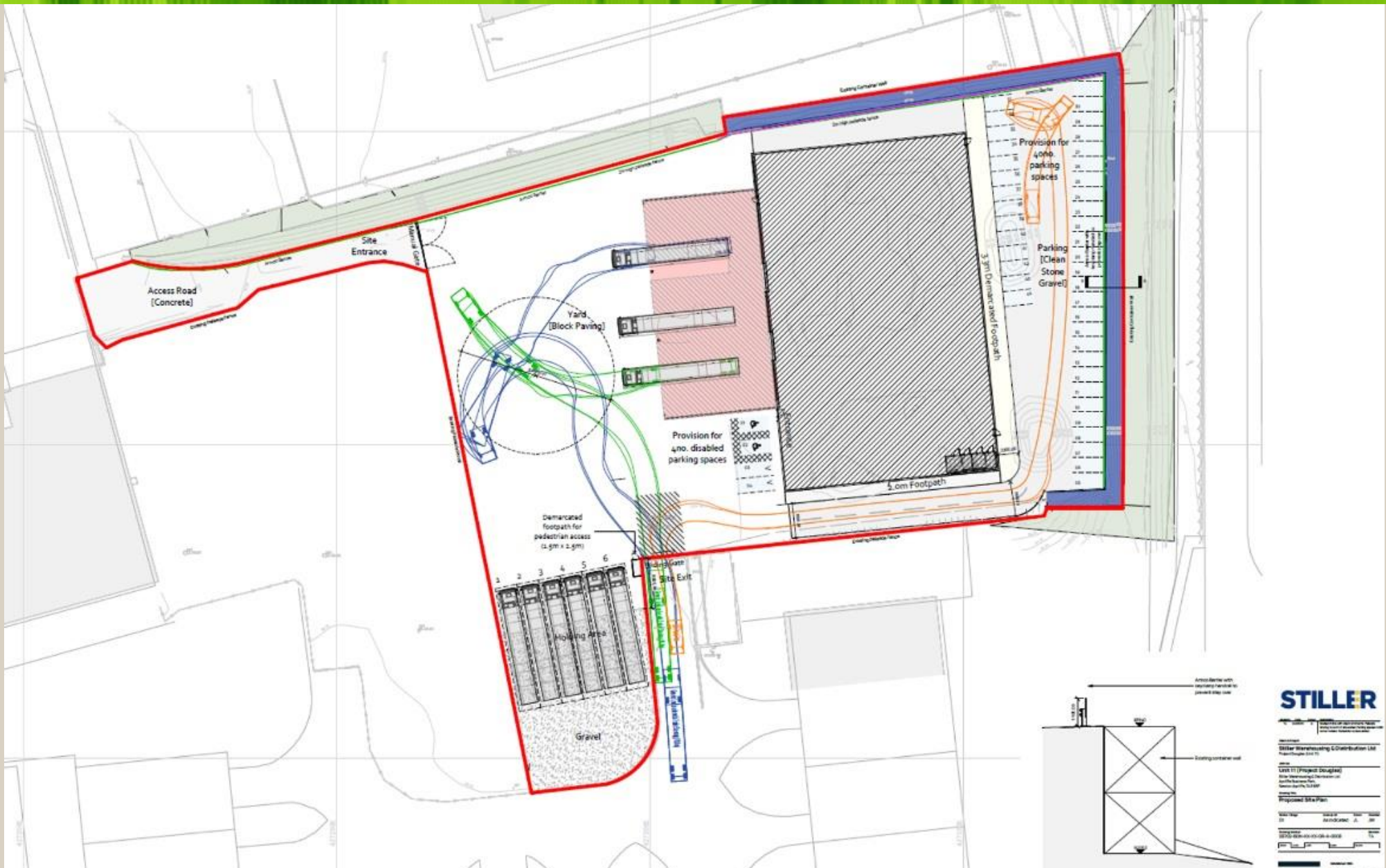

IMPORTANT NOTICE: whilst every reasonable effort has been made by Connect Property North East to ensure accuracy, interested parties are strongly advised to take appropriate steps to verify by independent inspection or enquiry all information for themselves and to take appropriate professional advice. (i) No description or information given about the property or its value, whether written or verbal or whether or not in these particulars ('information') may be relied upon as a statement of representation or fact. Connect Property North East nor its employees have any authority to make any representation and accordingly any information given is entirely without responsibility on the part of Connect Property North East or the seller / lessor. (ii) Any photographs show only certain parts of the property at the time they were taken. Any areas, measurements or distances given are approximate only. (iii) Any reference to alterations to, or use of any part of the property is not a statement that any necessary planning, building regulations or other consent has been obtained. These matters must be verified by any intending buyer / lessee. (iv) Any buyer/lessee must satisfy himself by inspection or otherwise as to the correctness of any information given. (v) VAT is applicable unless expressly stated otherwise. Registered Company Number 9404628