

*For identification purposes*

**FOR SALE**

## **Workshops, Offices and Yard Facility**

Sotherby Road, Skippers Lane, Middlesbrough TS3 8BS

**CONNECT** NORTH EAST  
**PROPERTY**  
01642 602001





### LOCATION

The property is located on Sotherby Road, off Skippers Lane on the established Skippers Lane Industrial Estate. The property has good access to the A66 and A19 Trunk Roads. Middlesbrough Town Centre is situated approximately 2 miles to the west.

### ACCOMMODATION

GF Office	709.14 sq m	7,632 sq ft
FF Office	378.14 sq m	4,070 sq ft
<b>Total</b>	<b>1,087.28 sq m</b>	<b>11,703 sq ft</b>
Workshop & Stores	536.39 sq m	5,776 sq ft
Detached Offices	257.60 sq m	2,772 sq ft
Workshop	400 sq m	4,305 sq ft
<b>TOTAL</b>	<b>2,281.27 sq m</b>	<b>24,555 sq ft</b>

Site Area – Approximately 4 Acres

### ENERGY PERFORMANCE CERTIFICATE

The EPC has been commissioned and will be available for inspection in due course.

Further information is available upon application.

### DESCRIPTION

The property comprises a secure industrial/ workshop facility incorporating the following specification:

- 4 Acre Site
- Two Storey Open Plan Office Block With Meeting Rooms
- Large Secure Yard
- Car Parking
- Suitable for Sub-division
- Warehouse Unit
- Detached Workshop Unit and Stores with Inspection Pits (5 x Loading Doors)



### TERMS

The site is available at an asking price of £1,750,000 exclusive of VAT

### RATING ASSESSMENT

Interested parties are advised to contact the Local Rating Authority to obtain the precise rates payable.

### VIEWING

Strictly through the joint agents Connect Property North East:

**Jonathan Simpson** ddl: 01642 704931

Email: [jonathan@cpne.co.uk](mailto:jonathan@cpne.co.uk)





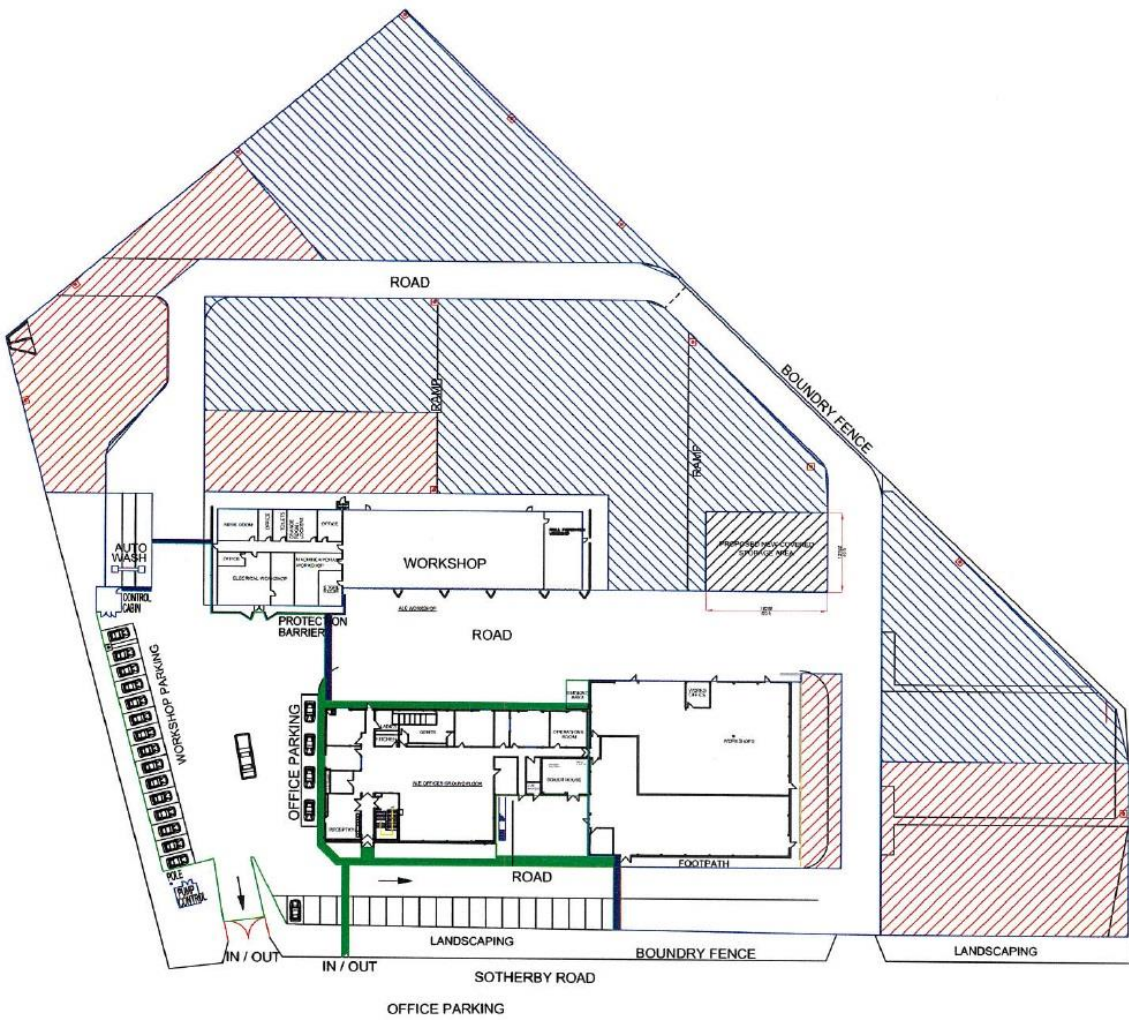

**IMPORTANT NOTICE:** whilst every reasonable effort has been made by Connect Property North East to ensure accuracy, interested parties are strongly advised to take appropriate steps to verify by independent inspection or enquiry all information for themselves and to take appropriate professional advice. (i) No description or information given about the property or its value, whether written or verbal or whether or not in these particulars ('information') may be relied upon as a statement of representation or fact. Connect Property North East nor its employees have any authority to make any representation and accordingly any information given is entirely without responsibility on the part of Connect Property North East or the seller / lessor. (ii) Any photographs show only certain parts of the property at the time they were taken. Any areas, measurements or distances given are approximate only. (iii) Any reference to alterations to, or use of any part of the property is not a statement that any necessary planning, building regulations or other consent has been obtained. These matters must be verified by any intending buyer / lessee. (iv) Any buyer/lessee must satisfy himself by inspection or otherwise as to the correctness of any information given. (v) VAT is applicable unless expressly stated otherwise. Registered Company Number 9404628