



## 3 Kingsgate House, 2-8 Kingsgate Place, London NW6 4TA

Situated in an impressive private development boasting a contemporary courtyard and a roof terrace, this spacious two-bedroom apartment offers 888 sq. ft. of living space with high ceilings, abundant natural light, and a modern finish throughout. Located on the first floor with lift access, the apartment features two generously sized double bedrooms, a family bathroom, an ensuite shower room, and an open-plan kitchen and living area benefitting from a mews street-facing balcony. The property has been meticulously maintained and includes ample built-in storage. This development is ideal for families, professionals, or those seeking an investment opportunity. Conveniently located near West Hampstead, Kilburn, Brondesbury, Maida Vale and Queen's Park, residents can reach a wide variety of shops, restaurants, parks, amenities, and schools, as well as excellent cross-London transport links, including Thameslink, London Overground, Jubilee, and Bakerloo lines. Conveniently located near West Hampstead, Kilburn, and Queen's Park, residents can enjoy a wide range of shops and amenities, as well as excellent transport links, including Thameslink, London Overground, Jubilee, and Bakerloo lines

**Guide Price £625,000 Subject To Contract Leasehold**

**Knight Frank Queens Park**

+442038153020

queenspark@knightfrank.com

60C Salusbury Road London NW6 6NP

**knightfrank.co.uk**  
Connecting people & property, perfectly.





#### Important Notice

Please note, neither Knight Frank LLP nor any joint agent has any authority to make any representations about the property. Knight Frank LLP accepts no responsibility for the contents of this brochure and the information within it should not be relied upon as statements of fact concerning the property, its condition or value. This brochure does not constitute, in whole or in part, an offer or contract. Any buyer, lessee or otherwise interested party must satisfy themselves through their own investigations, surveys, enquiries and inspections that the property is suitable for their purposes and that the information in this brochure accurately depicts the property. Knight Frank is the trading name of Knight Frank LLP. Knight Frank LLP is a limited liability partnership registered in England and Wales with registered number OC305934. Our registered office is at 55 Baker Street, London W1U 8AN where you may look at a list of members' names. If we use the term 'partner' when referring to one of our representatives, that person will either be a member, employee, worker or consultant of Knight Frank LLP and not a partner in a partnership.

If you do not want us to contact you further about our services then please contact us by either calling 020 3544 0692, email to [marketing.help@knightfrank.com](mailto:marketing.help@knightfrank.com) or post to our UK Residential Marketing Manager at our registered office (above) providing your name and address.

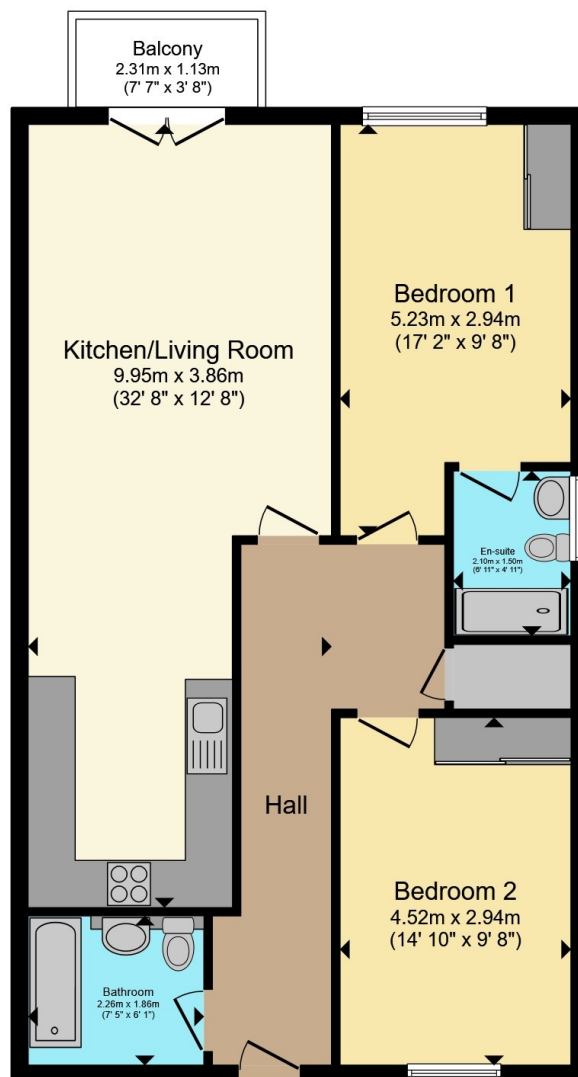

Total floor area 82.5 sq.m. (888 sq.ft.) approx

This floor plan is for illustrative purposes only. It is not drawn to scale. Any measurements, floor areas (including any total floor area), openings and orientation are approximate. No details are guaranteed, they cannot be relied upon for any purpose and they do not form part of any agreement. No liability is taken for any error, omission or misstatement. A party must rely upon its own inspection(s).