



Leslie Road, East Finchley, N2

 2 Bedrooms  1 Bathroom  1 Reception



OIEO £560,000



Adam Hayes - East Finchley Office - Sales 158 High Road, East Finchley, London, N2 9AS  
Tel: 0208 883 2621 Email: [info@adam-hayes.co.uk](mailto:info@adam-hayes.co.uk) Web: [www.adam-hayes.co.uk](http://www.adam-hayes.co.uk)

# Leslie Road, East Finchley, N2

## OIEO £560,000

 2 Bedrooms  1 Bathrooms  1 Receptions

### Key Features

- Two Bedrooms
- Ground Floor
- Garden
- Character Features
- Modern Kitchen
- Popular School Catchment

### Other Information

Tenure: Leasehold  
Length of Lease: 100 Years  
Ground Rent: £100 P/A  
Service Charge: £100 P/A  
Council Tax Band: C

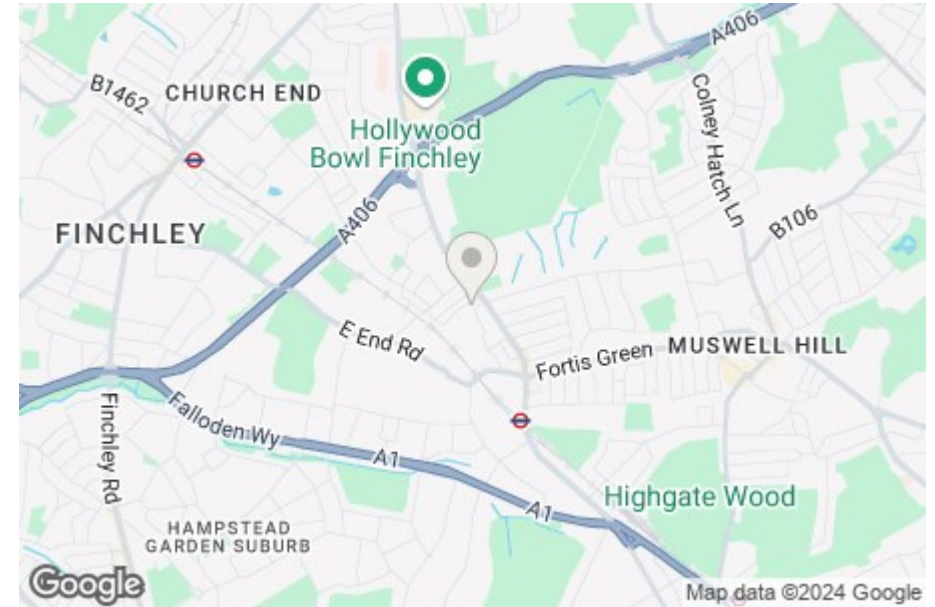

### Nearest Stations

East Finchley Station 0.5 miles  
Finchley Central Station 1.2 miles  
West Finchley Station 1.4 miles

### Property Description

Situated on Leslie Road, East Finchley, N2, in a quiet residential turning off East Finchley High Road, this charming two-bedroom ground-floor maisonette is within walking distance to local shops, amenities, and transport links. Conveniently located in the catchment area for several popular schools, including the highly regarded Martins Primary School, this well-presented property offers excellent accommodation throughout. The home features a spacious 15ft modern kitchen diner, perfect for entertaining, and a bright and airy reception room. Additional benefits include a three-piece bathroom suite and its own private section of garden, ideal for outdoor relaxation. With its desirable location, close to East Finchley's vibrant High Road, and the potential to further enhance, this property would make an ideal first-time purchase or investment. An internal viewing is highly recommended to fully appreciate the space, location, and potential. For more information or to arrange a viewing, contact the vendors' main agents, Adam Hayes Estate Agents.

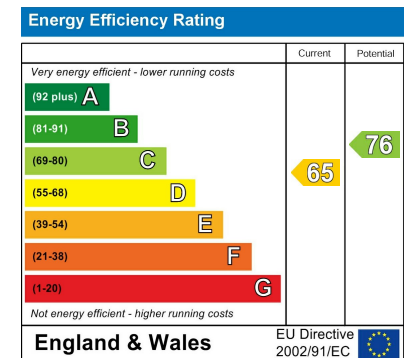

Adam Hayes - East Finchley Office - Sales 158 High Road, East Finchley, London, N2 9AS

Tel: 0208 883 2621 Email: info@adam-hayes.co.uk Web: www.adam-hayes.co.uk

**Approximate Gross Internal Area  
748 sq ft - 69 sq m**

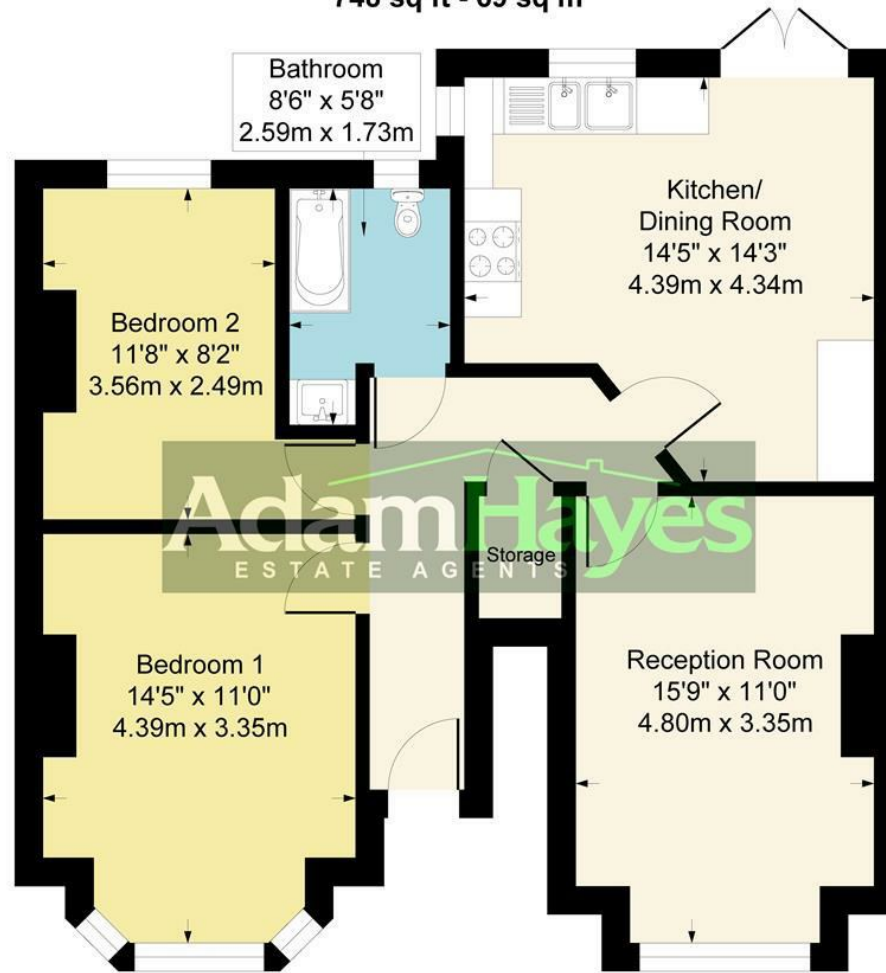

**Ground Floor**

Although every attempt has been made to ensure accuracy, all measurements are approximate.  
This floorplan is for illustrative purposes only and not to scale.  
Measured in accordance with RICS Standards.

These particulars, whilst believed to be accurate, are set out as a general outline only for guidance and do not constitute any part of an offer or contract. Intending purchasers or prospective tenants should not rely on them as statements or representation of fact, but must satisfy themselves by inspection or otherwise as to their accuracy. We have not carried out a detailed survey, not tested the services, appliances and specific fittings. Room sizes should not be relied upon for carpets and furnishings. The measurements given are approximate. No person in this firm's employment has the authority to make or give any representation or warranty in respect of the property.