



Ossulton Way, Hampstead Garden Suburb, N2

£2,100 PCM

 2 Bedrooms  1 Bathroom  1 Reception



Adam Hayes - East Finchley Office - Lettings 158 High Road, East Finchley, London, N2 9AS

Tel: 0208 883 2621 Email: [info@adam-hayes.co.uk](mailto:info@adam-hayes.co.uk) Web: [www.adam-hayes.co.uk](http://www.adam-hayes.co.uk)

# Ossulton Way, Hampstead Garden Suburb, N2

## £2,100 PCM

2 Bedrooms 1 Bathrooms 1 Receptions

### Key Features

- Two Bedrooms
- Balcony
- Easy Access To East Finchley Tube
- Modern Kitchen
- Communal Gardens
- Unfurnished

### Nearest Stations

- East Finchley Station 0.7 miles
- Finchley Central Station 0.9 miles
- West Finchley Station 1.4 miles

### Property Description

Welcome to this charming maisonette located on Ossulton Way in the prestigious Hampstead Garden Suburb, N2. This delightful property boasts a cosy reception room, perfect for relaxing or entertaining guests. With two bedrooms, there is ample space for a small family, guests, or even a home office. The property boasts a modern fitted kitchen and bathroom, offering both convenience and comfort, complemented by a charming balcony and communal gardens, perfect for enjoying the outdoors. Located in a highly sought-after area, this maisonette provides a serene escape from city life while remaining close to a variety of cafes, restaurants, and local shopping amenities. Hampstead Garden Suburb is renowned for its picturesque green spaces, elegant architecture, and strong community spirit, making it a truly desirable place to live. Don't miss this opportunity. Please contact us today to arrange your viewing.

### Other Information

Council Tax Band: D  
Length of Tenancy: Long Let  
Deposit: £2,420

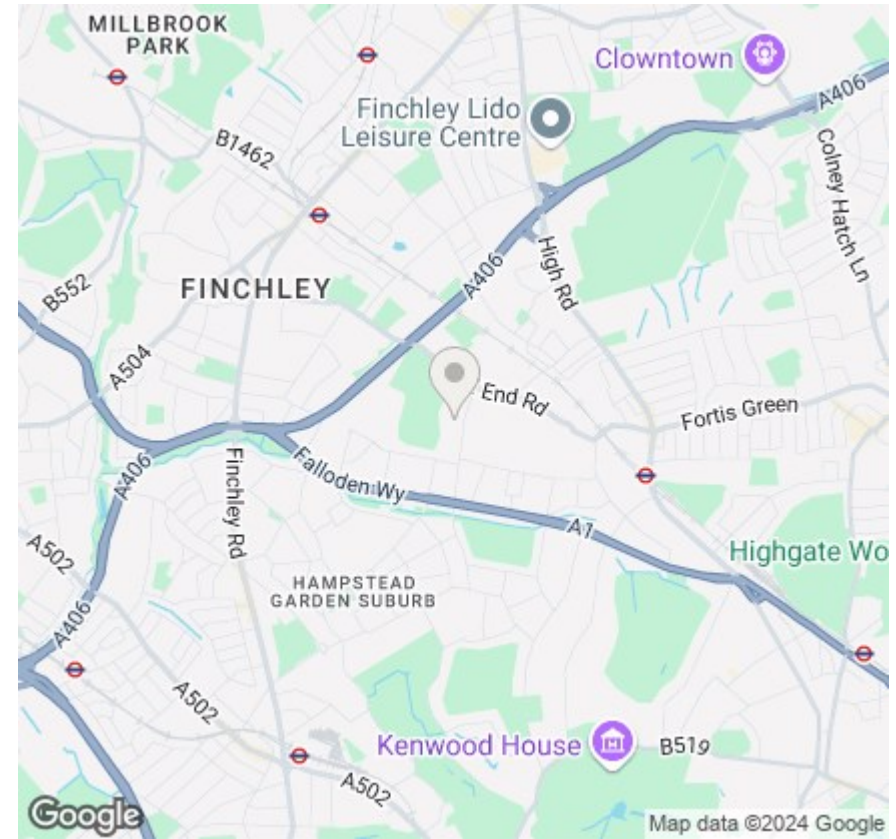

Energy Efficiency Rating		
	Current	Potential
Very energy efficient - lower running costs		
(92 plus) <b>A</b>		
(81-91) <b>B</b>		
(69-80) <b>C</b>		
(55-68) <b>D</b>	66	77
(39-54) <b>E</b>		
(21-38) <b>F</b>		
(1-20) <b>G</b>		
Not energy efficient - higher running costs		
<b>England &amp; Wales</b>	EU Directive 2002/91/EC	

Adam Hayes - East Finchley Office - Lettings 158 High Road, East Finchley, London, N2 9AS

Tel: 0208 883 2621 Email: info@adam-hayes.co.uk Web: www.adam-hayes.co.uk

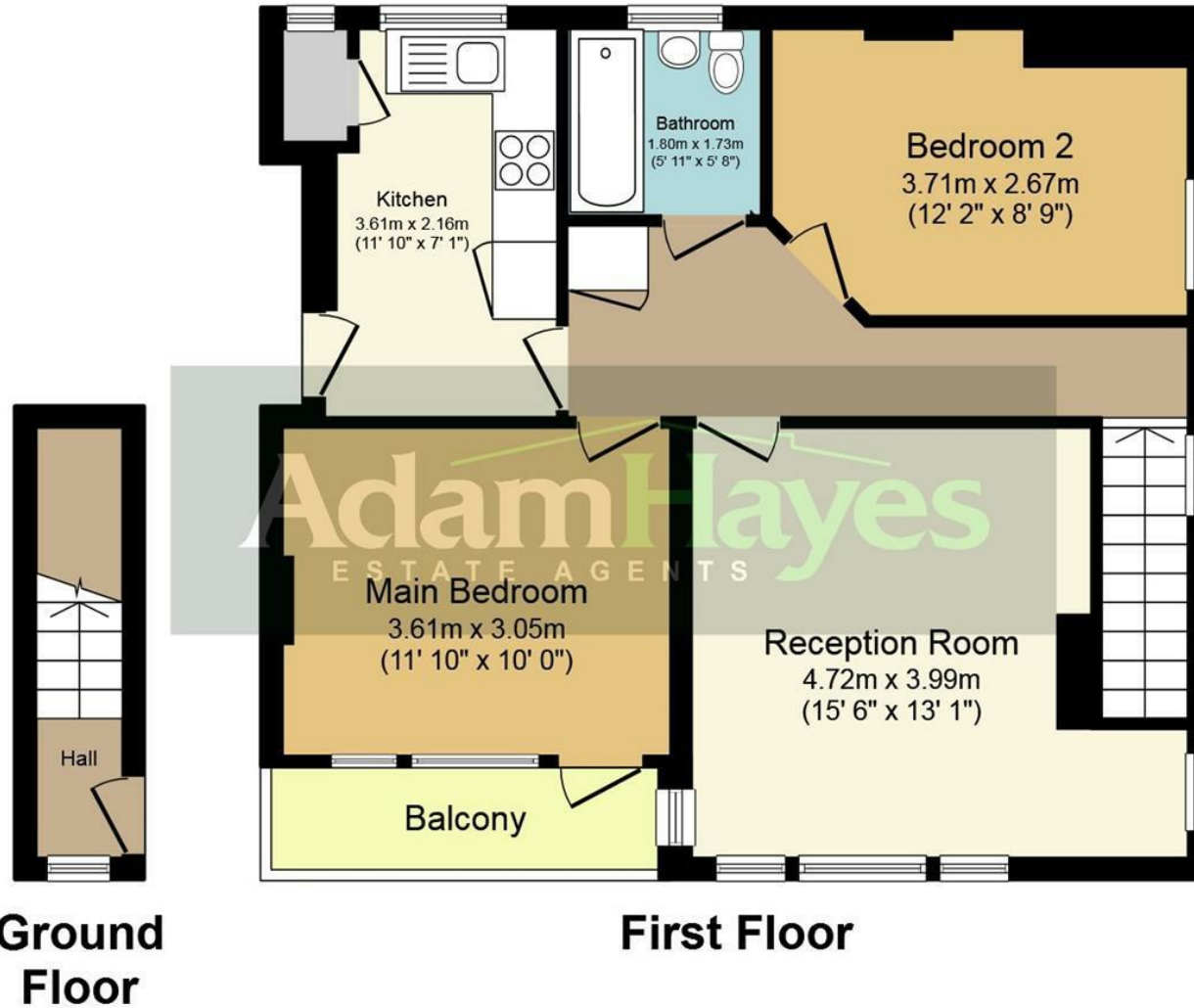

Total floor area 63.5 sq.m. (684 sq.ft.) approx

This plan is for illustration purposes only and may not be representative of the property. Plan not to scale.

These particulars, whilst believed to be accurate, are set out as a general outline only for guidance and do not constitute any part of an offer or contract. Intending purchasers or prospective tenants should not rely on them as statements or representation of fact, but must satisfy themselves by inspection or otherwise as to their accuracy. We have not carried out a detailed survey, not tested the services, appliances and specific fittings. Room sizes should not be relied upon for carpets and furnishings. The measurements given are approximate. No person in this firm's employment has the authority to make or give any representation or warranty in respect of the property.