



Lyttelton Road, Hampstead Garden Suburb, N2 0DD

 3  1  1

£2,150 Per
Month



Adam Hayes - East Finchley Office - Lettings 158 High Road, East Finchley, London, N2 9AS

Tel: 0208 883 2621 Email: info@adam-hayes.co.uk Web: www.adam-hayes.co.uk

Lyttelton Road, Hampstead Garden Suburb, N2 0DD

£2,150 Per Month

 3 Bedrooms  1 Bathrooms  1 Receptions

Key Features

- Lovely Three Bed Maisonette
- Private Garden
- Off Street Parking
- Sought After Location
- Spacious Reception
- Wooden Flooring
- Garage Optional For An Extra £100pcm

Other Information

Council Tax Band: E
Length of Tenancy: Long Let
Deposit: £2,480

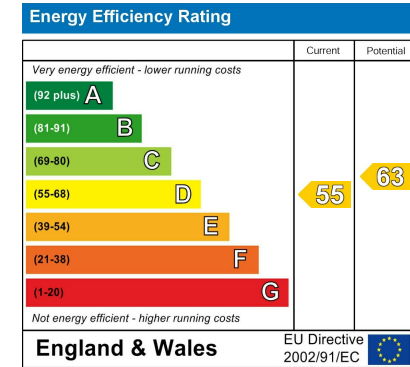

Nearest Stations

- East Finchley

Property Description

A lovely three bedroom first floor maisonette with a private garden garden and off street parking situated in this sought after location, within easy reach of East Finchley Tube Station, Brookland School, and multiple shops and amenities. The property benefits from a spacious reception, a separate WC, fitted kitchen with dishwasher, wooden flooring, secondary glazing and gas central heating. Local parks, tennis courts and various open spaces are within close proximity. Ideal for a family or two sharers only. To really appreciate the size and location, an internal viewing is highly recommended!

Adam Hayes - East Finchley Office - Lettings 158 High Road, East Finchley, London, N2 9AS

Tel: 0208 883 2621 Email: info@adam-hayes.co.uk Web: www.adam-hayes.co.uk

Approximate Gross Internal Area
984 sq ft - 91 sq m

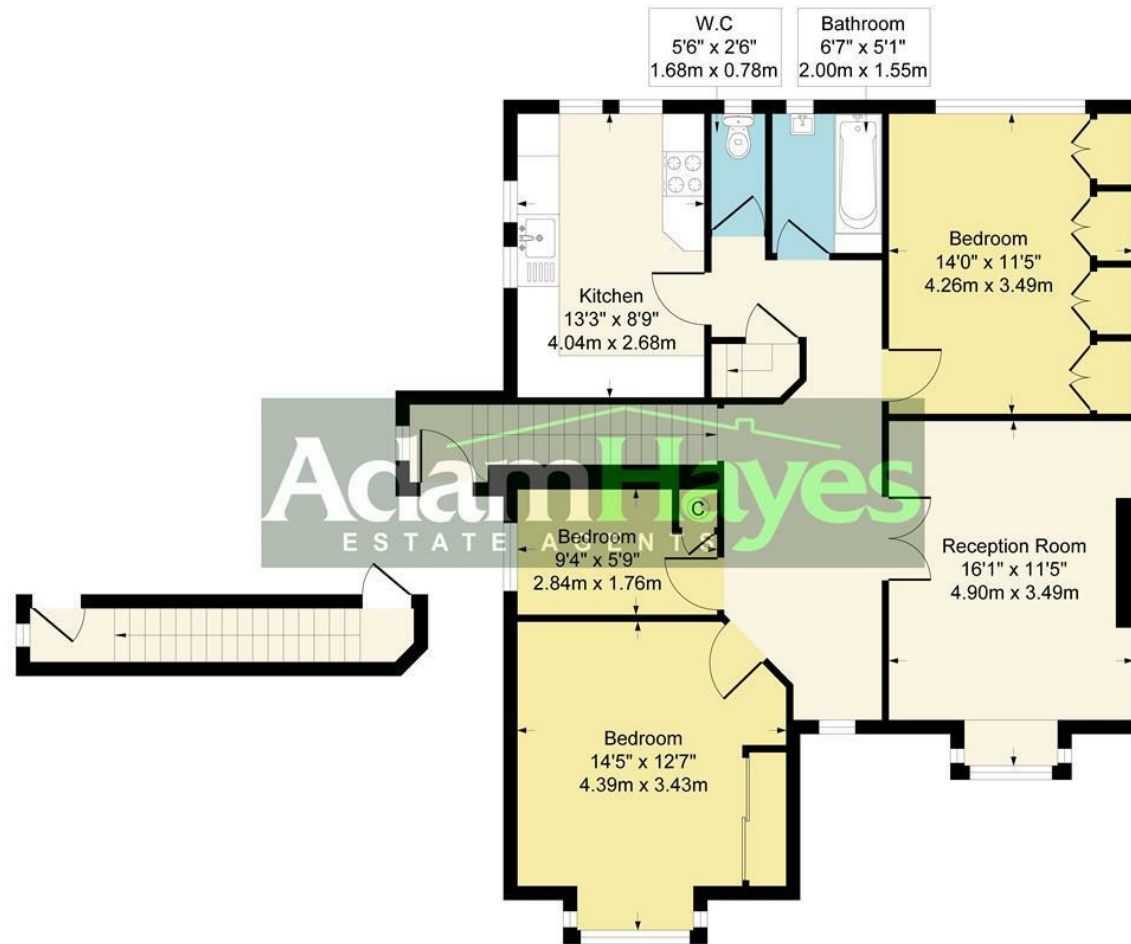

Although every attempt has been made to ensure accuracy, all measurements are approximate.
This floorplan is for illustrative purposes only and not to scale.
Measured in accordance with RICS Standards.

These particulars, whilst believed to be accurate, are set out as a general outline only for guidance and do not constitute any part of an offer or contract. Intending purchasers or prospective tenants should not rely on them as statements or representation of fact, but must satisfy themselves by inspection or otherwise as to their accuracy. We have not carried out a detailed survey, not tested the services, appliances and specific fittings. Room sizes should not be relied upon for carpets and furnishings. The measurements given are approximate. No person in this firm's employment has the authority to make or give any representation or warranty in respect of the property.