





Adam Hayes - East Finchley Office - Sales 158 High Road, East Finchley, London, N2 9AS  
Tel: 0208 883 2621 Email: [info@adam-hayes.co.uk](mailto:info@adam-hayes.co.uk) Web: [www.adam-hayes.co.uk](http://www.adam-hayes.co.uk)

East End Road, East Finchley, N2 8BA

£600,000

 3 Bedrooms  2 Bathrooms  1 Receptions

## Key Features

- Three Bedrooms Townhouse
- Two Bathrooms
- Spacious Lounge
- Close to Shops
- Modern Open Plan Kitchen
- Courtyard Garden

## Other Information

Tenure: Freehold  
Length of Lease: n/a  
Ground Rent: n/a  
Service Charge: n/a  
Service Review Period: n/a  
Council Tax Band: E

## Nearest Stations

-  
-  
-

## Property Description

Situated in this residential cul-de-sac location and set within the catchment area for a number of popular schools is this modern three bedroom, two bathroom (one ensuite) semi detached townhouse. The property is offered chain free and benefits from a modern kitchen with integrated appliances, a low maintenance courtyard garden, a guest cloakroom and gas central heating. To really appreciate the size, location and potential an internal viewing is highly recommended via vendors main agents Adam Hayes Estate Agents.

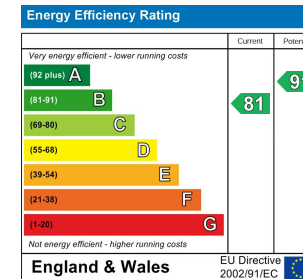

Adam Hayes - East Finchley Office - Sales 158 High Road, East Finchley, London, N2 9AS

Tel: 0208 883 2621 Email: [info@adam-hayes.co.uk](mailto:info@adam-hayes.co.uk) Web: [www.adam-hayes.co.uk](http://www.adam-hayes.co.uk)

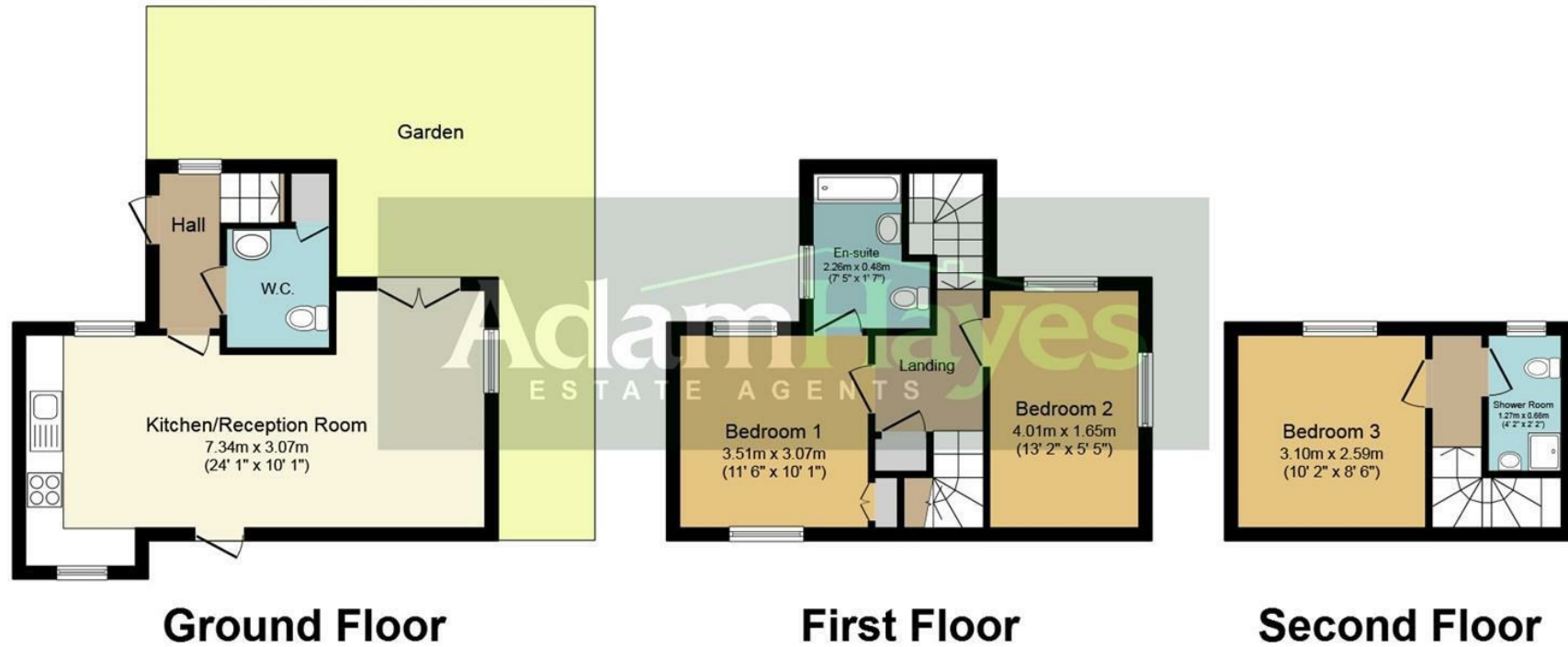

Total floor area 79.8 sq.m. (859 sq.ft.) approx

This plan is for illustration purposes only and may not be representative of the property. Plan not to scale.

These particulars, whilst believed to be accurate, are set out as a general outline only for guidance and do not constitute any part of an offer or contract. Intending purchasers or prospective tenants should not rely on them as statements or representation of fact, but must satisfy themselves by inspection or otherwise as to their accuracy. We have not carried out a detailed survey, not tested the services, appliances and specific fittings. Room sizes should not be relied upon for carpets and furnishings. The measurements given are approximate. No person in this firm's employment has the authority to make or give any representation or warranty in respect of the property.