







Adam Hayes - East Finchley Office - Lettings 158 High Road, East Finchley, London, N2 9AS

Tel: 0208 883 2621 Email: [info@adam-hayes.co.uk](mailto:info@adam-hayes.co.uk) Web: [www.adam-hayes.co.uk](http://www.adam-hayes.co.uk)

# East End Road, East Finchley, N2

## £2,500 PCM

 3 Bedrooms  2 Bathrooms  1 Receptions

### Key Features

- Three Bedrooms Townhouse
- Two Bathrooms
- Spacious Lounge
- Close to Shops
- Modern Open Plan Kitchen
- Courtyard Gardem
- Note: Landlord may market the proeprty for sale in future.

### Other Information

Council Tax Band: E  
Length of Tenancy: Long Let  
Deposit: £2,880



### Nearest Stations

East Finchley Station 0.2 miles  
Highgate Station 1.2 miles  
Finchley Central Station 1.4 miles

### Property Description

Situated in this residential cul-de-sac location and set within the catchment area for a number of popular schools is this modern three bedroom, two bathroom (one ensuite) semi detached townhouse. The property benefits from an approx. 24ft lounge with a modern kitchen with integrated appliances, a low maintenance courtyard garden, a guest cloakroom and gas central heating. Early viewings highly recommended!

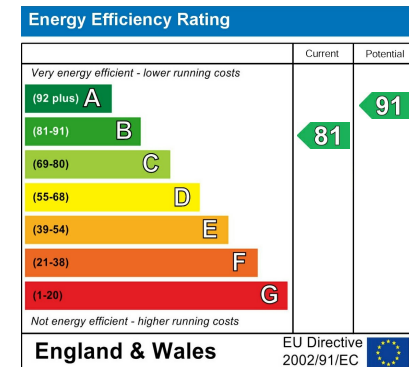

Adam Hayes - East Finchley Office - Lettings 158 High Road, East Finchley, London, N2 9AS

Tel: 0208 883 2621 Email: info@adam-hayes.co.uk Web: www.adam-hayes.co.uk

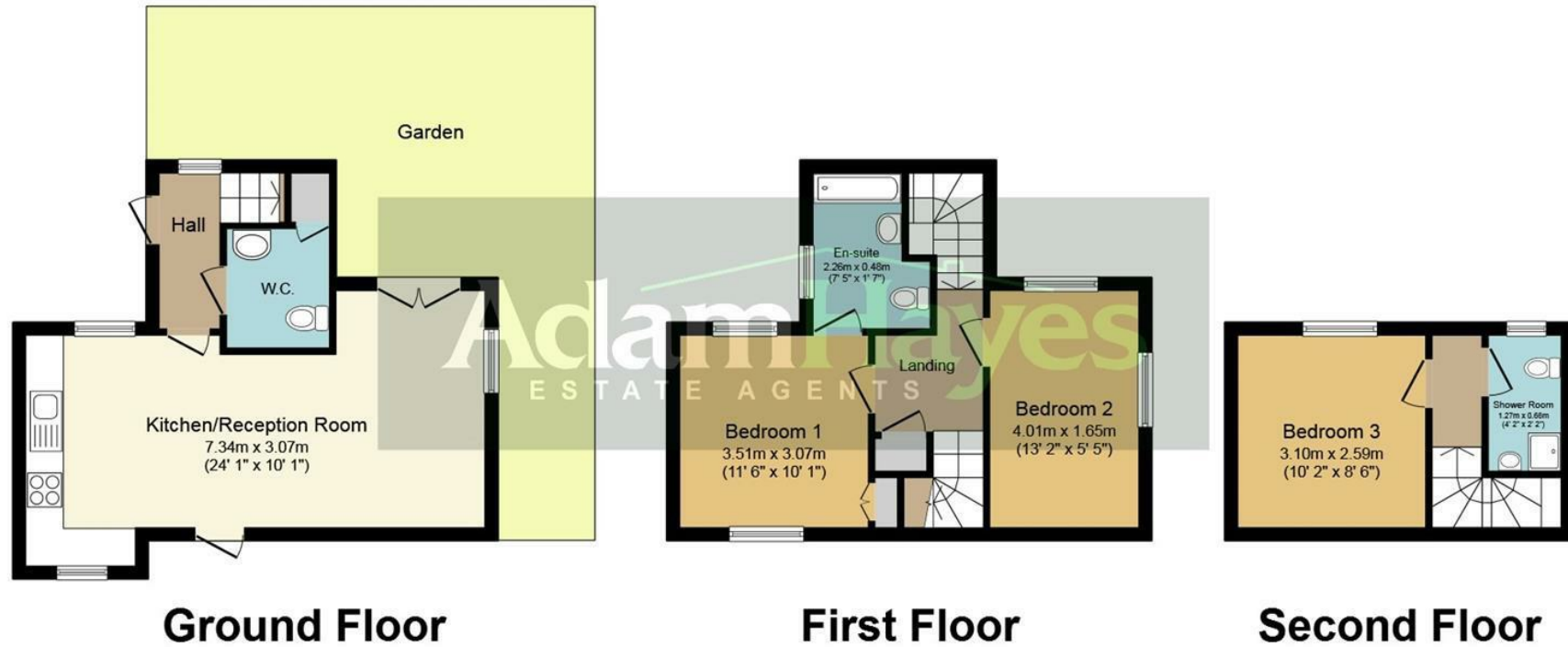

Total floor area 79.8 sq.m. (859 sq.ft.) approx

This plan is for illustration purposes only and may not be representative of the property. Plan not to scale.

These particulars, whilst believed to be accurate, are set out as a general outline only for guidance and do not constitute any part of an offer or contract. Intending purchasers or prospective tenants should not rely on them as statements or representation of fact, but must satisfy themselves by inspection or otherwise as to their accuracy. We have not carried out a detailed survey, not tested the services, appliances and specific fittings. Room sizes should not be relied upon for carpets and furnishings. The measurements given are approximate. No person in this firm's employment has the authority to make or give any representation or warranty in respect of the property.