



Wetherill Road, Muswell Hill, N10

 1 Bedroom  1 Bathroom  1 Reception

£235,000



Adam Hayes - East Finchley Office - Sales 158 High Road, East Finchley, London, N2 9AS
Tel: 0208 883 2621 Email: info@adam-hayes.co.uk Web: www.adam-hayes.co.uk

Wetherill Road, Muswell Hill, N10

£235,000

 1 Bedrooms  1 Bathrooms  1 Receptions

Key Features

- One Bedroom
- Retirement Flat
- Ground Floor
- Modern Kitchen
- Communal Gardens
- Shower Suite

Other Information

Tenure: Leasehold
Length of Lease: 90 Years
Ground Rent: N/A
Service Charge: £2,500.00 P/A
Council Tax Band: C



Nearest Stations

New Southgate Station	0.9 miles
Bounds Green Station	1.1 miles
Alexandra Palace Station	1.2 miles

Property Description

Retirement Flat! Set back off Wetherill Road in this popular warden assisted retirement block and within minutes' walk of local shops, transport facilities and amenities is this well presented one bedroom ground floor apartment.

The property benefits from an approximately 16ft living room with a modern kitchen, double glazing, a three piece shower suite, use of communal gardens and parking.

To really appreciate the size, location and facilities an internal viewing is highly recommended via vendors main agents Adam Hayes Estate Agents.

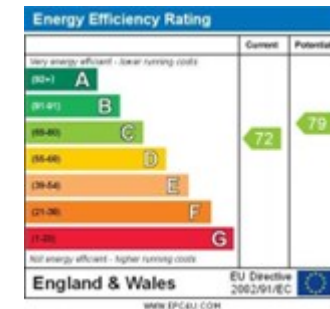

Adam Hayes - East Finchley Office - Sales 158 High Road, East Finchley, London, N2 9AS

Tel: 0208 883 2621 Email: info@adam-hayes.co.uk Web: www.adam-hayes.co.uk

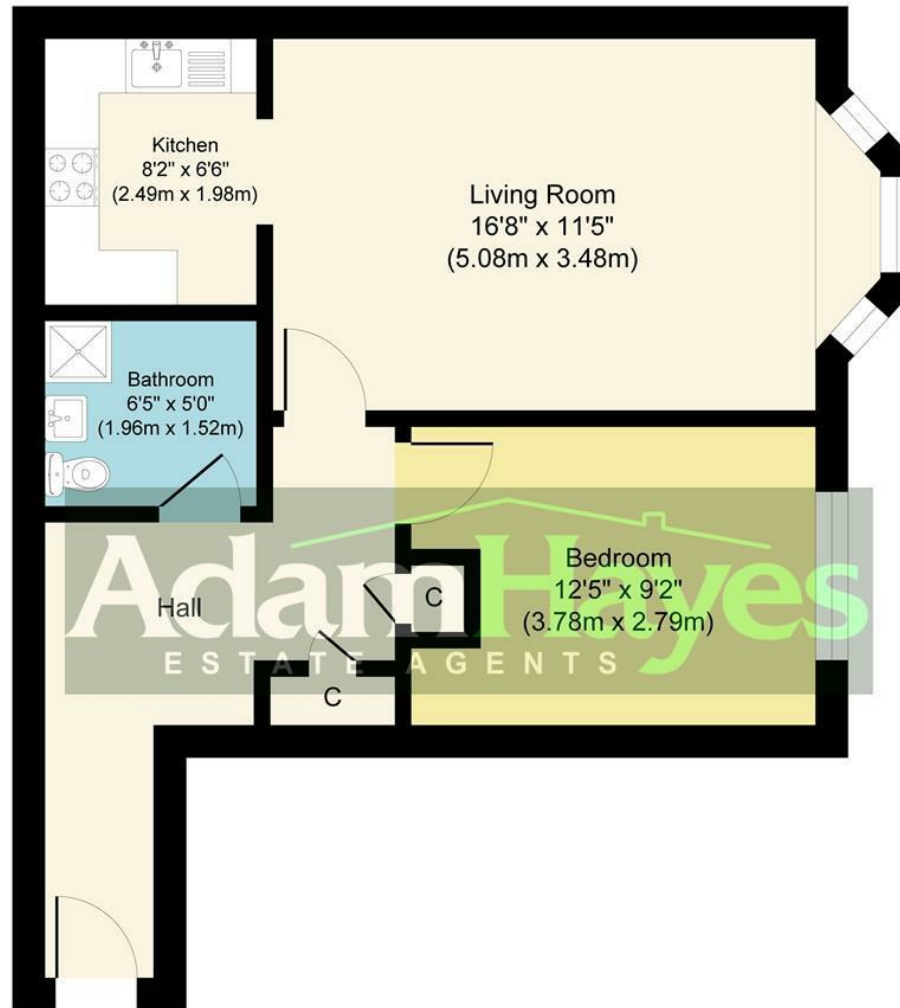

Approximate Gross Internal Area = 572 sq ft - 53 sq m

Although every attempt has been made to ensure accuracy, all measurements are approximate.
 This floorplan is for illustrative purposes only and not to scale.
 Measured in accordance with RICS Standards.

These particulars, whilst believed to be accurate, are set out as a general outline only for guidance and do not constitute any part of an offer or contract. Intending purchasers or prospective tenants should not rely on them as statements or representation of fact, but must satisfy themselves by inspection or otherwise as to their accuracy. We have not carried out a detailed survey, not tested the services, appliances and specific fittings. Room sizes should not be relied upon for carpets and furnishings. The measurements given are approximate. No person in this firm's employment has the authority to make or give any representation or warranty in respect of the property.