

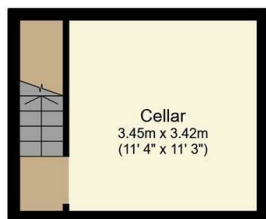

112 Sackville Road, Sheffield, S10 1GW

Asking Price £260,000

- No onward chain
- Secure rear garden
- Walking distance to the city centre, central hospitals and universities
- Four bedrooms
- Perfect for a first-time buyer
- Freehold
- End terrace
- Close to local pubs, cafes and restaurants
- Council tax band A



Basement

Floor area 15.2 sq.m. (164 sq.ft.)

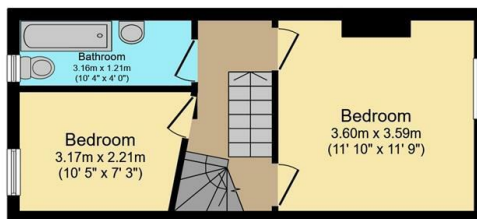

First Floor

Floor area 29.2 sq.m. (314 sq.ft.)

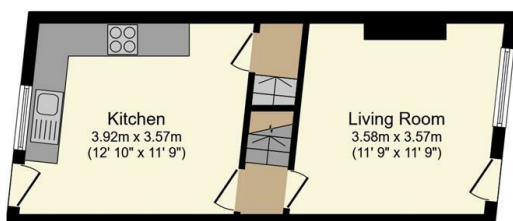

Ground Floor

Floor area 29.8 sq.m. (321 sq.ft.)

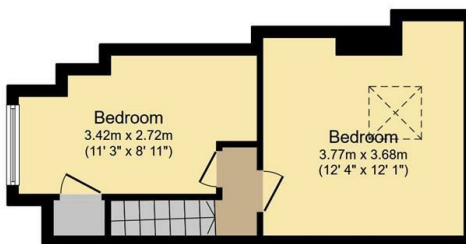

Second Floor

Floor area 28.2 sq.m. (304 sq.ft.)

Total floor area: 102.5 sq.m. (1,103 sq.ft.)

This floor plan is for illustrative purposes only. It is not drawn to scale. Any measurements, floor areas (including any total floor area), openings and orientations are approximate. No details are guaranteed, they cannot be relied upon for any purpose and do not form any part of any agreement. No liability is taken for any error, omission or misstatement. A party must rely upon its own inspection(s). Powered by www.Propertybox.io

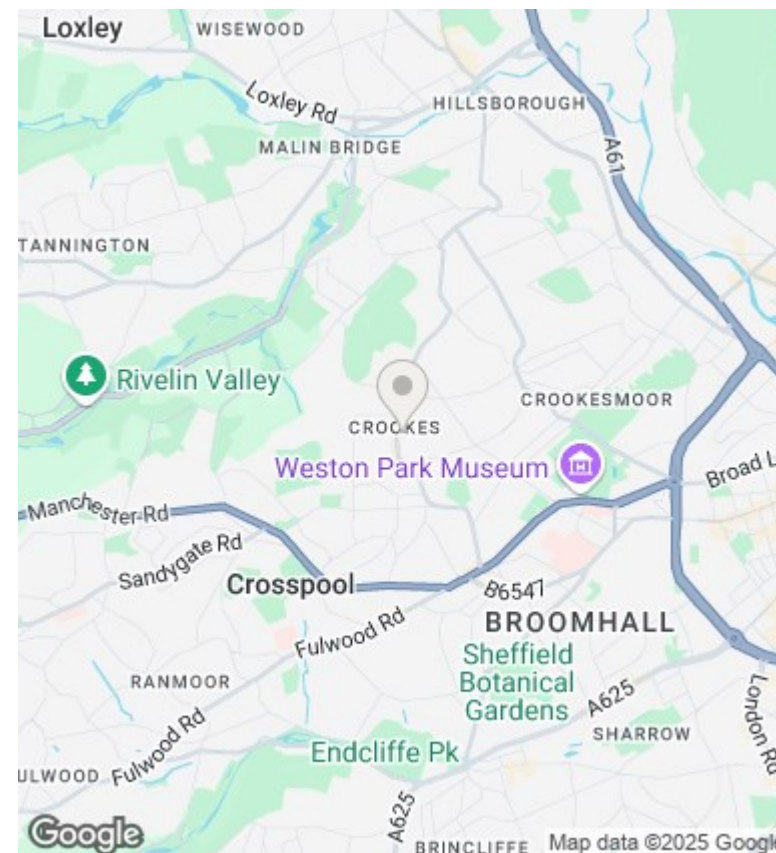

Directions

Viewings

Viewings by arrangement only. Call 01142 687777 to make an appointment.

Council Tax Band

B

EPC Rating:

D

Energy Efficiency Rating		
	Current	Potential
Very energy efficient - lower running costs		
(92 plus) A		87
(81-91) B		
(69-80) C		
(55-68) D	57	
(39-54) E		
(21-38) F		
(1-20) G		
Not energy efficient - higher running costs		
England & Wales		EU Directive 2002/91/EC