

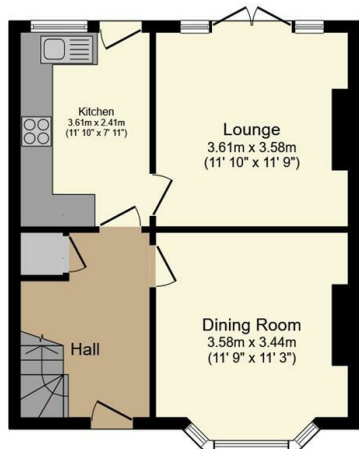

25 Ryegate Crescent, Sheffield, South Yorkshire, S10 5FD

Asking Price £380,000

- Semi-detached home
- Separate dining room
- Shared driveway and detached garage
- Long leasehold
- Three bedrooms
- Quiet location
- Short walk to Crookes, Crosspool and Broomhill
- Cosy living room with woodburner
- Good size rear garden
- Within the catchment area for highly regarded schools



Ground Floor

Floor area 44.4 m² (478 sq.ft.)

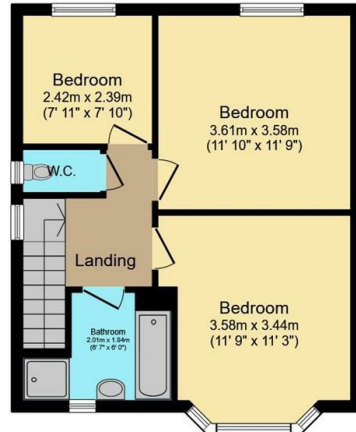

First Floor

Floor area 44.4 m² (478 sq.ft.)

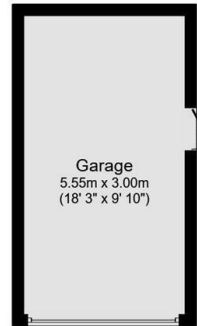

Floor Plan 3

Floor area 16.7 m²
(179 sq.ft.)

TOTAL: 105.4 m² (1,135 sq.ft.)

This floor plan is for illustrative purposes only. It is not drawn to scale. Any measurements, floor areas (including any total floor area), openings and orientations are approximate. No details are guaranteed, they cannot be relied upon for any purpose and do not form any part of any agreement. No liability is taken for any error, omission or misstatement. A party must rely upon its own inspection(s). Powered by www.Propertybox.io

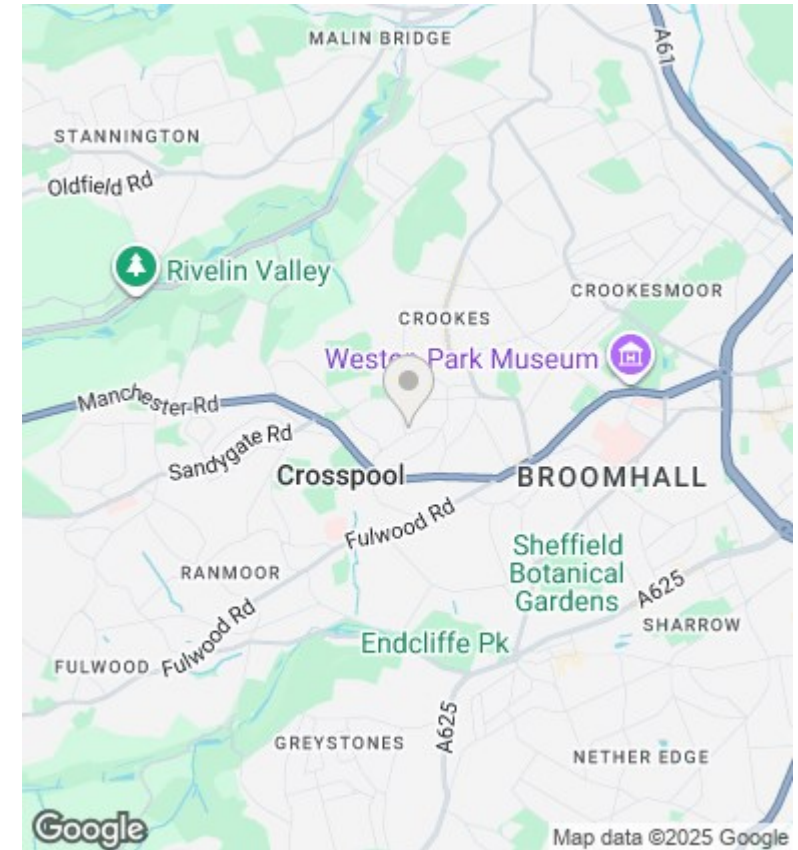

Directions

Viewings

Viewings by arrangement only. Call 01142 687777 to make an appointment.

Council Tax Band

B

EPC Rating:

C

Energy Efficiency Rating		
	Current	Potential
Very energy efficient - lower running costs		
(92-plus) A		
(81-91) B		83
(69-80) C	69	
(55-68) D		
(39-54) E		
(21-38) F		
(1-20) G		
Not energy efficient - higher running costs		
England & Wales	EU Directive 2002/91/EC	