

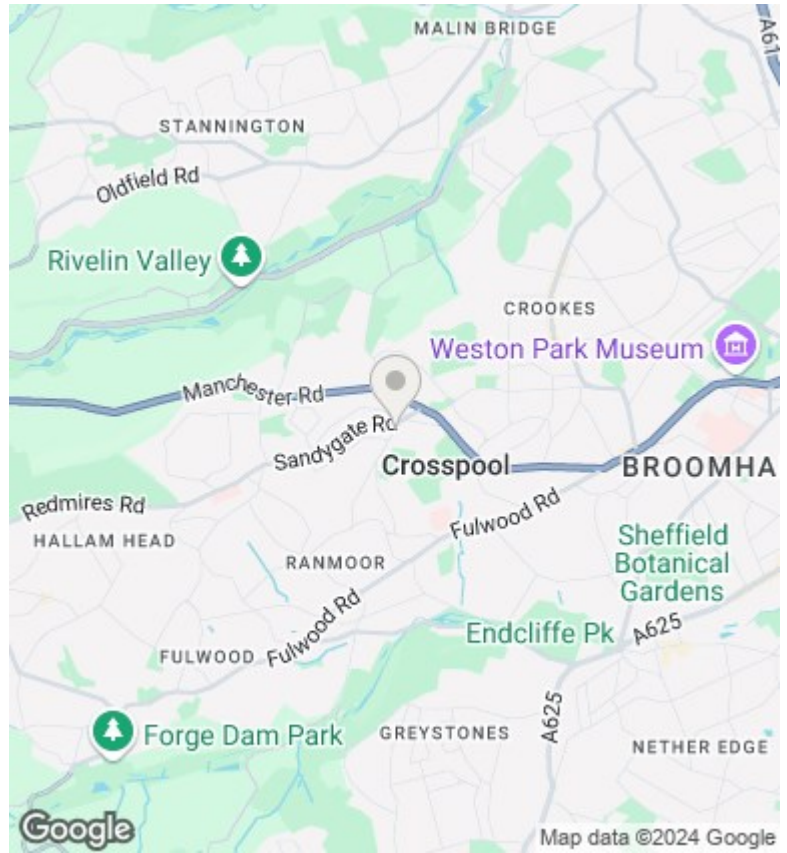

10 Watt Lane, Crosspool, Sheffield, S10 5NL

£1,300 Per Month

- Semi-detached house
- Ground floor WC
- Unfurnished
- Three double bedrooms
- Garage
- Available 14 October 2024
- Beautifully presented
- Front garden
- Council tax Band D

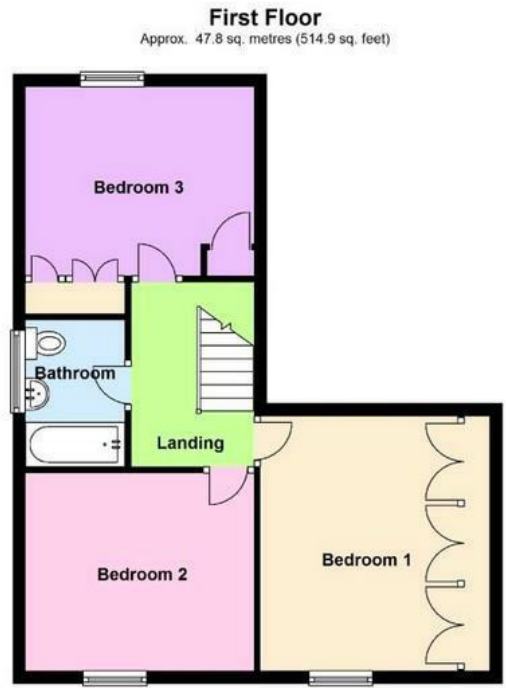

Directions

Viewings

Viewings by arrangement only. Call 01142 687777 to make an appointment.

Council Tax Band

B

EPC Rating:

D

Energy Efficiency Rating		Current	Potential
<i>Very energy efficient - lower running costs</i>			
(92 plus)	A		
(81-91)	B		86
(69-80)	C		
(55-68)	D	61	
(39-54)	E		
(21-38)	F		
(1-20)	G		
<i>Not energy efficient - higher running costs</i>			
England & Wales		EU Directive 2002/91/EC	