

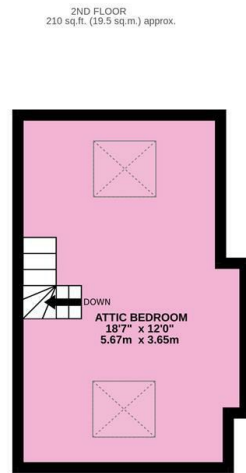

## 131 Lydgate Lane, Crookes, Sheffield, S10 5FN

Asking Price £250,000

- Victorian stone terrace
- Large attic bedroom
- Rewired in 2015
- Perfect home for a first-time buyer
- Three bedrooms
- South-facing rear garden
- All new windows, front and back door in 2015
- Beautiful Shaker-style kitchen
- Short walk to Crookes, Crosspool and Broomhill
- 5 min drive to nearby countryside

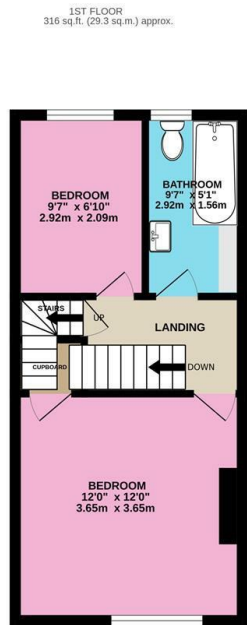
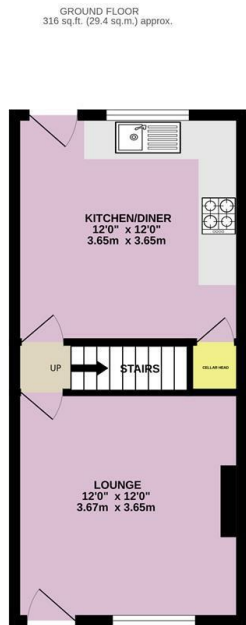

TOTAL FLOOR AREA: 842 sq.ft. (78.2 sq.m.) approx.  
Whilst every attempt has been made to ensure the accuracy of the floorplan contained here, measurements of doors, windows, rooms and any other items are approximate and no responsibility is taken for any error, omission or mis-statement. This plan is for illustrative purposes only and should be used as such by any prospective purchaser. The services, systems and appliances shown have not been tested and no guarantee as to their operability or efficiency can be given.  
Made with Metropix ©2024

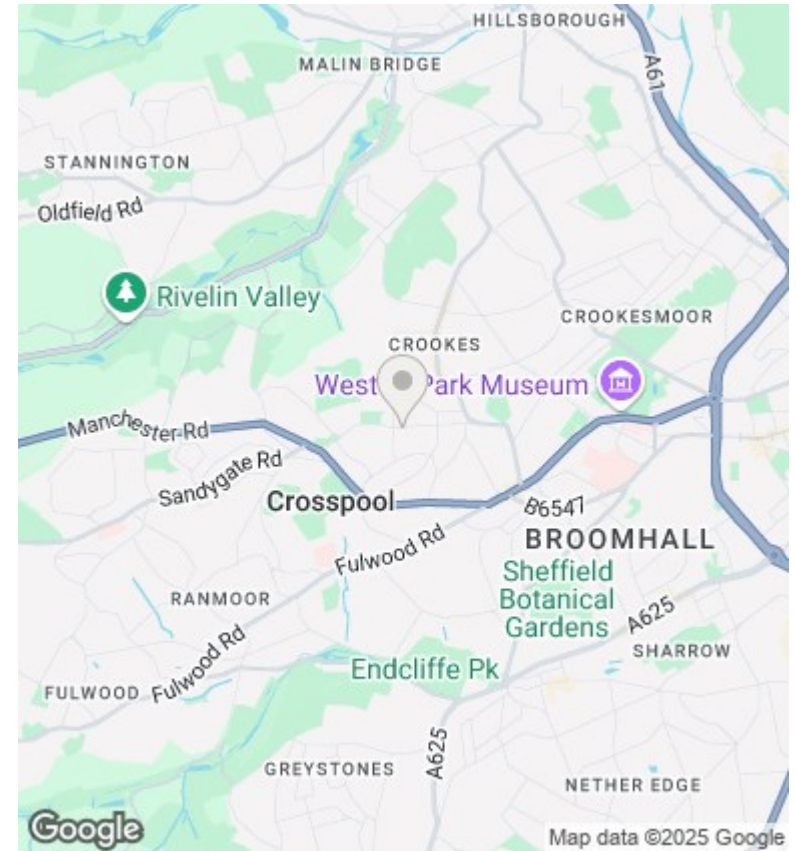

## Directions

## Viewings

Viewings by arrangement only. Call 01142 687777 to make an appointment.

## Council Tax Band

## EPC Rating:

| Energy Efficiency Rating                           |                            |           |
|--|----------------------------|-----------|
|  | Current                    | Potential |
| <i>Very energy efficient - lower running costs</i> |                            |           |
| (92 plus) <b>A</b>                                 |                            |           |
| (81-91) <b>B</b>                                   |                            |           |
| (69-80) <b>C</b>                                   |                            |           |
| (55-68) <b>D</b>                                   |                            |           |
| (39-54) <b>E</b>                                   |                            |           |
| (21-38) <b>F</b>                                   |                            |           |
| (1-20) <b>G</b>                                    |                            |           |
| <i>Not energy efficient - higher running costs</i> |                            |           |
| <b>England &amp; Wales</b>                         | EU Directive<br>2002/91/EC |           |