



66 Hallam Grange Road, Fulwood, Sheffield, S10 4BL

Asking Price £500,000

- Detached
- Large rear garden
- Short walk to Hallam Primary School
- Freehold
- No onward chain
- Incredible potential
- Two double bedrooms and one single bedroom
- Off street parking and integrated garage
- Highly desirable location
- Close to beautiful countryside



Ground Floor

Floor area 89.1 m² (959 sq.ft.) approx

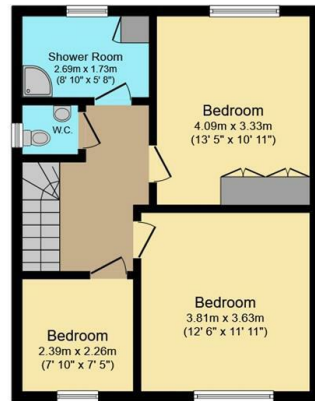

First Floor

Floor area 48.4 m² (521 sq.ft.) approx

Total floor area 137.5 m² (1,480 sq.ft.) approx

This plan is for illustration purposes only and may not be representative of the property. Plan not to scale. Powered by PropertyBox

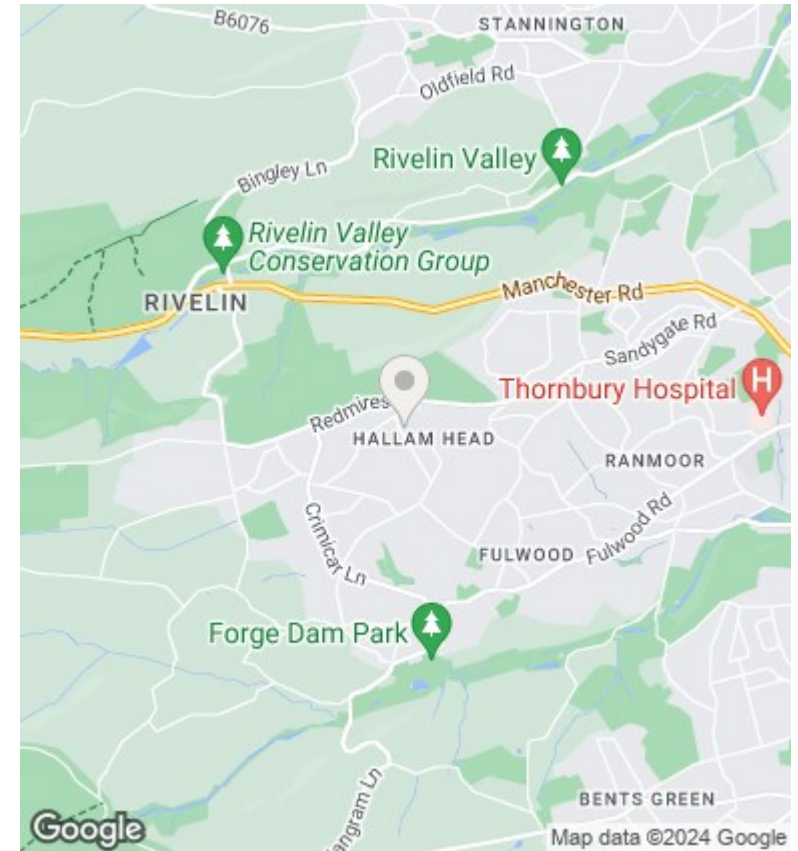

Directions

Viewings

Viewings by arrangement only. Call 01142 687777 to make an appointment.

Council Tax Band

C

EPC Rating:

E

Energy Efficiency Rating		Current	Potential
Very energy efficient - lower running costs			
(92 plus) A			
(81-91) B			76
(69-80) C			
(55-68) D		51	
(39-54) E			
(21-38) F			
(1-20) G			
Not energy efficient - higher running costs			
England & Wales		EU Directive 2002/91/EC	