

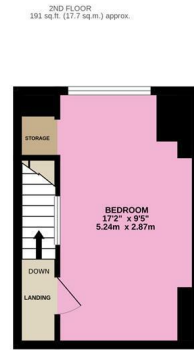

9 Lonsdale Road, Walkley, Sheffield, S6 2PS

Asking Price £190,000

- No onward chain
- South-West facing private rear garden
- Good public transport links
- Council tax band A
- Two double bedrooms and one single bedroom
- Perfect for a first time buyer
- Walking distance to the city centre
- Modern kitchen/diner
- Short walk to Walkley and Hillsborough
- Popular suburb

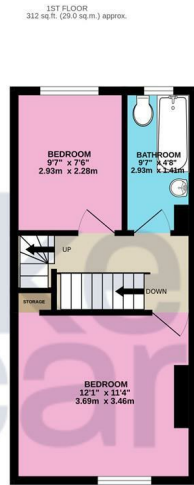
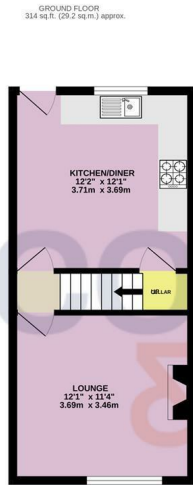
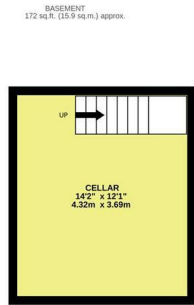

TOTAL FLOOR AREA: 989 sq.ft. (91.9 sq.m.) approx.

Whilst every attempt has been made to ensure the accuracy of the floorplan contained here, measurements of doors, windows, rooms and any other items are approximate and no responsibility is taken for any error, omission or mis-statement. This plan is for illustrative purposes only and should be used as such by any prospective purchaser. The services, systems and appliances shown have not been tested and no guarantee as to their operability or efficiency can be given.

Made with Metropix ©2023

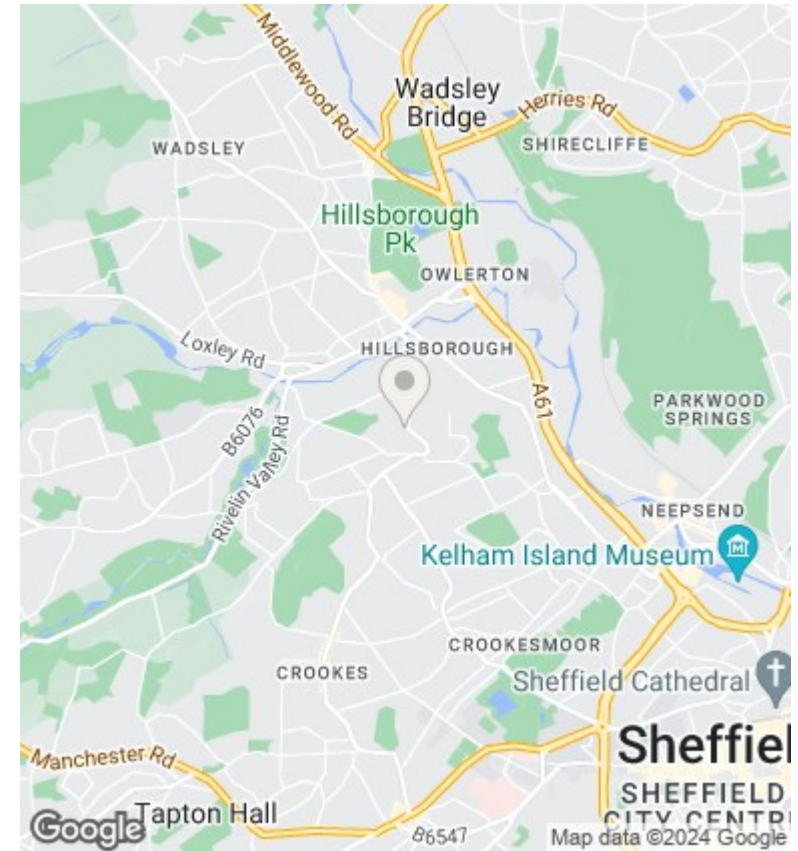

Directions

Viewings

Viewings by arrangement only. Call 01142 687777 to make an appointment.

Council Tax Band

C

EPC Rating:

D

Energy Efficiency Rating		
	Current	Potential
<i>Very energy efficient - lower running costs</i>		
(92 plus) A		
(81-91) B		77
(69-80) C		
(55-68) D	60	
(39-54) E		
(21-38) F		
(1-20) G		
<i>Not energy efficient - higher running costs</i>		
England & Wales	EU Directive 2002/91/EC	