



6 High Hazels Close, Handsworth, Sheffield, S9 4NT
£69,950

REDBRIK 
ESTATE AGENTS

Situated within walking distance of High Hazels Park is this deceptively spacious two bedroom apartment. Occupying a top floor position overlooking communal gardens, the property offers 621 sq. ft. of accommodation including a generous lounge/dining, double bedrooms, fitted kitchen and additional storage. Likely to be of interest to first time buyers or those looking to downsize, the property offers the opportunity for the purchaser to modernise according to their taste/requirements (subject to necessary consents). Well placed for local shops/amenities and transport links to/from surrounding areas. Available with no onward chain.

- Two Bedroom Apartment
- No Onward Chain
- Second (Top) Floor Position
- Generous Lounge/Dining Room
- Two Double Bedrooms
- Bathroom With Three Piece Suite
- Fitted Kitchen With Storage
- Storage Throughout
- Communal Grounds, Allocated Parking
- Energy Rating - TBC, uPVC DG, Electric Heating





Second Floor Apartment

Approx. 57.7 sq. metres (621.1 sq. feet)

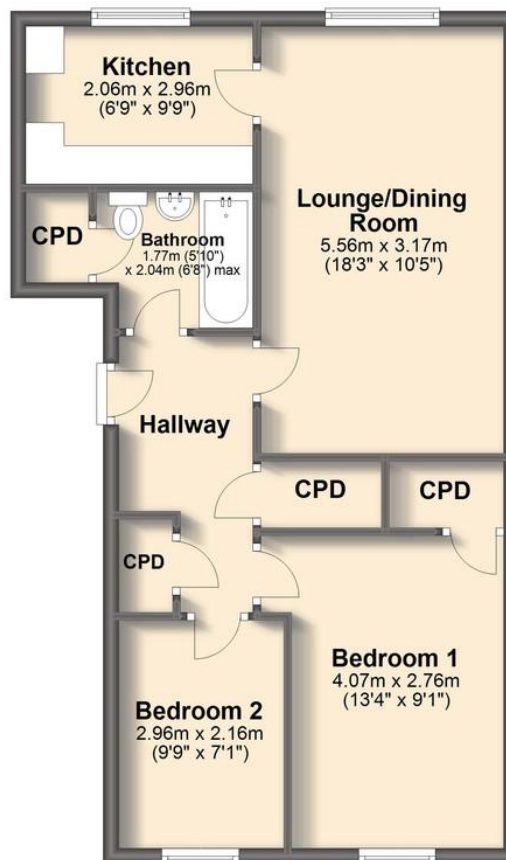

Total area: approx. 57.7 sq. metres (621.1 sq. feet)



We endeavor to make these particulars as accurate as possible, but they should only be used as guidance and they do not constitute any part of the contract. All measurements are approximate and no guarantees are made to the services, heating systems, appliances (if any) or fittings as to their working order and no warranty can be given or implied.

SALES:

CHESTERFIELD T: 01246 563 060
MILLHOUSES T: 0114 399 0567
CRYSTAL PEAKS T: 0114 361 1000

LETTINGS:

SHEFFIELD T: 0114 361 0140
CHESTERFIELD T: 01246 380 414
KELHAM ISLAND T: 0114 361 0140



REDBRIK 
ESTATE AGENTS

E: sales@redbrik.co.uk www.redbrik.co.uk

