



Pinkmove

## Porth Y Gwyddel

guide price £200,000 to £210,000

- Enclosed, Low-Maintenance Garden
- Allocated Parking and Visitor Parking Available
- Modern Kitchen and Bathroom
- Downstairs WC
- Access to Local Schools, Shops, and Amenities
- Excellent Transport Links
- Short Walk to Aberavon Beach for Coastal Views and Leisure Activities
- EPC Rating: B



2 1 2

Pinkmove

01633 746088  
team@pinkmove.co.uk





## About the property

A well-presented two-bedroom semi-detached home in Porth Y Gwyddel, Port Talbot, just moments from Aberavon Beach. Offering spacious living, a modern kitchen, and excellent access to schools, shops, and transport links, including Port Talbot Parkway Station and the M4.

Located in the sought-after coastal area of Porth Y Gwyddel, this attractive two-bedroom semi-detached home presents a superb opportunity for buyers seeking a comfortable and easily manageable property. The accommodation is thoughtfully arranged to maximise space and functionality, making it ideal for professional couples, small families or those looking to downsize.

## Accommodation

### Living Room

15' x 9' 5" ( 4.57m x 2.87m )

### Kitchen/Diner

8' 2" x 12' 7" ( 2.49m x 3.84m )

### Downstairs WC

4' 9" x 2' 10" ( 1.45m x 0.86m )

### Bedroom 1

8' 4" x 12' 9" ( 2.54m x 3.89m )



## Bedroom 2

8' 3" x 12' 9" ( 2.51m x 3.89m )

## Bathroom

6' 5" x 5' 7" ( 1.96m x 1.70m )



## Floorplan

### Ground Floor

Approx. 29.1 sq. metres (313.7 sq. feet)

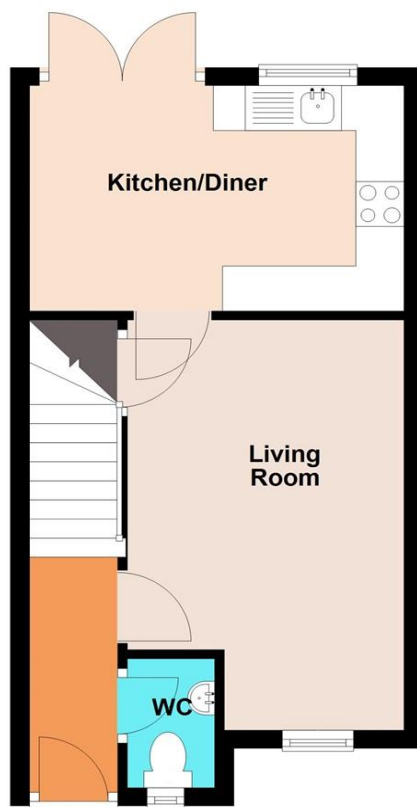

### First Floor

Approx. 27.9 sq. metres (300.5 sq. feet)

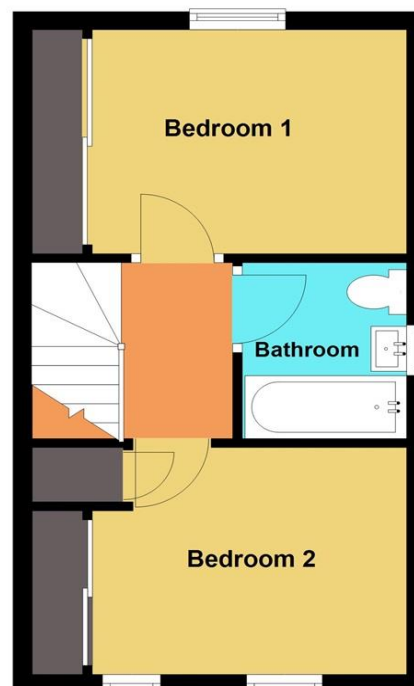

Total area: approx. 57.1 sq. metres (614.2 sq. feet)

**48 Porth y Gwyddel**

## Important Information

Note while we endeavour to make our sales details accurate and reliable, if there is any point which is of particular interest to you, please contact the office and we will be pleased to confirm the position for you. We have not personally tested any apparatus, equipment, fixtures, fittings or services and cannot verify they are in working order or fit for their purposes. Nothing in these particulars is intended to indicate that carpets or curtains, furnishings or fittings, electrical goods (whether wired or not). Gas fires or light fittings or any other fixtures not expressly included form part of the property offered for sale. This computer generated Floorplan, if applicable, is intended as a general guide to the layout and design of the property. It is not to scale and should not be relied upon for dimensions. Tenure: We cannot confirm the tenure of the property as we have not had access to the legal documents. The buyer is advised to obtain verification from their solicitor or surveyor.

Peter Alan Limited is registered in England and Wales under company number 2073153, Registered Office is Cumbria House, 16-20 Hockliffe Street, Leighton Buzzard, Bedfordshire, LU7 1GN. VAT Registration Number is 500 2481 05. For activities relating to regulated mortgages and non-investment insurance contracts, Peter Alan Limited is an appointed representative of Connells Limited which is authorised and regulated by the Financial Conduct Authority. Connells Limited's Financial Services Register number is 302221. Most buy-to-let

