



Violet Walk

Guide Price £220,000 to £225,000

- NO CHAIN
- DRIVEWAY AND SINGLE GARAGE
- Downstairs WC and Upstairs Family Bathroom
- Open-Plan Living
- Two-Tier Enclosed Rear GARDEN
- Close to Schools, Shops and Local Amenities
- Excellent Transport Links via Rogerstone



3 1 1

Pinkmove

01633 746088
team@pinkmove.co.uk



Pinkmove

About the property

Offered with NO CHAIN is this beautifully presented three-bedroom semi-detached home located in the highly sought-after Violet Walk, Rogerstone. Situated within the popular Afon Village development, this property offers spacious and modern living across two floors, making it an ideal choice for families and professionals alike.

Upon entering you are greeted by a welcoming entrance hallway, complete with a convenient downstairs WC. There is a bright and airy open-plan living room, which flows seamlessly into the modern, well-equipped kitchen/dining area via an archway. French doors open onto the patio area off the dining area and a two-tier rear garden offers a convenient outdoor space and is perfect for entertaining or relaxing.

To the first floor there are two generous double bedrooms and a well-sized single bedroom, along with a stylish family bathroom. Each room is thoughtfully laid out to provide comfort and flexibility.

Externally, the home benefits from a private driveway and a single garage, offering secure off-road parking and additional storage.

Violet Walk enjoys a quiet cul-de-sac setting with excellent access to local amenities. Families will appreciate the proximity to highly regarded schools, including Bassaleg Comprehensive and several well-rated primary schools. Rogerstone Railway Station is within walking distance, providing direct links to Cardiff, and the M4 is easily accessible via junctions 27 and 28.



Pinkmove



Pinkmove



Accommodation

Living Room

13' 11" x 14' 7" (4.24m x 4.45m)
max measurements

Dining Room

9' 1" x 7' 5" (2.77m x 2.26m)

Kitchen

9' 1" x 6' 5" (2.77m x 1.96m)

Downstairs Wc

5' 4" x 2' 9" (1.63m x 0.84m)

Bedroom 1

11' 5" x 8' 8" (3.48m x 2.64m)

Bedroom 2

9' x 8' (2.74m x 2.44m)

Bedroom 3

8' 1" x 6' 5" (2.46m x 1.96m)

Bathroom

5' 7" x 6' 3" (1.70m x 1.91m)

01633 746088

team@pinkmove.co.uk

Pinkmove

Floorplan

Ground Floor

Approx. 33.8 sq. metres (364.0 sq. feet)



First Floor

Approx. 31.9 sq. metres (343.0 sq. feet)

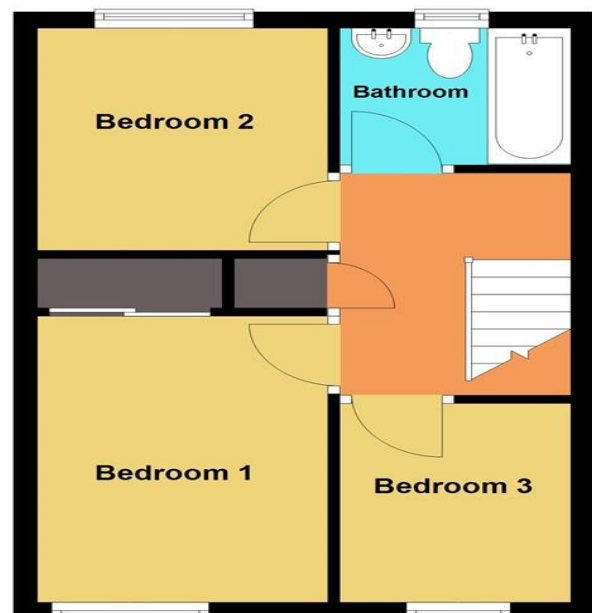

Total area: approx. 65.7 sq. metres (707.0 sq. feet)

32 Violet Walk

Important Information

Note while we endeavour to make our sales details accurate and reliable, if there is any point which is of particular interest to you, please contact the office and we will be pleased to confirm the position for you. We have not personally tested any apparatus, equipment, fixtures, fittings or services and cannot verify they are in working order or fit for their purposes. Nothing in these particulars is intended to indicate that carpets or curtains, furnishings or fittings, electrical goods (whether wired or not). Gas fires or light fittings or any other fixtures not expressly included form part of the property offered for sale. This computer generated Floorplan, if applicable, is intended as a general guide to the layout and design of the property. It is not to scale and should not be relied upon for dimensions. Tenure: We cannot confirm the tenure of the property as we have not had access to the legal documents. The buyer is advised to obtain verification from their solicitor or surveyor.

Peter Alan Limited is registered in England and Wales under company number 2073153, Registered Office is Cumbria House, 16-20 Hockliffe Street, Leighton Buzzard, Bedfordshire, LU7 1GN. VAT Registration Number is 500 2481 05. For activities relating to regulated mortgages and non-investment insurance contracts, Peter Alan Limited is an appointed representative of Connells Limited which is authorised and regulated by the Financial Conduct Authority. Connells Limited's Financial Services Register number is 302221. Most buy-to-let

