

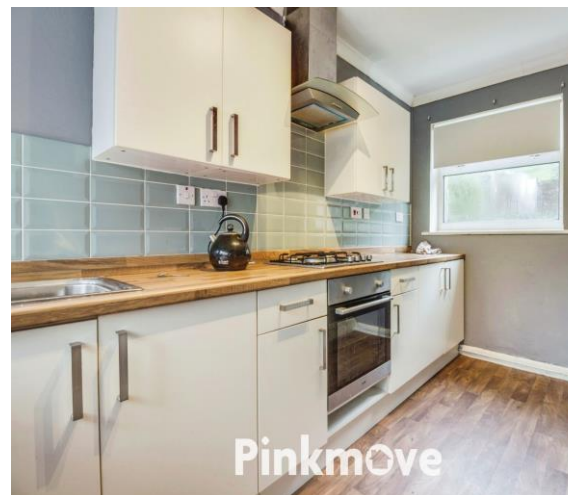

Pinkmove

Hillsboro Old Furnace, offers in the region of £140,000.

- NO CHAIN
- TWO DOUBLE BEDROOMS
- LOTS OF POTENTIAL
- LARGE ENCLOSED REAR GARDEN
- EPC Rating: D



Pinkmove

2 1 2

Pinkmove

01633 746088
team@pinkmove.co.uk



Pinkmove

About the property

This semi-detached home offers great potential, featuring two reception rooms, two double bedrooms, a practical kitchen, and a large garden. Ideally located near schools and amenities, it's a perfect renovation project to shape into your dream home.



Pinkmove



Pinkmove



Accommodation

Living Room

11' 9" x 14' 8" (3.58m x 4.47m)Max Measurements

Kitchen

13' 2" x 6' 7" (4.01m x 2.01m)

Bathroom

11' 10" x 8' 8" (3.61m x 2.64m)
Max Measurements

Bedroom 1

14' 8" x 11' 6" (4.47m x 3.51m)
Max Measurements

Bedroom 2

12' x 11' 5" (3.66m x 3.48m)
Max Measurements

Dining Room

14' 8" x 11' 10" (4.47m x 3.61m)
Dining Room

01633 746088

team@pinkmove.co.uk

Pinkmove

Floorplan

Basement

Approx. 16.1 sq. metres (173.7 sq. feet)

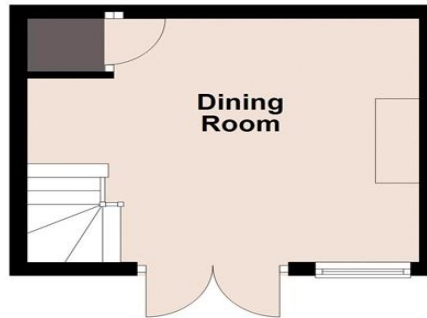

Ground Floor

Approx. 41.2 sq. metres (443.3 sq. feet)



First Floor

Approx. 32.0 sq. metres (344.7 sq. feet)

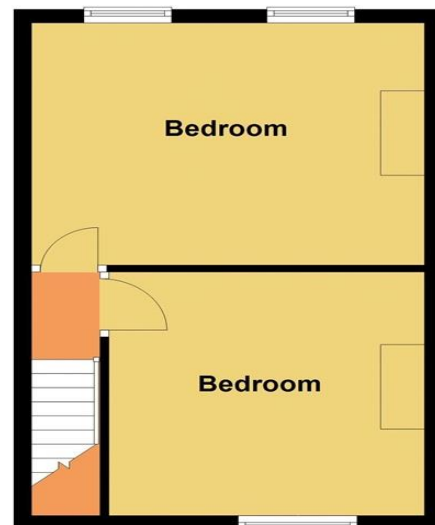

Total area: approx. 89.3 sq. metres (961.6 sq. feet)

Important Information

Note while we endeavour to make our sales details accurate and reliable, if there is any point which is of particular interest to you, please contact the office and we will be pleased to confirm the position for you. We have not personally tested any apparatus, equipment, fixtures, fittings or services and cannot verify they are in working order or fit for their purposes. Nothing in these particulars is intended to indicate that carpets or curtains, furnishings or fittings, electrical goods (whether wired or not). Gas fires or light fittings or any other fixtures not expressly included form part of the property offered for sale. This computer generated Floorplan, if applicable, is intended as a general guide to the layout and design of the property. It is not to scale and should not be relied upon for dimensions. Tenure: We cannot confirm the tenure of the property as we have not had access to the legal documents. The buyer is advised to obtain verification from their solicitor or surveyor.

Peter Alan Limited is registered in England and Wales under company number 2073153, Registered Office is Cumbria House, 16-20 Hockliffe Street, Leighton Buzzard, Bedfordshire, LU7 1GN. VAT Registration Number is 500 2481 05. For activities relating to regulated mortgages and non-investment insurance contracts, Peter Alan Limited is an appointed representative of Connells Limited which is authorised and regulated by the Financial Conduct Authority. Connells Limited's Financial Services Register number is 302221. Most buy-to-let

