



## 7 Westfield Croft, Eggborough, DN14 0TU

Charming End Terrace House | Three Bedrooms | Parking | WC | Enclosed Rear Garden | Popular Village Location | Close To All Major Networks.

- End Terrace Property
- Gas Central Heating
- Council Tax Band - A
- Close To All Major Networks
- Three Bedrooms
- Freehold Property
- Popular Village Location
- Parking
- EPC Rating - D
- Modern Family Home

**Asking Price £150,000**

Jigsaw Move are pleased to welcome to the market this charming three bedroom end-terrace property situated within the popular village location of Eggborough.

This delightful property boasts a spacious 1,023 sq ft of living space, perfect for a family looking for a new home. The house features 1 reception room, ideal for entertaining guests or relaxing with your loved ones. With 3 cosy bedrooms, there's plenty of space for everyone to enjoy their own private sanctuary.

The property briefly comprises; Entrance Hallway, Lounge, Kitchen, Dining Room, WC, Stairs & Landing, Three Bedrooms and Family Bathroom.

The property also benefits from; enclosed rear garden, gas central heating, uPVC double glazing and off street parking.

The property is situated within the desirable village of Eggborough. This sought after village hosts a range of local amenities including; post office, corner shop, fish and chip shop, pub, pharmacy & primary school. Eggborough is a great location for commuters due to its access links to all major networks including M62 making it perfect for those travelling to York, Leeds and Hull.

This well presented property would make the ideal first home or family home and don't miss out on the opportunity to make this lovely house your new family home. Contact us today to arrange a viewing and start envisioning the wonderful memories you could create in this beautiful property.

EPC Rating - D

Council Tax Band - A

## GROUND FLOOR ACCOMMODATION

### Entrance Hall

Lounge 11'5" x 12'7" (3.48m x 3.84m)

Dining Area 9'4" x 9'11" (2.85m x 3.02m)

Kitchen 11'7" x 9'10" (3.53m x 2.99m)

WC 4'6" x 3'0" (1.37m x 0.92m)

## FIRST FLOOR ACCOMMODATION

### Landing

Bedroom One 11'11" x 13'1" (3.64m x 3.99m)

Bedroom Two 9'0" x 13'1" (2.75m x 3.99m)

Bedroom Three 7'3" x 9'11" (2.21m x 3.02m)

Bathroom 5'5" x 7'2" (1.64m x 2.18m)

## EXTERNAL

### COUNCIL TAX

Please note that the council tax band for the property has either been advised by the owner or we have sought from online resources. Whilst we endeavour to ensure our details are accurate and reliable, we strongly advise to make further enquiries before continuing.

### HEATING AND APPLIANCES

The heating system and any appliances (including Burglar Alarms where fitted) mentioned in this brochure have not been tested by Jigsaw. The mention of any appliances and/or services within these particulars does not imply that they are in full and efficient working order.





## MAKING AN OFFER

In order to comply with the Estate Agents (Undesirable Practises) Order 1991, Jigsaw Move is required to verify the status of any prospective purchaser. This includes a financial standing of that purchaser and their ability to exchange contracts. To allow us to comply with this order and before recommending acceptance of any offers, and subsequently making the property 'SOLD stc' each prospective purchaser will be required to demonstrate to 'Jigsaw Move' that they are financially able to proceed with the purchase of the property.

## MEASUREMENTS

These approximate room sizes are only intended as general guidance. You must verify the dimensions carefully before ordering carpets or any built in furniture.

All measurements have been taken using a laser distance metre or sonic tape measure and therefore may be subject to a small margin of error.

## OPENING HOURS

Monday – Friday 9.00am to 5.00pm Saturday – 9.00am – 1.00pm

## PROPERTY DETAILS

Whilst we endeavour to make our property details are accurate and reliable, if there is any point which is of particular importance to you, please contact us and we will be pleased to check the information. Do so particularly if contemplating travelling some distance. These particulars are issued in good faith but do not constitute representations of fact or form part of any offer or contract. The matters referred to in these particulars should be independently verified by prospective buyers. Neither Jigsaw nor any of its employees or agents has any authority to make or give any representation or warranty whatsoever in relation to this property. In the area of Yorkshire and The Humber flood plains have been identified and coal mining has been carried out in the past in specific areas, therefore, we strongly advise that any prospective purchaser instructs an appropriate qualified person for the purposes of conveyancing to carry out searches on the property which include a local search with the Local Authority, a water and drainage search, an environmental search and a Chancel Repair Liability search. We also advise in certain cases other searches may be required such as a Coal Mining Search, Commons Registration Search which relates to Common Land, a Flood Search or a Planning Search. We would recommend that all the information that Jigsaw provide regarding this advertised property is verified by you or your legal representative. We do not inspect deeds and therefore any references or covenants etc need to be confirmed.

## UTILITIES MATERIAL INFORMATION

Electricity supply – mains.

Water supply – mains.

Sewerage – mains.

Heating – Electric central or room heating.

Broadband – Cable, FTTC (fibre to the cabinet).

Mobile signal/coverage is good in this area

## VIEWINGS

Strictly by appointment with the sole agents by contacting 01757 241123. If there is any point of particular importance to, that we will be pleased to provide additional information or to make any further enquiries. We will also confirm that the property remains available. This is particularly important if you are travelling some distance to view the property. A full copy of the EPC for the property is available upon request.

## WINDOWS

Compliance with FENSA Building Regulations has not been sought by Jigsaw Move.



## Ground Floor

Approx. 39.3 sq. metres (422.6 sq. feet)

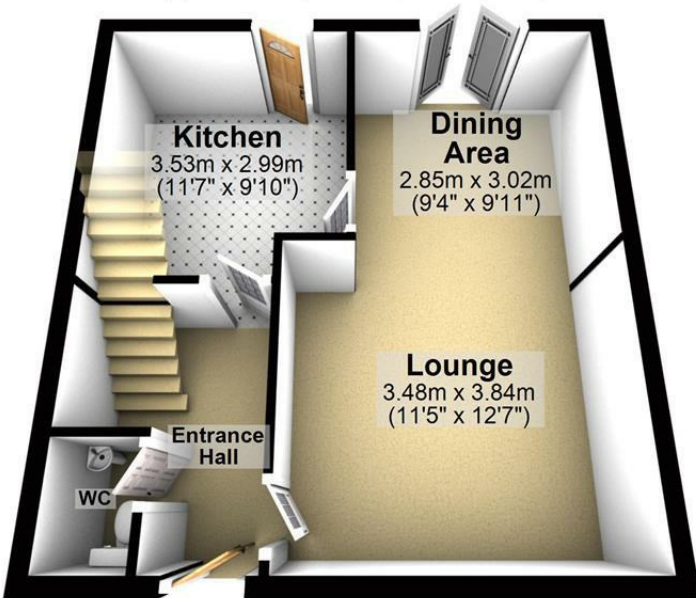

## First Floor

Approx. 40.9 sq. metres (440.0 sq. feet)

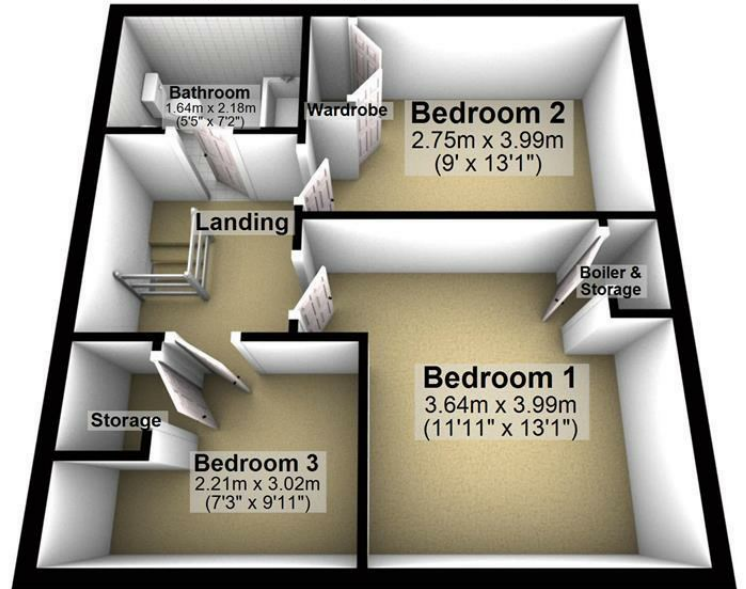

Total area: approx. 80.1 sq. metres (862.5 sq. feet)

Energy Efficiency Rating		Current	Potential
Very energy efficient - lower running costs			
(92 plus) A			85
(81-91) B		67	
(69-80) C			
(55-68) D			
(39-54) E			
(21-38) F			
(1-20) G			
Not energy efficient - higher running costs			
England & Wales		EU Directive 2002/91/EC	

Environmental Impact (CO <sub>2</sub> ) Rating		Current	Potential
Very environmentally friendly - lower CO <sub>2</sub> emissions			
(92 plus) A			85
(81-91) B		67	
(69-80) C			
(55-68) D			
(39-54) E			
(21-38) F			
(1-20) G			
Not environmentally friendly - higher CO <sub>2</sub> emissions			
England & Wales		EU Directive 2002/91/EC	



11 Finkle Street, Selby, North Yorkshire, YO8 4DT

info@jigsawmove.co.uk | www.jigsawmove.co.uk | info@jigsawletting.co.uk | www.jigsawletting.co.uk  
Jigsaw Move : 08975826 VAT: 215610542 | Jigsaw Letting : 07385709 VAT: 847215227

