



Jasmine Road
Nottingham





Property Description

IDEAL FIRST TIME BUYER HOME! This character two bed semi-detached property is deceiving from the outside. With a spacious kitchen diner to the front and the living room overlooking the rear courtyard which is low maintenance.

To the first floor you will find two double sized bedrooms and family bathroom. Every room is so well presented, you will not be disappointed.

Call Burchell Edwards today on 01159680528

Entrance Porch

The property is accessed via UPVC double glazed door leading into the porch with tiled flooring, a radiator and UPVC door leading into the hallway.

Hallway

Having base units with plumbing and space for washing machine and tumble dryer, wall mounted boiler and a radiator.

Kitchen

10' 2" x 12' 1" (3.10m x 3.68m)
having wall and base units with work surfaces over, electric oven with gas hob, space and plumbing for a dishwasher, tiled flooring, space for fridge freezer, a radiator, sink unit with mixer tap and double glazed window to the front elevation.

Lounge

12' 7" x 12' (3.84m x 3.66m)
Having double glazed French doors to the rear elevation and a radiator.

First Floor Landing

Having double glazed window to the side elevation.

Bedroom One

.12' 1" x 12' 1" (3.68m x 3.68m)
Having double glazed window to the rear elevation and a radiator.

Bedroom Two

12' 2" x 9' 1" (3.71m x 2.77m)
Having double glazed window to the front elevation and a radiator.

Bathroom

Having a bath with shower over, vanity wash hand basin, low level W.C, extractor fan, double glazed obscured window to the front elevation and a radiator.

Outside

To the front of the property is a gated paved driveway providing off road parking with a brick built outbuilding and gated side access.

To the rear the garden is fully decked with outside tap and outside power sockets.







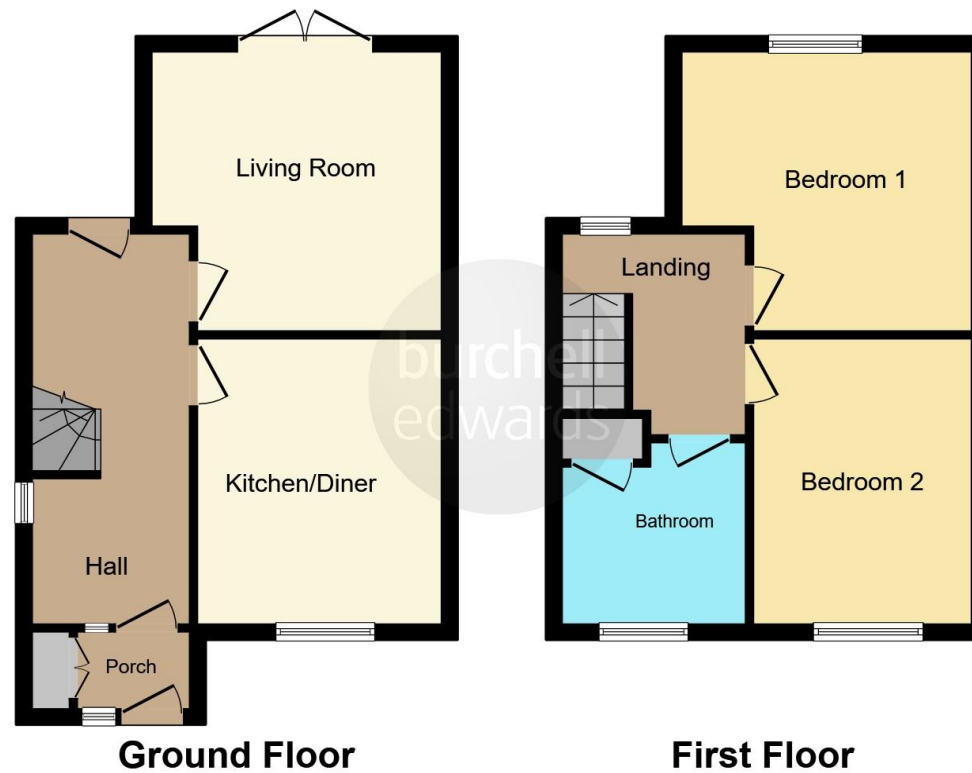

This floor plan is for illustrative purposes only. It is not drawn to scale. Any measurements, floor areas (including any total floor area), openings and orientation are approximate. No details are guaranteed, they cannot be relied upon for any purpose and they do not form part of any agreement. No liability is taken for any error, omission or misstatement. A party must rely upon its own inspection(s). Powered by www.focalagent.com

To view this property please contact Burchell Edwards on

T 0115 968 0528
E hucknall@burchelledwards.co.uk

64 High Street Hucknall
 NOTTINGHAM NG15 7AX

EPC Rating: D

Tenure: Freehold

check out more properties at burchelledwards.co.uk



1. MONEY LAUNDERING REGULATIONS Intending purchasers will be asked to produce identification documentation at a later stage and we would ask for your co-operation in order that there will be no delay in agreeing the sale. 2. These particulars do not constitute part or all of an offer or contract. 3. The measurements indicated are supplied for guidance only and as such must be considered incorrect. Potential buyers are advised to recheck measurements before committing to any expense. 4. We have not tested any apparatus, equipment, fixtures, fittings or services and it is in the buyers interest to check the working condition of any appliances.

Burchell Edwards is a trading name of Connells Residential which is registered in England and Wales under company number 1489613, Registered Office is Cumbria House, 16-20 Hockliffe Street, Leighton Buzzard, Bedfordshire, LU7 1GN. VAT Registration Number is 500 2481 05.

See all our properties at www.burchelledwards.co.uk | www.rightmove.co.uk | www.zoopla.co.uk

Property Ref: HUK102401 - 0001